

WATERLINE FITTING TABLE					
NO	DESCRIPTION	NORTHING	EASTING	NORTHING (AS-BUILT)	EASTING (AS-BUILT)
F2	12" X 6" TEE	719996.00	2277270.53		
F3	12" 45° BEND	719994.99	2277266.73		
F4	12" 45° BEND	720010.10	2277240.46		
F5	12" X 4" TEE	720146.56	2277204.12		
F6	12" 45° BEND	720158.38	2277200.97		
F7	12" 45° BEND	720171.85	2277208.78		
FDC - F1	4" 45° BEND	720160.68	2277243.69		
FDC - F2	4" 45° BEND	720114.11	2277216.50		
FDC - F3	4" 45° BEND	720027.26	2277239.32		

\*12"x12" TAPPING SLEEVES AND VALVES AS SHOWN ON PLAN

WATERLINE APPURTENANCE TABLE					
NO	DESCRIPTION	NORTHING	EASTING	NORTHING (AS-BUILT)	EASTING (AS-BUILT)
A1	12" Valve	719997.00	2277274.30		
A2	12" Valve	720176.53	2277226.37		
FL - A1	4" Valve	720147.50	2277207.65		
HYD - A1	6" Valve	719997.42	2277270.16		

\*SERVICE CONNECTION CURB STOP & METER VAULT AS SHOWN ON PLAN

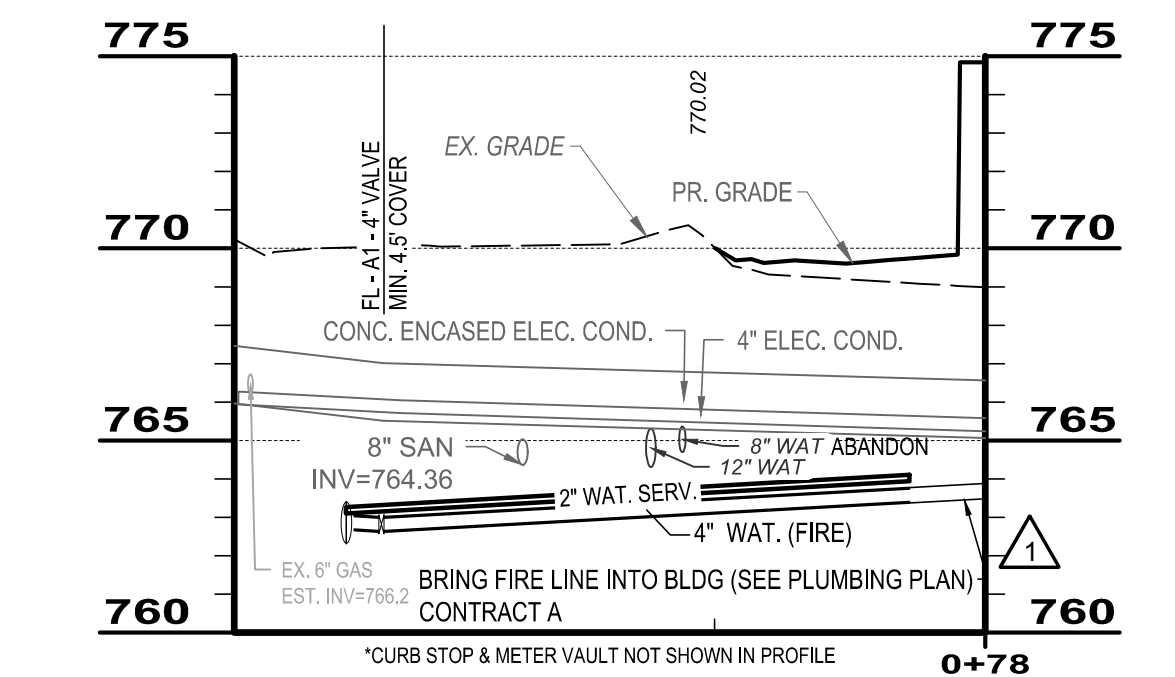

**4" FIRE & 1.5" SERVICE CONNECTION**

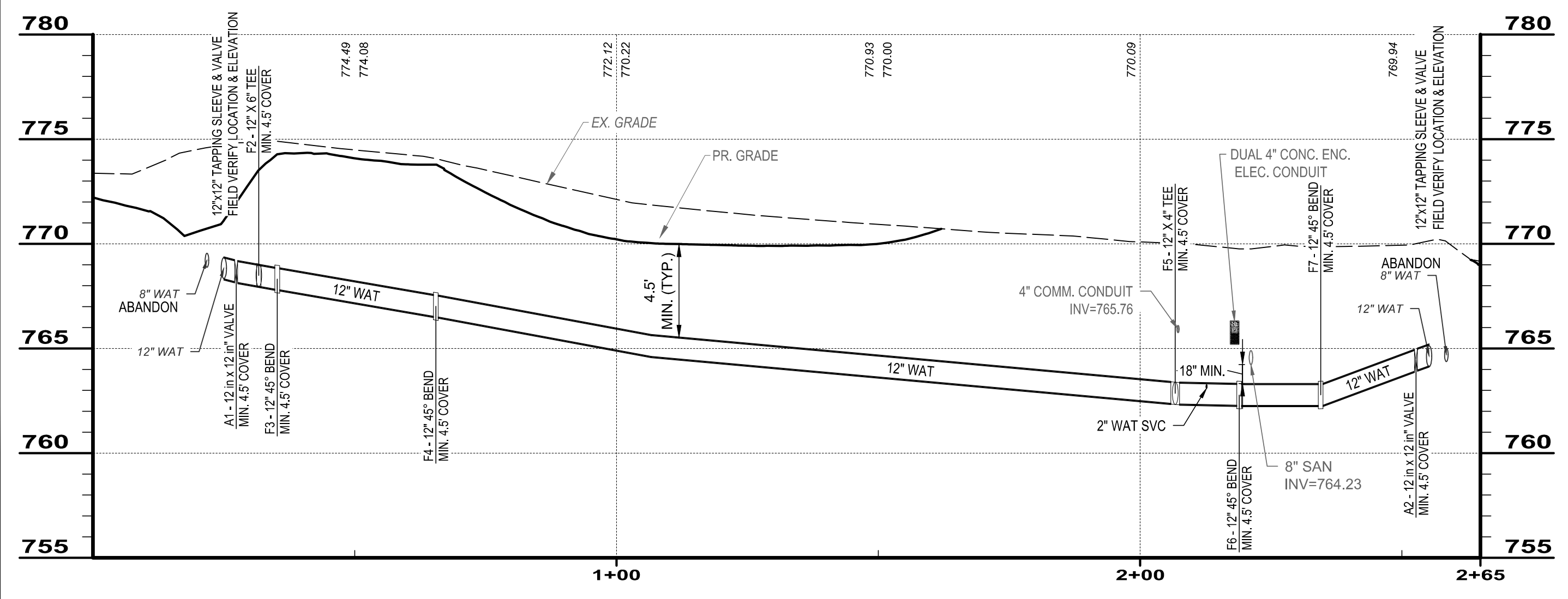

**12" WATERMAIN RELOCATION**

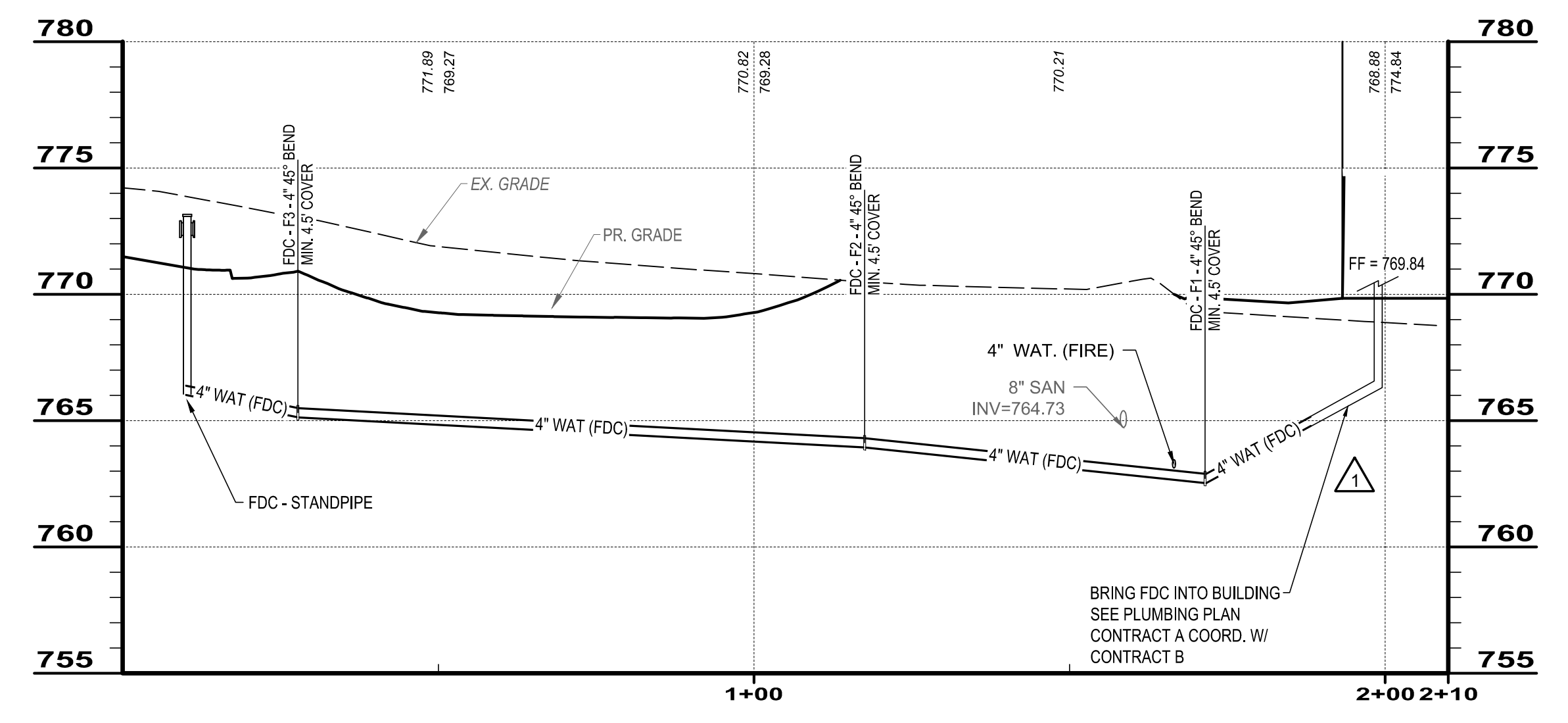

**4" FIRE DEPT. CONNECTION**

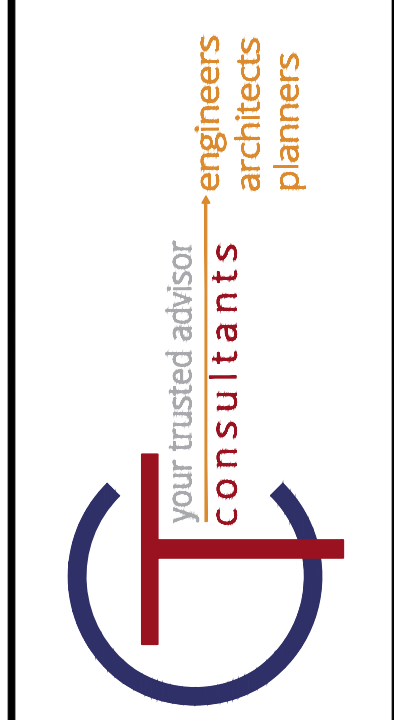
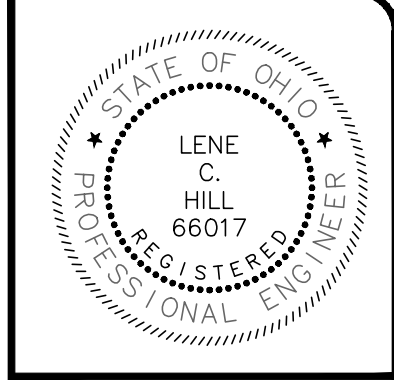

ISSUED FOR:	CD	NO	REVISION	DATE
8/5/2019	AS SHOWN	REBID REVISION		8/05/2019
SCALE:	LCH / GMS			
DESIGNED BY:	GMS			
DRAWN BY:	LCH			
CHECKED BY:				

**LAKELAND TRANSFER CENTER**  
**LAKELAND COMMUNITY COLLEGE**  
 7601 CLOCKTOWER DR., KIRTLAND, OH 44094

**WATERMAIN RELOCATION & SERVICE**

PROJECT NO.	18050002
DISCIPLINE	CIVIL
SHEET NAME	C_08
SHEET	14
OF	55