

MOTLOW STATE COMMUNITY COLLEGE

ADDITIONAL PARKING AND ROADWAY REPAIRS

RUTHERFORD, TENNESSEE

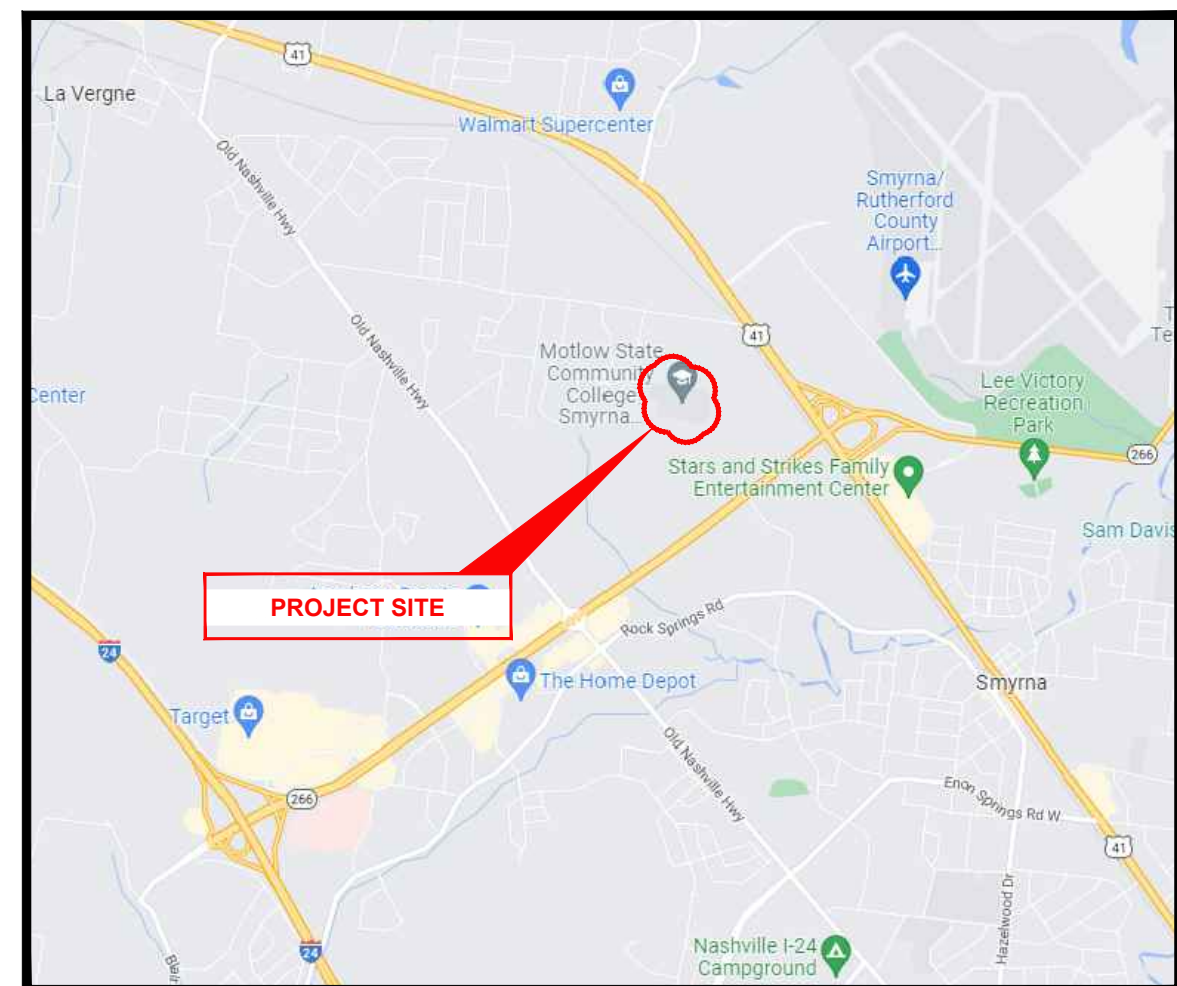

VICINITY MAP

5002 MOTLOW COLLEGE BLVD
SMYRNA, TN 37167

CT JOB #220439

SBC NO. 166/21-01-2022A



SITE MAP

INDEX OF SHEETS	
NO.	SHEET NAME
C1	TITLE SHEET
C2	NOTES & LEGEND
C3	DETAILS
C4	ALTERNATE 1

PROJECT CONTACTS	
SITE ENGINEER	JAMES G. GOLIAS II, P.E. 615-349-4025 JGOLIAS@CTCONSULTANTS.COM 2964 SIDCO DRIVE NASHVILLE, TN 37204
PROPERTY OWNER	TENNESSEE BOARD OF REGENTS 1 BRIDGESTONE PARK NASHVILLE, TN 37214 615-366-4400 TRISH WHITLOCK, PROJECT MANAGER TRISH.WHITLOCK@TBR.EDU
SCHOOL CONTACT	MOTLOW STATE COMMUNITY COLLEGE PO BOX 8500 LYNCHBURG, TN 37352 931-393-1576 BRIAN GAFFORD, P.E., DIRECTOR OF FACILITIES SERVICES BGAFFORD@MSCC.EDU

ZONING INFORMATION	
OWNER:	STATE OF TENNESSEE
PROPERTY ADDRESS:	5002 MOTLOW COLLEGE BLVD SMYRNA, TN 37167
PARCEL NUMBER:	018-013.01-000
TOTAL ACREAGE:	26.07 ACRES
ACREAGE DISTURBED:	0.01 ACRES

SOURCE OF BOUNDARY INFORMATION

THE BOUNDARY INFORMATION SHOWN ON THESE PLANS IS BASED UPON RUTHERFORD COUNTY G.I.S. MAPPING AND DOES NOT REPRESENT AN ACTUAL FIELD BOUNDARY SURVEY BY CT CONSULTANTS, INC.

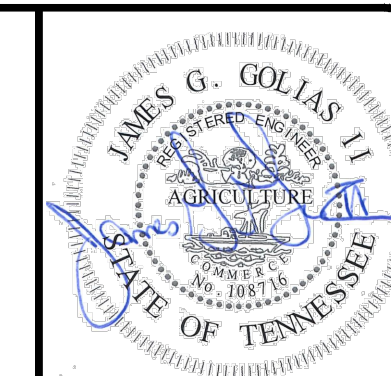

your trusted advisor
consultants
engineers
architects
planners

NO	DATE	REVISION

ISSUED FOR:	CONSTRUCTION	SCALE:	DESIGNED BY:	DRAWN BY:	CHECKED BY:
	01/18/2024		MHOR	MHOR	JGOL

MOTLOW STATE COMMUNITY COLLEGE
ADDITIONAL PARKING AND ROADWAY REPAIRS
SMYRNA, TENNESSEE 37167

SBC NO. 166/21-01-2022A

TITLE SHEET



Know what's below.
Call before you dig.

PROJECT NO.	
220439	
DISCIPLINE	
CIVIL	
SHEET NAME	
C1	
SHEET	OF
1	4

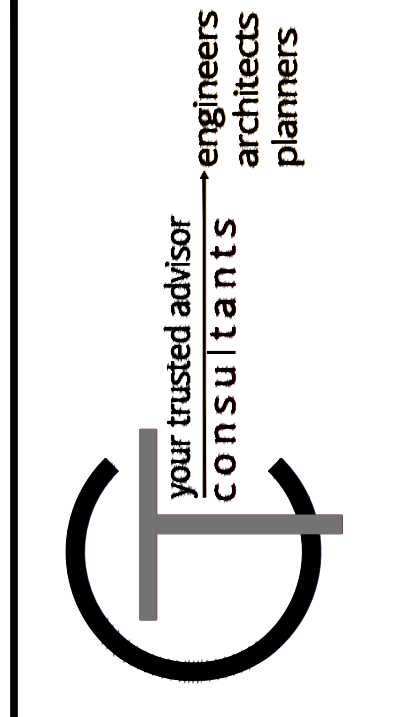
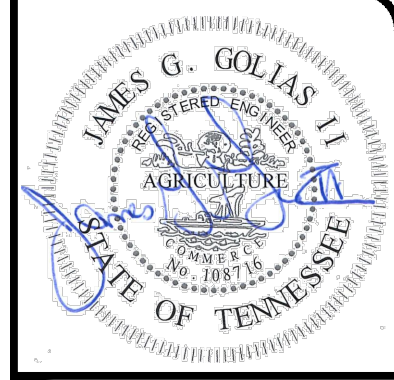

NO	REVISION	DATE

ISSUED FOR: CONSTRUCTION	01/19/2024	MHOR	MHOR	JGOL
ISSUE DATE:	01/19/2024	DESIGNED BY:	DRAWN BY:	CHECKED BY:
SCALE:				

**MOTLOW STATE COMMUNITY COLLEGE
ADDITIONAL PARKING AND ROADWAY REPAIRS
SMYRNA, TENNESSEE 37167**
SBC NO. 166021-01-2022A

NOTES & LEGEND

PROJECT NO.	220439
DISCIPLINE	CIVIL
SHEET NAME	C2
SHEET	2
OF	4

GENERAL NOTES

- ALL CONSTRUCTION SHALL CONFORM TO THESE PLANS AND SPECIFICATIONS, THE LATEST EDITION OF THE STATE OF TENNESSEE DEPARTMENT OF TRANSPORTATION (TDOT) CONSTRUCTION AND MATERIAL SPECIFICATIONS AND IN ACCORDANCE WITH METROPOLITAN NASHVILLE STORMWATER MANAGEMENT MANUAL.
- THERE SHALL BE NO DEVIATION FROM THE APPROVED PLANS WITHOUT PRIOR WRITTEN APPROVAL FROM THE OWNER OR THEIR REPRESENTATIVE. ANY DEVIATION FROM THESE PLANS WITHOUT PRIOR WRITTEN APPROVAL SHALL BE AT THE CONTRACTOR'S RISK AND EXPENSE.
- THE CONTRACTOR SHALL OBTAIN THE SERVICES OF A TESTING AGENCY FOR ALL REQUIRED TESTING.
- THE CONTRACTOR SHALL BE RESPONSIBLE FOR ALL CONSTRUCTION LAYOUT STAKING INCLUDING HORIZONTAL AND VERTICAL CONTROL. ANY DISCREPANCIES DISCOVERED IN THE PLAN INFORMATION, OR BETWEEN THE PLAN AND ELECTRONIC DATA SHALL BE BROUGHT TO THE IMMEDIATE ATTENTION OF THE DESIGN ENGINEER SO THE APPROPRIATE ADJUSTMENTS MAY BE MADE.
- ALL WORK SHALL BE LIMITED TO THE PROPERTIES AND EASEMENTS IDENTIFIED ON THE PLANS. ANY WORK WITHIN THE PUBLIC RIGHT OF WAY IS SUBJECT TO INSPECTIONS AND ENCROACHMENT PERMITS FROM THE JURISDICTION HAVING AUTHORITY OVER THE RIGHT-OF-WAY. REQUIREMENTS OF SUCH PERMITS ARE INCORPORATED INTO THESE DOCUMENTS BY REFERENCE.
- ANY DEFECTS IN CONSTRUCTION, INCLUDING MATERIALS OR WORKMANSHIP, SHALL BE REPLACED OR CORRECTED BY THE CONTRACTOR BY REMOVAL AND REPLACEMENT OR OTHER METHODS PRIOR TO ACCEPTANCE BY THE OWNER WITH NO ADDITIONAL COMPENSATION.
- CONTRACTOR SHALL SUBMIT A PLAN OF OPERATIONS FOR REVIEW AND APPROVAL BY THE ARCHITECT THAT WILL INDICATE EQUIPMENT STAGING AREAS, STOCKPILE LOCATION AND SANITATION FACILITIES.
- RIGHT-OF-WAY AND PROPERTY LINES SHOWN ARE PLOTTED FROM RUTHERFORD COUNTY G.I.S. MAPPINGS AND ARE APPROXIMATE AND NOT THE RESULT OF A FIELD BOUNDARY SURVEY.
- ALL OSHA, STATE AND LOCAL SAFETY REGULATIONS SHALL BE FOLLOWED DURING CONSTRUCTION.
- APPROPRIATE BARRICADES, WARNING LIGHTS, SIGNS, FENCING ETC. SHALL BE ERECTED AROUND THE CONSTRUCTION AREA DURING NON-WORKING HOURS TO ALERT PERSONS OF THE POTENTIAL DANGER ASSOCIATED WITH THE AREA UNDER CONSTRUCTION AS WELL AS TO PREVENT ACCESS BY UNAUTHORIZED PERSONNEL. THE CONTRACTOR IS RESPONSIBLE FOR ENSURING THE SAFETY OF THE GENERAL PUBLIC AS WELL AS ALL CONSTRUCTION PERSONNEL.
- ANY EXISTING ROADWAY, LAWN, CURB, SIDEWALK OR OTHER APPURTENANCE DISTURBED DURING CONSTRUCTION NOT DESIGNATED FOR REMOVAL OR REPLACEMENT SHALL BE RESTORED BY THE CONTRACTOR WITHOUT ADDITIONAL COMPENSATION TO A CONDITION EQUAL TO OR BETTER THAN THAT WHICH EXISTED PRIOR TO DISTURBANCE.
- ANY TEMPORARY UTILITY REQUIRED BY THE CONTRACTOR (ELECTRIC, WATER ETC.) SHALL BE AT THE SOLE EXPENSE OF THE CONTRACTOR.
- THE CONTRACTOR SHALL PRESERVE ALL BENCHMARKS, PROPERTY LINE REFERENCES, REFERENCE POINTS, STAKES AND ANY OTHER SURVEY REFERENCE. IN CASE OF DISTURBANCE THE CONTRACTOR SHALL REPLACE THEM AT THE CONTRACTOR'S EXPENSE, BE RESPONSIBLE FOR ANY ERRORS THAT MAY BE CAUSED BY THEIR LOSS OR DISTURBANCE.
- ALL PROPOSED CONCRETE PAVEMENT ABUTTING EXISTING PAVEMENT SHALL BE DOWELED INTO EXISTING CONCRETE PAVEMENT USING A ½" DEFORMED DOWEL WITH 9" MINIMUM EMBEDMENT.
- THE CONTRACTOR SHALL COMPLY AT ALL TIMES WITH APPLICABLE FEDERAL, STATE AND LOCAL LAWS, PROVISIONS, AND POLICIES GOVERNING SAFETY AND HEALTH, INCLUDING THE FEDERAL CONSTRUCTION SAFETY ACT (PUBLIC LAW 91-54), FEDERAL REGISTER, CHAPTER XVII, PART 1926 OF TITLE 29 REGULATIONS, OCCUPATIONAL SAFETY AND HEALTH REGULATIONS FOR CONSTRUCTION, AND SUBSEQUENT PUBLICATIONS UPDATING THESE REGULATIONS.
- THE CONTRACTOR SHALL BE RESPONSIBLE FOR EXAMINING THE AREAS AND CONDITIONS UNDER WHICH THE PROJECT IS TO BE CONSTRUCTED PRIOR TO THE SUBMISSION OF THE BID. SUBMISSION OF A BID SHALL BE CONSTRUED TO MEAN THE CONTRACTOR HAS REVIEWED THE SITE AND IS FAMILIAR WITH THE CONDITIONS AND CONSTRAINTS OF THE SITE.
- CONTRACTOR SHALL REFER TO OTHER PLANS WITHIN THIS CONSTRUCTION SET FOR OTHER PERTINENT INFORMATION.

ACCESSIBILITY NOTES

- ALL REQUIREMENTS OF THE AMERICANS WITH DISABILITIES ACT (ADA) SHALL BE FOLLOWED IN ALL ASPECTS OF THE PROJECT.
- ALL SIDEWALKS INSTALLED SHALL HAVE A MAXIMUM CROSS SLOPE OF 2%
- HANDICAP ACCESSIBLE PARKING SPACES SHALL NOT EXCEED A SLOPE OF 2% IN ANY DIRECTION
- ALL CURB RAMPS SHOWN ALONG A DESIGNATED ACCESSIBLE ROUTE SHALL BE FLUSH WITH THE ADJACENT PAVEMENT.

UTILITY NOTES

- THIS PLAN SHOWS THE APPROXIMATE LOCATION OF UNDERGROUND UTILITIES (GAS, WATER, STORM SEWER, SANITARY SEWER, TELEPHONE, ELECTRIC, ETC.). THE PREPARER DOES NOT GUARANTEE THEIR ACCURACY OR CORRECTNESS. THE INFORMATION PROVIDED SHALL BE FIELD VERIFIED PRIOR TO CONSTRUCTION. THE CONTRACTOR SHALL BE RESPONSIBLE FOR MAINTAINING THE UTILITY AS WELL AS THE SERVICE LATERALS AT ALL TIMES DURING CONSTRUCTION. THE CONTRACTOR SHALL PRACTICE CARE DURING THE GRADING AND TRENCH EXCAVATION AND SHALL BE RESPONSIBLE FOR REPLACING ANY SERVICES THAT ARE DAMAGED DURING CONSTRUCTION AT THEIR EXPENSE.
- PRIOR TO ANY EXCAVATION OVER AN EXISTING UTILITY LINE OR SERVICE, CONTRACTOR SHALL HAND EXCAVATE TO EXPOSE THE UTILITY AND DETERMINE LOCATION AND DEPTH. NOTIFY ENGINEER IMMEDIATELY OF ANY CONFLICTS.
- TOPS OF EXISTING AND PROPOSED CASTING ELEVATIONS ARE SUBJECT TO FINAL ADJUSTMENTS AS APPROVED BY THE ENGINEER AND REQUIREMENTS OF UTILITY OWNER. THIS WORK WILL BE INCIDENTAL TO THE CONTRACT.
- FORTY-EIGHT (48) HOURS BEFORE EXCAVATION IS TO COMMENCE, THE CONTRACTOR SHALL NOTIFY THE FOLLOWING AGENCIES: THE TENNESSEE UTILITY PROTECTION SERVICE AND ALL OTHER UTILITIES THAT MAY HAVE UNDERGROUND UTILITIES INVOLVING THIS PROJECT AND ARE NON-MEMBERS OF KENTUCKY UNDERGROUND PROTECTION.
- THE SITE MAY CONTAIN EXISTING PRIVATELY OWNED UTILITIES. THESE HAVE BEEN SHOWN AS ACCURATELY AS POSSIBLE BASED ON EXISTING UTILITY INFORMATION, BUT THE PREPARER OF THESE DOCUMENTS DOES NOT ATTEST TO THEIR ACCURACY OR CORRECTNESS. IT SHALL BE THE CONTRACTOR'S RESPONSIBILITY TO CONTRACT WITH A PRIVATE UTILITY MARKING AGENCY TO IDENTIFY AND LOCATE ALL PRIVATE UTILITIES WITHIN THE WORK SITE. THIS MAY INVOLVE THE EXCAVATION AND UNCOVERING OF UTILITIES TO VERIFY LOCATION. NOTIFY ENGINEER IMMEDIATELY OF ANY CONFLICTS. CONTRACT SHALL MAKE RECORDS OF ALL PRIVATE UTILITIES ENCOUNTERED DURING THE PROJECT.
- RECORD DRAWINGS OF NEW UTILITY SERVICES SHALL BE PREPARED BY THE CONTRACTOR AND SUBMITTED TO THE OWNER UPON COMPLETION OF THE PROJECT.

EXISTING CONDITIONS AND DEMOLITION NOTES

- THE CONTRACTOR MUST CONTACT TENNESSEE811 AT LEAST 3 DAYS, BUT NO MORE THAN 10 WORKING DAYS, BEFORE BEGINNING ANY DIGGING, EXCLUDING SATURDAYS, SUNDAYS AND OTHER LEGAL HOLIDAYS. NON-MEMBER UTILITIES MUST BE CONTACTED DIRECTLY. THE CONTRACTOR SHALL COORDINATE THE MARKING AND/OR LOCATING TO STAY A MINIMUM OF TWO WORKING DAYS AHEAD OF PLANNED CONSTRUCTION ACTIVITIES.
- THE CONTRACTOR SHALL REMOVE ALL SURPLUS MATERIAL, DEMOLISHED MATERIALS AND WASTE MATERIALS INCLUDING TREES, STUMPS, BRUSH, TRASH AND DEBRIS, FROM THE PROJECT LIMITS AND LEGALLY DISPOSE OF OFF-SITE.
- IF ADJACENT PAVEMENT IS DAMAGED, THE CONTRACTOR SHALL MAKE SAWCUTS, REMOVE THE DAMAGED AREAS AND REPAIR AS NECESSARY WITH NO ADDITIONAL COMPENSATION.

SIGNAGE NOTES

- ALL SIGNS SHALL MEET THE REQUIREMENT OF THE MANUAL OF UNIFORM TRAFFIC CONTROL DEVICES (MUTCD).
- ALL SIGNS ARE 12"x18" UNLESS NOTED OTHERWISE.
- ALL SIGNS SHALL HAVE REFLECTIVE MATERIAL PER MUTCD.

LEGEND

	CRACK SEAL AND SEAL COAT PAVEMENT
	1.5" MILL AND OVERLAY PER DETAIL SHT. 3
	FULL DEPTH PAVEMENT REPAIR PER DETAIL SHT. 3

MAINTENANCE OF TRAFFIC NOTES

- ALL MAINTENANCE OF TRAFFIC PROCEDURES SHALL MEET THE REQUIREMENT OF THE MANUAL OF UNIFORM TRAFFIC CONTROL DEVICES. THE CONTRACTOR SHALL MAINTAIN ACCESS TO LOCAL TRAFFIC (ACCESS TO RESIDENCES WITHIN CONSTRUCTION LIMITS) AT ALL TIMES. THE CONTRACTOR SHALL PROVIDE SUFFICIENT SIGN, WARNING LIGHTS, BARRICADES, OR OTHER NECESSARY DEVICES MAKE THE SITE SAFE TO THE TRAVELING PUBLIC.
- IT SHALL BE THE CONTRACTOR'S RESPONSIBILITY TO SUBMIT TO THE ENGINEER AND THE OWNER A TRAFFIC CONTROL PLAN FOR THIS PROJECT.
- RESIDENTS OF THE PROJECT AREA SHALL BE ALLOWED ACCESS TO THEIR PROPERTY AT ALL TIMES.
- ALTERNATE ROUTES OR CONTINUOUS TRAFFIC CONTROL SHALL BE EMPLOYED AND A PUBLIC WAY IS TEMPORARILY BLOCKED DURING CONSTRUCTION, INCLUDING PEDESTRIAN AND BICYCLE FACILITIES. ADVANCED NOTICE SIGNS IN ACCORDANCE WITH THE MUTCD SHALL BE EMPLOYED.

PAINT STRIPING NOTES

- PAINT STRIPING SHALL BE INSTALLED TO MATCH EXISTING EXCEPT THAT ACCESSIBLE PARKING SPACES SHALL BE INSTALLED TO MEET MOST CURRENT ADA REQUIREMENTS. VAN ACCESSIBLE SPOT(S) SHALL BE INSTALLED PER ADA REQUIREMENTS. ALL WORK SHALL BE PERFORMED IN ACCORDANCE WITH SECTION 716 OF THE 2021 TDOT STANDARD SPECIFICATION FOR ROAD AND BRIDGE CONSTRUCTION AND ANY OTHER SECTIONS APPLICABLE AND THE FEDERAL HIGHWAY ADMINISTRATION "MANUAL OF UNIFORM TRAFFIC CONTROL DEVICES.
- THERMOPLASTIC PAVEMENT MARKING SHALL BE USED FOR STOP BARS, CROSSWALKS, AND DIRECTIONAL ARROWS AS DEFINED BY SECTION 716.03 FOR WHITE STRIPES AND MARKING PER THE 2021 TDOT STANDARD SPECIFICATION FOR ROAD AND BRIDGE CONSTRUCTION.
- ALL OTHER PAINT MARKING SHALL BE 4" WIDE STRIPING PAINTED WHITE

VEGETATION REMOVAL

- VEGETATION GROWING THROUGH THE SURFACE OF THE PAVEMENT BEING PREPARED FOR CRACK SEALING AND/OR SEAL COATING SHALL BE REMOVED AND STERILIZED BY THE USE OF A PROPANE TORCH UNIT ELIMINATING ALL VEGETATION, DIRT, MOISTURE AND SEEDS. AT THE OPTION OF THE VENDOR, A HERBICIDE MAY BE APPLIED PRIOR TO THE SURFACE TREATMENT APPLICATION. THIS SHALL BE APPLIED FAR ENOUGH AHEAD OF THE SURFACE TREATMENT APPLICATION TO SUFFICIENTLY GIVE THE VEGETATION ENOUGH TIME TO PROPERLY BROWN SO THAT WHEN COMPLETING THE FINAL SWEEPING BEFORE SURFACE TREATMENT NO VEGETATION IS LEFT. VEGETATION REMOVAL SHALL BE CONSIDERED INCIDENTAL TO ALL OTHER BID ITEMS IN THIS SOLICITATION.
- IF A CHEMICAL HERBICIDE IS USED, IT SHALL BE APPLIED ACCORDING TO THE MANUFACTURER'S SPECIFICATIONS. THE VEGETATION SHALL BE TOTALLY BROWNED BEFORE THE CRACK SEAL AND THE SEAL COATING IS INSTALLED. THE PERSON APPLYING THE HERBICIDE SHALL HAVE, OR BE UNDER THE SUPERVISION OF SOMEONE THAT HAS, THE PROPER STATE OF TENNESSEE PESTICIDE APPLICATORS LICENSE

POTHOLE REPAIR

- ALL POTHOLES SHALL BE REPAIRED BEFORE THE CRACK SEAL IS APPLIED. THE CONTRACTOR SHALL SAW CUT THE EXISTING ASPHALT A MINIMUM OF 6" PAST THE POTHOLE AND ASSOCIATED CRACKING IN ALL DIRECTIONS. ALL SAW CUTS SHALL BE PERFORMED TO LEAVE ONLY SQUARE OR RECTANGULAR SHAPED REPAIRS. ANY JAGGED OR MISSHAPED REPAIRS SHALL BE REJECTED AND REPLACED BY THE CONTRACTOR AT NO ADDITIONAL COST TO THE COUNTY.
- THE VENDOR SHALL REMOVE THE ASPHALT AND ANY LOOSE BASE MATERIAL. THE AREA SHALL BE FILLED WITH HOT MIX ASPHALT. ONCE THE ASPHALT HAS BEEN PROPERLY COMPACTED, THE FINAL RESULT OF THE INSTALLATION SHALL PROVIDE EVEN TRANSITIONS TO THE EXISTING AREA AND HAVE JOINTS THAT ARE NOT EXCESSIVE AND A GOOD QUALITY RIDE IS PROVIDED. NO MORE THAN ONE-QUARTER (¼) INCH DIFFERENCE IN HEIGHT SHALL BE ALLOWED FOR THE TRANSITION BETWEEN THE PATCH AREA AND THE ADJACENT AREA. ALL SAWCUTS, REMOVAL, DISPOSAL, PREPARATION, MATERIALS, LABOR AND EQUIPMENT NECESSARY TO COMPLETE PATCHES SHALL BE INCIDENTAL TO THE RESPECTIVE BID ITEMS. COLD PATCH ASPHALT SHALL NOT BE PERMITTED.

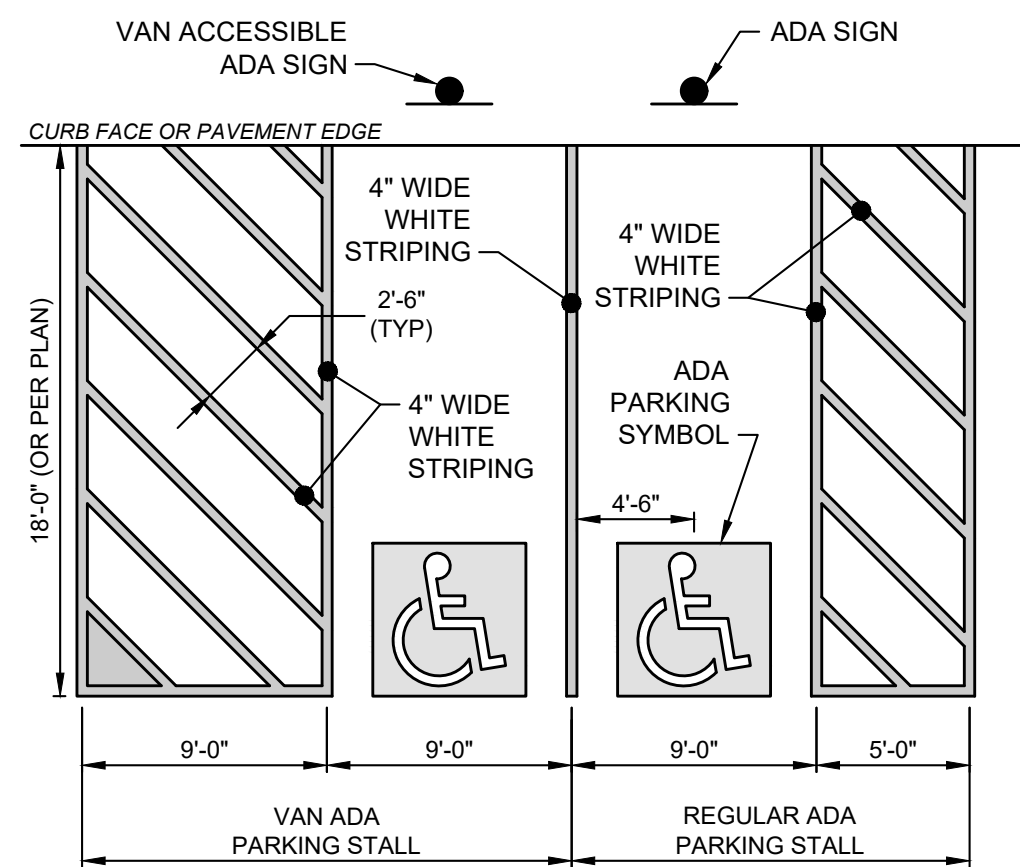

- NOTES:
- THIS DETAIL IS FOR REFERENCE AND DIMENSION CONTROL ONLY; SEE LAYOUT PLAN FOR ACTUAL CONFIGURATIONS AND NOT ALL ITEMS SHOWN MAY APPLY.
 - SEE SEPARATE DETAILS FOR SIGNS AND HANDICAP PARKING SYMBOL.

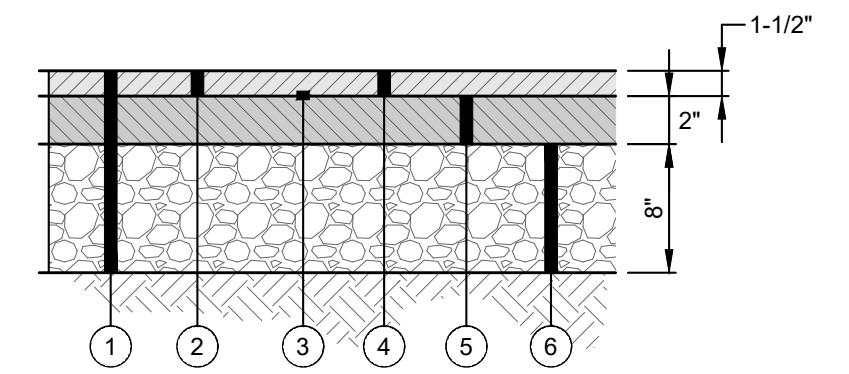
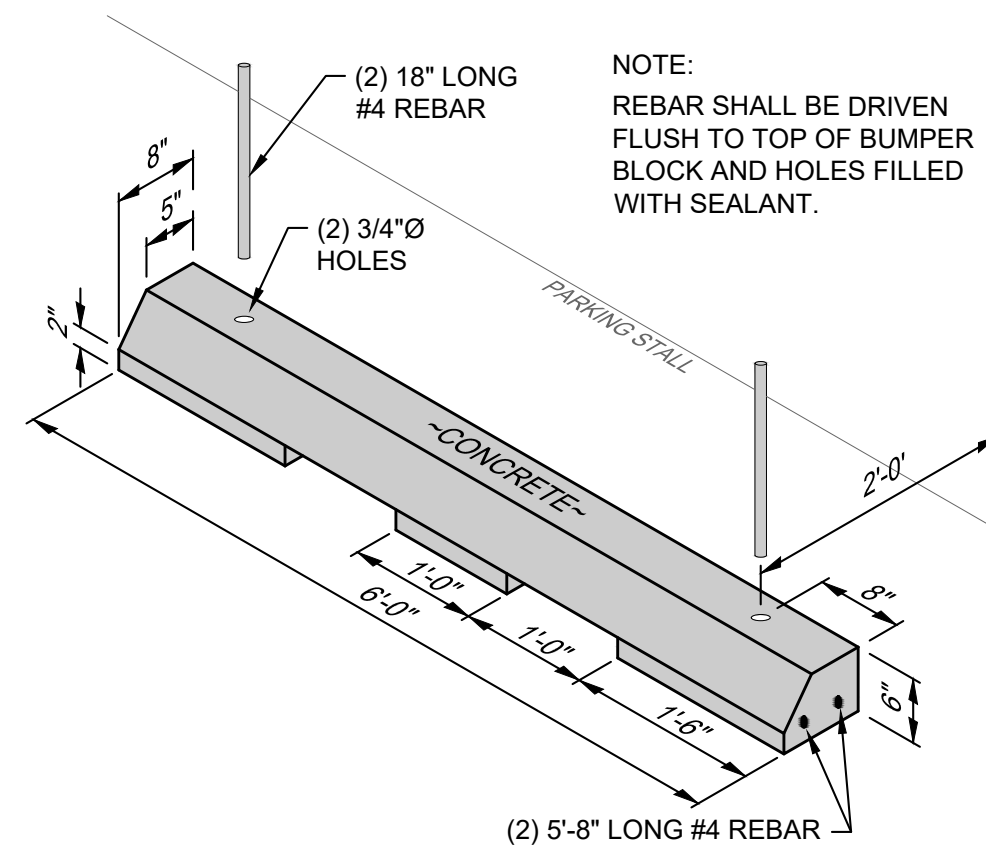
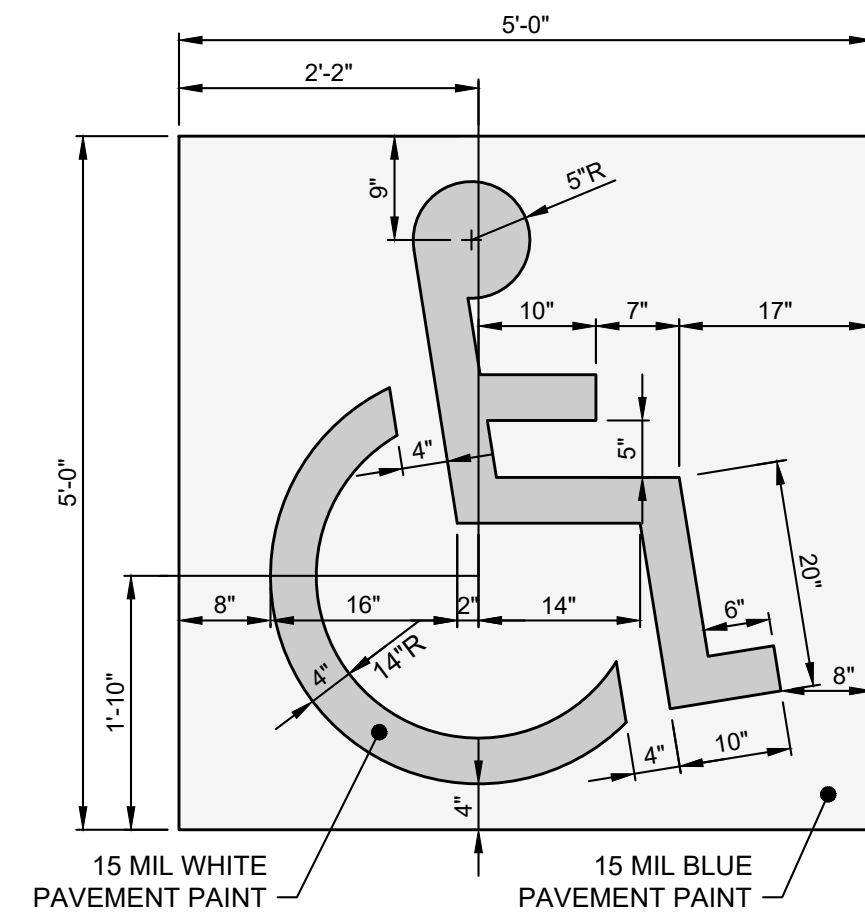

- ① EXISTING ASPHALT PAVEMENT SECTION
② ASPHALT MILLING (1.5" TYP.)
③ TACK COAT (0.1 GAL/SY)
④ 1-1/2" ASPHALT PAVEMENT SURFACE
⑤ EXISTING 2" ASPHALT TO REMAIN
⑥ EXISTING GRAVEL BASE TO REMAIN

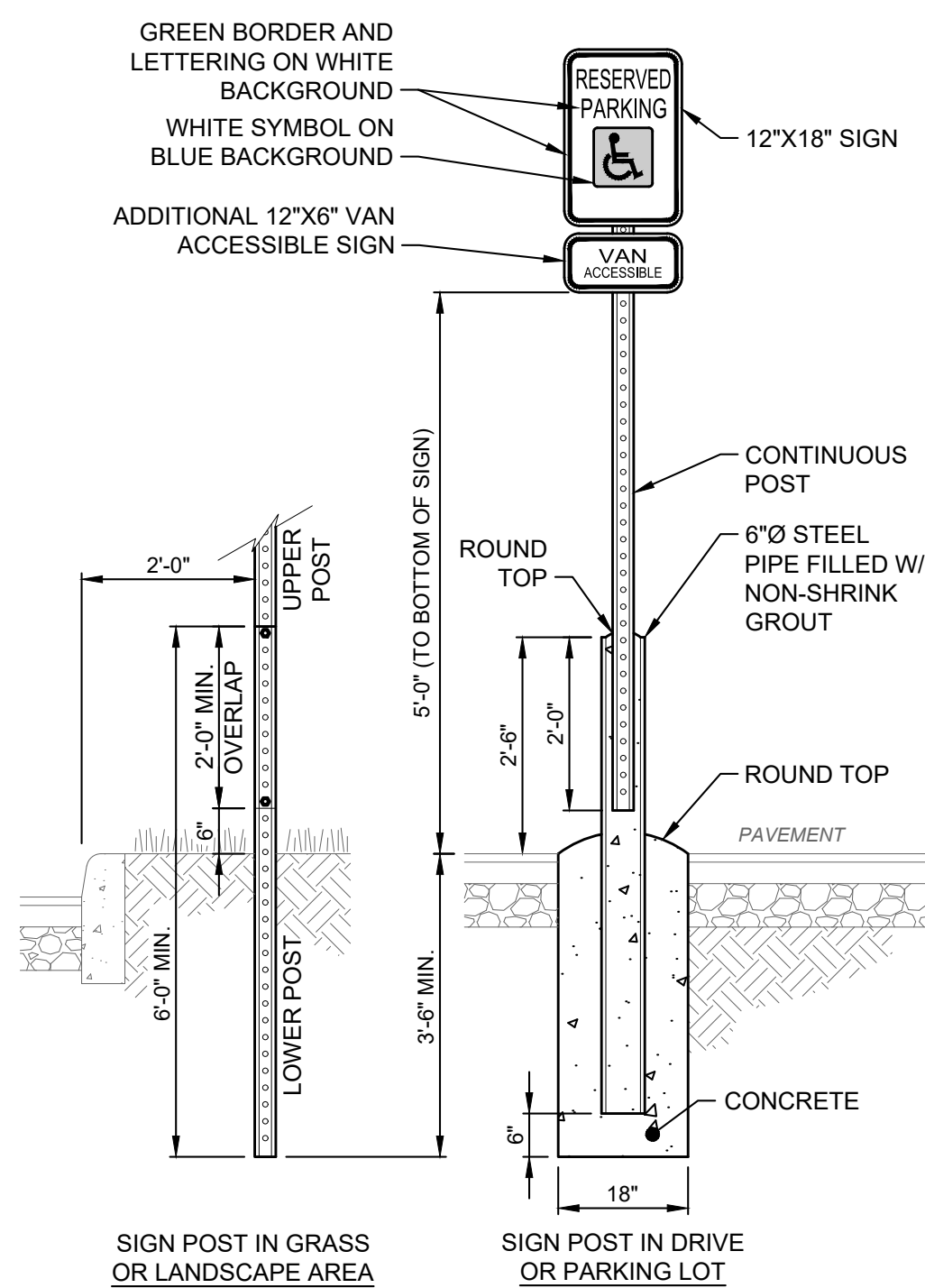

- NOTES:
- ALL CONCRETE SHALL BE TDOT CLASS D (4,000 PSI).
 - POST SHALL BE 2 LB/FT GALVANIZED STEEL U-CHANNEL WITH 3/8" HOLES ON 1" CENTERS.
 - PAINT STEEL PIPE SILVER OR TO MATCH EXISTING PIPES.

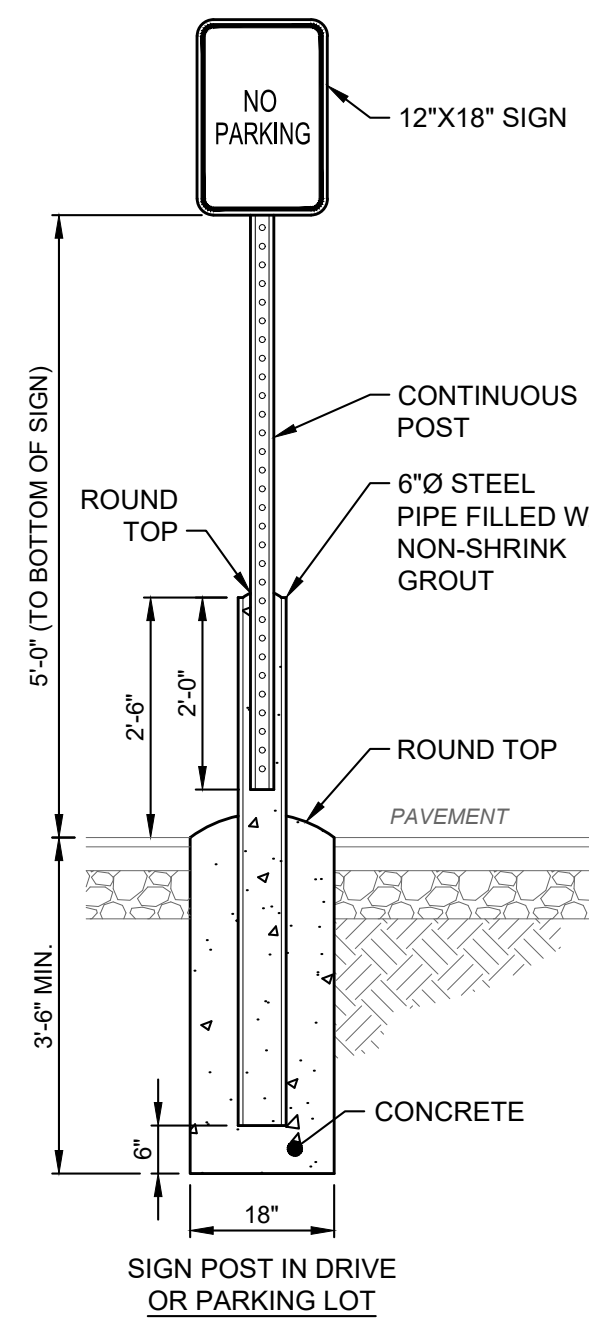

- NOTES:
- ALL CONCRETE SHALL BE TDOT CLASS D (4,000 PSI).
 - POST SHALL BE 2 LB/FT GALVANIZED STEEL U-CHANNEL WITH 3/8" HOLES ON 1" CENTERS.
 - PAINT STEEL PIPE SILVER OR TO MATCH EXISTING PIPES.

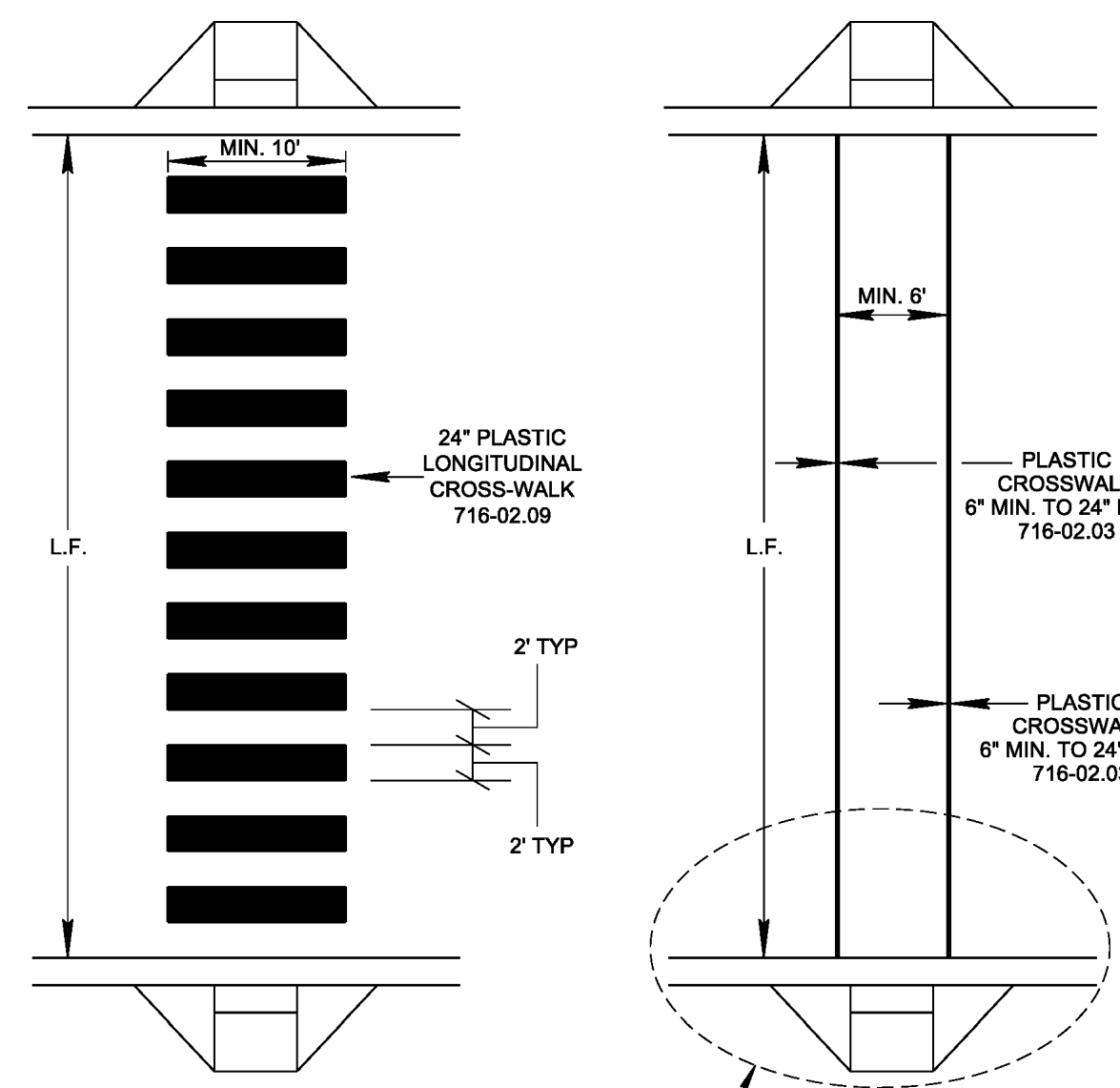

- GENERAL NOTES**
- ALL PAVEMENT MARKING WILL BE USED FOR ALL CENTER LINE, LANE LINES AND EDGE LINES ON ALL ROADS EXCEPT WHERE AS SHOWN ON STANDARD DRAWINGS.
 - SPECIAL PAVERS AND PAVEMENT TEXTURES ARE NOT ACCEPTABLE CROSS-WALK MARKINGS. THEREFORE, SPECIAL PAVERS AND PAVEMENT TEXTURES SHALL ONLY BE USED IN CONJUNCTION WITH TRAVERSE CROSS-WALK MARKINGS. SPECIAL PAVERS ARE TO BE DESIGNED TO MEET PAVEMENT DESIGN SCHEDULE AND DESIGN LOADING, ON STATE ROUTES, DETAILS SHALL BE REVIEWED AND APPROVED BY THE DEPARTMENT.
 - IF SPECIAL PAVERS AND PAVEMENT TEXTURES, OR ANY OTHER ARCHITECTURAL PAVEMENT MATERIALS ARE USED, THE ARCHITECTURAL PAVEMENT MATERIALS SHALL PROVIDE A SMOOTH, WITHOUT JOINT, WALKABLE/RIDEABLE, STABLE, FIRM AND SLIP-RESISTANT SURFACE PER ADA STANDARDS.
 - ARCHITECTURAL PAVERS SHALL BE PAID FOR UNDER ITEM NO. 701-01.08, CONCRETE PAVERS (CROSS-WALK) PER. SF.
- STOP LINE PLACEMENT**
- LOCATION SHALL BE DETERMINED BY VEHICLE TURNING PATHS FROM INTERSECTION ROADWAY, AND IF SIGNALIZED, ITS POSITION RELATIVE TO SIGNAL HEADS, PER MANUAL ON UNIFORM TRAFFIC CONTROL DEVICES.
 - STOP LINES SHALL BE PAID FOR UNDER THE FOLLOWING ITEM NUMBER: 716-02.05, PLASTIC PAVEMENT MARKING (STOP LINE), PER LF.
 - STOP LINES REQUIRED ONLY ON APPROACHES CONTROLLED BY STOP SIGNS OR TRAFFIC SIGNALS.
- PAYMENT**
- PAVEMENT MARKINGS SHALL BE PAID FOR UNDER ITEM NO. 716-02.09, PLASTIC PAVEMENT MARKING (LONGITUDINAL CROSS-WALK) PER LF. ON LOCAL ROADS WITH ADT<1000, PAVEMENT MARKINGS COULD ALTERNATELY BE PAID FOR UNDER ITEM NO. 716-05.22, PAINTED PAVEMENT MARKING (LONGITUDINAL CROSS-WALK) PER LF. MEASUREMENT IS CALCULATED AS THE FULL WIDTH OF PAVEMENT.
 - PAVEMENT MARKINGS SHALL BE PAID FOR UNDER ITEM NO. 716-02.03, PLASTIC PAVEMENT MARKING (CROSSWALK) PER LF. ON LOCAL ROADS WITH ADT<1000, PAVEMENT MARKINGS COULD ALTERNATELY BE PAID FOR UNDER ITEM NO. 716-05.03, PAINTED PAVEMENT MARKING (CROSSWALK) PER LF. MEASUREMENT IS CALCULATED AS THE FULL WIDTH OF PAVEMENT.

CROSSWALK DETAIL
SCALE: NONE

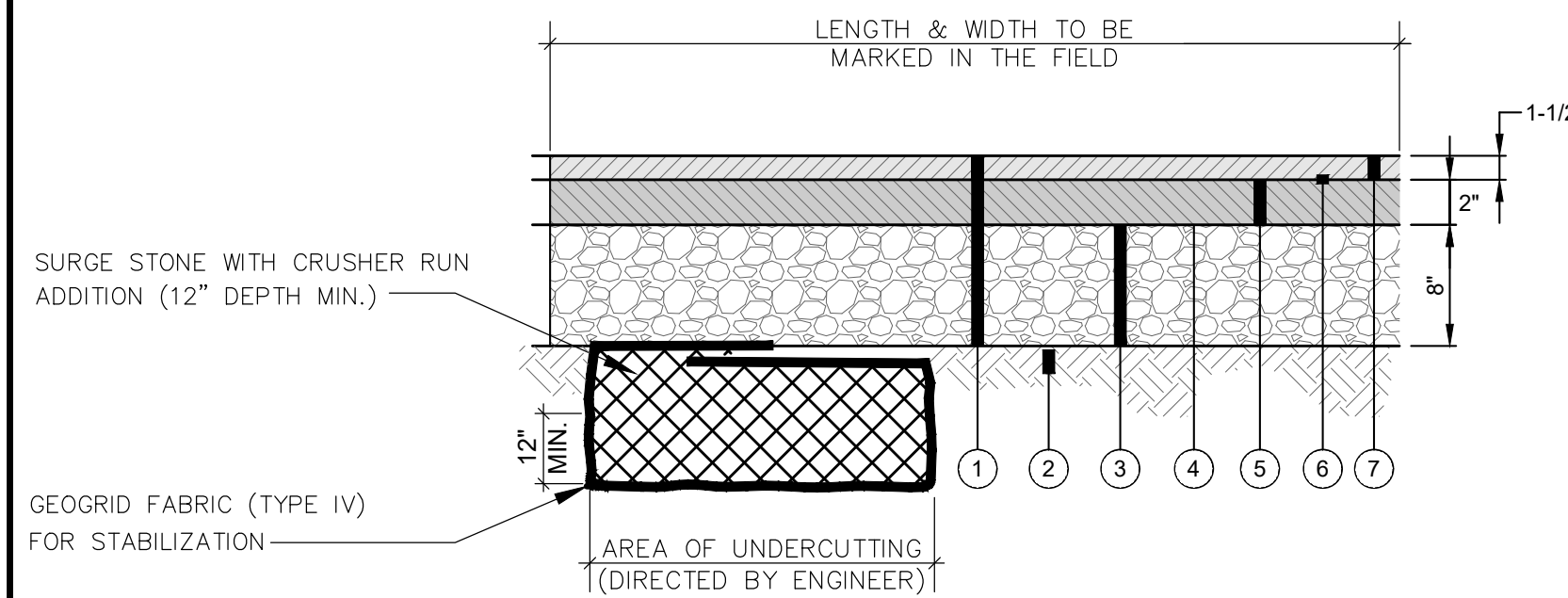

- ① REMOVE EXISTING PAVEMENT
② PROOFROLL AND COMPACT SUBGRADE
③ 8" COMPACTED STONE BASE (GRADING D PUG MILL MIX)
④ PRIME COAT (0.3 GAL/SY)
⑤ 2" ASPHALT LEVELLING
⑥ TACK COAT (0.1 GAL/SY)
⑦ 1-1/2" ASPHALT PAVEMENT SURFACE

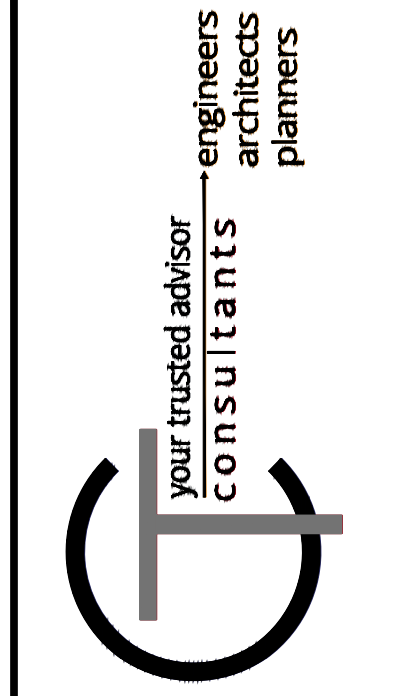
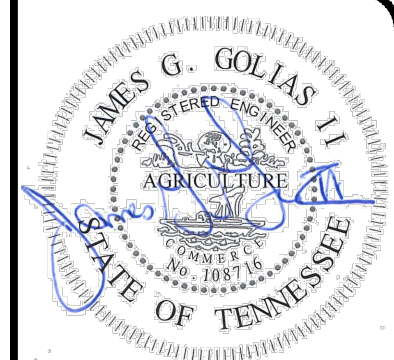

DATE	REVISION	NO	ISSUED FOR:	CONSTRUCTION	ISSUE DATE:	SCALE:	DESIGNED BY:	DRAWN BY:	CHECKED BY:
					01/19/2024		MHOR	MHOR	JGOL

MOTLOW STATE COMMUNITY COLLEGE
ADDITIONAL PARKING AND ROADWAY REPAIRS
SMYRNA, TENNESSEE 37167
SBC NO. 166021-01-2022A

DETAILS

PROJECT NO.	220439
DISCIPLINE	CIVIL
SHEET NAME	C3
SHEET	3
OF	4

SIGNAGE LEGEND

(A0) RESERVED PARKING
(B0) RESERVED PARKING VAN
(C0) VISITOR PARKING ONLY
(D0) RESERVED PARKING ALL HOURS
(E0) STOP

(X1) EXISTING POST AND SIGN TO REMAIN
(X2) REMOVE AND REPLACE POST
(X3) REMOVE AND REPLACE POST AND SIGN
(X4) INSTALL NEW SIGN AND POST

HATCH LEGEND

CRACK SEAL AND SEAL COAT PAVEMENT

1.5" MILL AND OVERLAY PER DETAIL SHT. 3

FULL DEPTH PAVEMENT REPAIR PER DETAIL SHT. 3

PAVEMENT MARKING LEGEND

FACULTY/STAFF PARKING ONLY

PAINTED WHITE 12" LETTER HEIGHT

LEGEND

15 PARKING SPACE COUNT

6' CONCRETE BUMPER BLOCK PER DETAIL SHT. 3

QUANTITY NOTES

QUANTITIES SHOWN ARE FOR REFERENCE. CONTRACTOR IS RESPONSIBLE FOR VERIFYING QUANTITIES AND INFORMING THE OWNER/DESIGNER OF DISCREPANCIES PRIOR TO CONTRACT AWARD.

MILL AND RESURFACE: 4,500 SQ FT
RESEALED PAVEMENT: 305,100 SQ FT
FULL DEPTH REPAIR: 500 SQ FT
STRIPING: 13,108 LINEAR FT
ADA SYMBOLS: 23
TRAVERSE STRIPING AREA: 3,364 SQ FT
PAINTED SYMBOLS: 1,824 CHARACTERS
STOP BARS/CROSSWALK BARS: 23
CONCRETE BUMPERS: 10
UNDERCUTTING: 50 CY

NOTES

FINAL LIMITS OF PAVEMENT REMOVE TO BE FIELD VERIFIED BY CONTRACTOR AND OWNER PRIOR TO CONSTRUCTION.

PARKING CALCULATION:
ADA PARKING REQUIREMENT: 13 ADA SPACES
TOTAL PARKING SPACES PROVIDED: 627
TOTAL ADA SPACES: 23

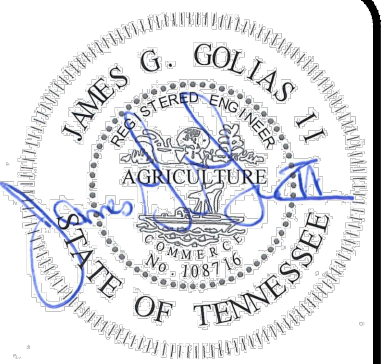
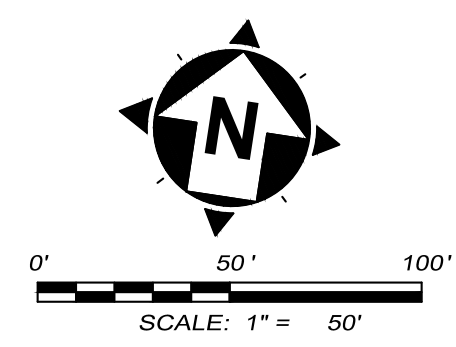

your trusted advisor
CONSULTANTS
engineers
architects
planners



NO	REVISION	DATE

ISSUED FOR: CONSTRUCTION	01/19/2024
ISSUE DATE:	01/19/2024
SCALE:	MHOR
DESIGNED BY:	MHOR
DRAWN BY:	MHOR
CHECKED BY:	JGOL

MOTLOW STATE COMMUNITY COLLEGE
ADDITIONAL PARKING AND ROADWAY REPAIRS
SMYRNA, TENNESSEE 37167
SEC NO. 166021-01-2022A

ALTERNATE 1

PROJECT NO.	220439
DISCIPLINE	CIVIL
SHEET NAME	C4
SHEET	4
OF	4