

# CITY OF SOUTHGATE CAMPBELL COUNTY, KENTUCKY SOUTHGATE 2024 STREET PROGRAM 241022

CITY OF SOUTHGATE OFFICIALS	
<b>MAYOR</b>	JIM HAMBERG
<b>CITY CLERK</b>	BRANDI BARTON
<b>CITY COUNCIL MEMBERS</b>	JOE ANDERSON
	MIKE LYCANS
	AILEEN OKURA
	PAUL MELVILLE
	MARK MESSMER
	THOMAS WEGENER
<b>CITY ATTORNEY</b>	MARY ANN STEWART
<b>PUBLIC WORKS DIRECTOR</b>	ARVIL BOWMAN

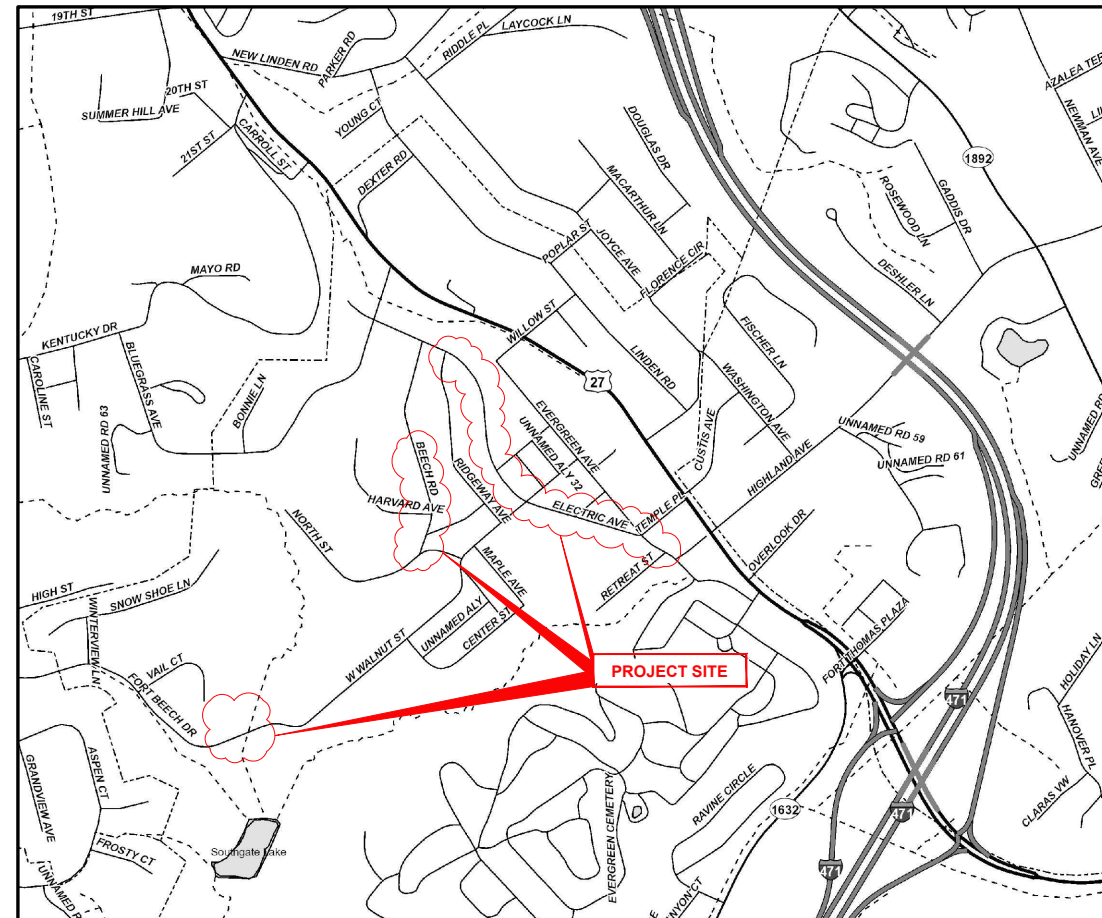

VICINITY MAP

INDEX OF SHEETS		
NO.	DWG NAME	SHEET NAME
1	TTL	TITLE SHEET
2	NOTES	NOTES & LEGEND
3	DTL-01	DETAIL SHEET 1
4	DTL-02	DETAIL SHEET 2
5	PLAN-01	PLAN SHEET 1 - ELECTRIC AVE STA. 10+00 TO 20+00
6	PLAN-02	PLAN SHEET 2 - ELECTRIC AVE STA 20+00 TO 28+50
7	PLAN-03	PLAN SHEET 3 - EVERGREEN AVE STA 28+50 TO 32+00
8	PLAN-04	PLAN SHEET 04 - BEECH RD STA 40+00 TO 46+00
9	PLAN-05	PLAN SHEET 05 - PUBLIC WORKS PARKING LOT
10	GRADE	SPOT GRADING SHEET



DATE	REVISION	NO	BID	ISSUED FOR:	ISSUE DATE:	SCALE:	DESIGNED BY:	DRAWN BY:	CHECKED BY:
			02222024	AS SHOWN	02/22/2024	AS SHOWN	RSEI	RSEI	JSHU

**SOUTHGATE 2024 STREET PROGRAM**  
CITY OF SOUTHGATE  
- CAMPBELL COUNTY, KY -  
**TITLE SHEET**

PROJECT NO.	241022
DISCIPLINE	CIVIL
SHEET NAME	TTL
SHEET	OF
1	10

**K.T.C SPECIFICATIONS**

THE LATEST STANDARD SPECIFICATIONS OF THE KENTUCKY TRANSPORTATION CABINET, INCLUDING CHANGES AND SUPPLEMENTAL SPECIFICATIONS THERETO, AND THE CAMPBELL COUNTY SUBDIVISION REGULATIONS SHALL GOVERN THIS IMPROVEMENT PROJECT

**SOURCE OF BOUNDARY INFORMATION**

THE BOUNDARY INFORMATION SHOWN ON THESE PLANS IS BASED UPON CAMPBELL COUNTY G.I.S. MAPPING AND DOES NOT REPRESENT AN ACTUAL FIELD BOUNDARY SURVEY BY CT CONSULTANTS, INC.



**GENERAL NOTES**

- 1. ALL CONSTRUCTION SHALL CONFORM TO THESE PLANS AND SPECIFICATIONS, THE LATEST EDITION OF THE CAMPBELL COUNTY SUBDIVISION REGULATIONS AND THE KENTUCKY DEPARTMENT OF HIGHWAYS STANDARD SPECIFICATIONS FOR ROAD AND BRIDGE CONSTRUCTION.
- 2. EXPANSION MATERIAL SHALL BE FLEXIBLE FOAM MATERIAL, SUCH AS CERAMAR BY W.R. MEADOWS OR APPROVED EQUAL, INSTALLED IN AREAS OF CONCRETE WALK, DRIVES OR CURB/GUTTER ONLY AT THE FOLLOWING:
  - A. AT ALL FIXED OBJECTS (I.E. UTILITY COVERS, VALVES, MANHOLES, ETC.)
  - B. AT ALL RIGID STRUCTURES (I.E. DRIVES, CURBS, STEPS, ETC.) PAYMENT FOR THIS ITEM AND ZIP STRIPS INCLUDED IN THE PERTINENT CONCRETE PAVEMENT UNIT PRICE.
  - C. AT ALL STREET INTERSECTIONS AT THE POINT OF CURVATURE OF THE TURNING RADII ENTERING THE INTERSECTION.
  - D. NO CONCRETE SHALL BE LEFT ABOVE THE EXPANSION MATERIAL OR ACROSS THE JOINT AT ANY POINT. ANY CONCRETE SPANNING THE ENDS OF THE JOINT NEXT TO THE FORMS SHALL BE CAREFULLY CUT AWAY AFTER THE FORMS ARE REMOVED. BEFORE THE PAVEMENT IS OPENED TO TRAFFIC, THE GROOVE ABOVE THE EXPANSION JOINT MATERIAL SHALL BE CLEANED AND SEALED WITH JOINT SEALING MATERIAL.
- 3. ROADWAY REPLACEMENT PROJECT IS ESTIMATED TO BEGIN MAY 01, 2024, THE SECTION OF ELECTRIC AVENUE FROM WALNUT TO TEMPLE SHALL BE COMPLETED FIRST IN THE PROJECT AN BE COMPLETED NO LATER THAN JULY 01, 2024, AND THE REMAINDER OF THE PROJECT SHALL BE SUBSTANTIALLY COMPLETE NO LATER THAN AUGUST 31, 2024.
- 4. DOWNSPOUT AND UNDERDRAIN CONSTRUCTION SHALL MEET THESE AND THE LATEST SPECIFICATION OF THE CAMPBELL COUNTY SUBDIVISION REGULATIONS, SD-1 REGULATIONS AND STANDARD DRAWINGS, AND DETAILS SHOWN ON THIS PLAN. BEDDING, BACKFILLING, JOINTS, EXCAVATION AND INSTALLATION SHALL BE INCLUDED IN THE COST PER FOOT OF PIPE. STORM SEWER, DOWNSPOUT AND UNDERDRAIN PIPE MATERIAL SHALL HAVE A MANNINGS "N" VALUE OF 0.013 OR LESS (UNLESS OTHERWISE SHOWN) AND BE RIGID / SMOOTH INTERIOR WALLED PVC SDR-35 PIPE, RIBBED PVC PIPE, A-2000 PVC PIPE, UNLESS OTHERWISE SHOWN.
- 5. ALL DISTURBED AREAS ARE TO BE RESTORED (SEEDED AND MULCHED) BY THE CONTRACTOR AND SHALL PROCEED WITH JOB PROGRESSION. THE CONTRACTOR SHALL ALSO BE RESPONSIBLE FOR REMOVING ANY EXCESS MATERIALS AT THE SITE AND MAINTAINING ALL SEEDED AND MULCHED AREAS UNTIL PROJECT COMPLETION AND FINAL INSPECTION PER RDOT SPEC. 212. A RESIDENTIAL YARD SHALL BE RESTORED WITHIN TWENTY-ONE (21) DAYS AFTER CONSTRUCTION.
- 6. ALL APPLICABLE RECOMMENDATIONS IN KENTUCKY'S BEST MANAGEMENT PRACTICES MANUAL SHALL BE FOLLOWED BY THE CONTRACTOR, INCLUDING SEEDING OF DISTURBED GROUND.
- 7. RIGHT-OF-WAY AND PROPERTY LINES SHOWN ARE PLOTTED FROM CAMPBELL COUNTY G.I.S. MAPPING AND ARE APPROXIMATE AND NOT THE RESULT OF A FIELD BOUNDARY SURVEY.
- 8. THE CONTRACTOR SHALL LIMIT THEIR WORK AREA TO THE EASEMENTS AND RIGHTS-OF-WAY SHOWN ON THESE PLANS UNLESS WRITTEN PERMISSION IS GIVEN BY THE PROPERTY OWNER AND APPROVED BY THE CITY OF SOUTHGATE.
- 9. ALL OSHA, STATE AND LOCAL SAFETY REGULATIONS SHALL BE FOLLOWED DURING CONSTRUCTION.
- 10. RELOCATION OR REINSTALLATION OF EXISTING MAIL BOXES, FENCES, PRIVATE LANDSCAPE LIGHTS, PRIVATE SIGNS, STREET SIGNS, RESTORATION OF LANDSCAPING AND TREATMENT OF EXISTING WALLS WHERE A PORTION HAS BEEN REMOVED SHALL BE INCIDENTAL TO CLEARING AND GRUBBING.
- 11. NO CONSTRUCTION SHALL COMMENCE UNTIL ALL CAMPBELL COUNTY AND THE CITY OF SOUTHGATE PERMITS HAVE BEEN ISSUED AS REQUIRE
- 12. THE CONTRACTOR SHALL COORDINATE ALL WORK WITHIN THE PUBLIC RIGHT OF WAY WITH THE CITY OF SOUTHGATE. LOCAL TRAFFIC MUST BE MAINTAINED AT ALL TIMES DURING CONSTRUCTION UNLESS OTHERWISE NOTED IN THESE PLANS.
- 13. ADDITIONAL BMP'S AND EROSION AND SEDIMENT CONTROL MEASURES MAY BE REQUIRED AS DEEMED NECESSARY. ALL COST FOR ABOVE SHALL BE INCLUDED IN LUMP SUM BID FOR EROSION CONTROL AND WATER POLLUTION CONTROL.
- 14. LIMITS OF DRIVEWAY APRON & SIDEWALK REPLACEMENT TO BE MARKED IN THE FIELD BY THE ENGINEER. ADDITIONAL DRIVEWAY & SIDEWALK REPLACEMENTS, NOT SHOWN ON THE PLANS MAY BE REQUIRED BY THE ENGINEER.

**UTILITY NOTES**

- 1. THIS PLAN SHOWS THE APPROXIMATE LOCATION OF UNDERGROUND UTILITIES (GAS, WATER, STORM SEWER, SANITARY SEWER, TELEPHONE, ELECTRIC, ETC.). THE PREPARER DOES NOT GUARANTEE THEIR ACCURACY OR CORRECTNESS. THE INFORMATION PROVIDED SHALL BE FIELD VERIFIED PRIOR TO CONSTRUCTION. THE CONTRACTOR SHALL BE RESPONSIBLE FOR MAINTAINING THE UTILITY AS WELL AS THE SERVICE LATERALS AT ALL TIMES DURING CONSTRUCTION. THE CONTRACTOR SHALL PRACTICE CARE DURING THE GRADING AND TRENCH EXCAVATION AND SHALL BE RESPONSIBLE FOR REPLACING ANY SERVICES THAT ARE DAMAGED DURING CONSTRUCTION AT THEIR EXPENSE.
- 2. PRIOR TO ANY EXCAVATION OVER AN EXISTING UTILITY LINE OR SERVICE, CONTRACTOR SHALL HAND EXCAVATE TO EXPOSE THE UTILITY AND DETERMINE LOCATION AND DEPTH. NOTIFY ENGINEER IMMEDIATELY OF ANY CONFLICTS.
- 3. TOPS OF EXISTING AND PROPOSED CASTING ELEVATIONS ARE SUBJECT TO FINAL ADJUSTMENTS AS APPROVED BY THE ENGINEER AND REQUIREMENTS OF UTILITY OWNER. THIS WORK WILL BE INCIDENTAL TO THE CONTRACT.
- 4. FORTY-EIGHT (48) HOURS BEFORE EXCAVATION IS TO COMMENCE, THE CONTRACTOR SHALL NOTIFY THE FOLLOWING AGENCIES: THE KENTUCKY UTILITY PROTECTION SERVICE AND ALL OTHER UTILITIES THAT MAY HAVE UNDERGROUND UTILITIES INVOLVING THIS PROJECT AND ARE NON-MEMBERS OF KENTUCKY UNDERGROUND PROTECTION.

**STORM & SANITARY NOTES**

- 1. ALL STORM AND SANITARY ITEMS SHALL BE IN ACCORDANCE WITH THE LATEST SPECIFICATIONS AND DETAILS FROM SD1. CONCRETE AND METAL PIPE MATERIALS SHALL NOT BE USED UNLESS OTHERWISE SPECIFIED ON THESE PLANS.
- 2. CONTRACTOR SHALL BE REQUIRED TO MAINTAIN STORM AND SANITARY SEWER FLOW THROUGHOUT THE PROJECT, FOR THE DURATION OF CONSTRUCTION. ALL COST FOR THE ABOVE SHALL BE INCIDENTAL TO THE CONTRACT.
- 3. IF REQUIRED, CONTRACTOR SHALL BE RESPONSIBLE FOR CONTACTING AND SCHEDULING STORM AND SANITARY SEWER INSPECTIONS AS SET OUT IN THE PRECONSTRUCTION MEETING.
- 4. CONNECTIONS INTO EXISTING OR PROPOSED STORM OR SANITARY SEWER STRUCTURES OR PIPES SHALL BE COMPLETED BY A CERTIFIED TAPPER BY SD1.

**WATER NOTES**

- 1. ALL WORK RELATING TO WATER MAINS OR WATER SERVICE LINES SHALL BE COMPLETED IN ACCORDANCE WITH THE RULES AND REGULATIONS OF THE NORTHERN KENTUCKY WATER DISTRICT (NKWD).
- 2. CONTRACTOR MAY NOT USE WATER FROM FIRE HYDRANTS WITHOUT PRIOR PERMISSION FROM NKWD

**GAS NOTES**

- 1. ALL WORK RELATING TO GAS MAINS OR GAS SERVICE LINES SHALL BE COMPLETED IN ACCORDANCE WITH THE RULES AND REGULATIONS OF THE DUKE ENERGY

**ELECTRIC NOTES**

- 1. ALL WORK RELATING TO ELECTRIC LINES SHALL BE COMPLETED IN ACCORDANCE WITH THE RULES AND REGULATIONS OF THE DUKE ENERGY

**MAINTENANCE OF TRAFFIC NOTES**

- 1. ALL MAINTENANCE OF TRAFFIC PROCEDURES SHALL MEET THE REQUIREMENT OF THE MANUAL OF UNIFORM TRAFFIC CONTROL DEVICES AND SECTION 112 OF KTC STANDARD SPECIFICATIONS. THE CONTRACTOR SHALL MAINTAIN ACCESS TO LOCAL TRAFFIC (ACCESS TO RESIDENCES WITHIN CONSTRUCTION LIMITS) AT ALL TIMES. THE CONTRACTOR SHALL PROVIDE SUFFICIENT SIGN, WARNING LIGHTS, BARRICADES, OR OTHER NECESSARY DEVICES MAKE THE SITE SAFE TO THE TRAVELING PUBLIC.
- 2. IT SHALL BE THE CONTRACTOR'S RESPONSIBILITY TO SUBMIT TO THE ENGINEER AND THE OWNER A TRAFFIC CONTROL PLAN FOR THIS PROJECT.
- 3. PRIOR TO ANY CONSTRUCTION, THE CONTRACTOR SHALL NOTIFY THE CITY OF SOUTHGATE, AS WELL AS THEIR POLICE AND FIRE POLICE DEPARTMENTS. AT ALL TIMES, EMERGENCY VEHICLES SHALL BE GIVEN ACCESS.
- 4. RESIDENTS OF THE PROJECT AREA SHALL BE ALLOWED ACCESS TO THEIR PROPERTY AT ALL TIMES.
- 5. EACH DRIVEWAY SHALL BE ACCESSIBLE WHENEVER POSSIBLE. WHEN PORTLAND CEMENT CONCRETE CONSTRUCTION AFFECTS A DRIVEWAY, THE CONTRACTOR SHALL NOTIFY THE AFFECTED OWNERS 24 HOURS IN ADVANCE AND ADVISE THEM TO FIND ALTERNATIVE PARKING FOR A PERIOD OF AT LEAST 10 CALENDAR DAYS AFTER THE POUR. ALTERNATIVE PARKING SHALL INCLUDE "ON STREET" PARKING WITH ACCESS TO THE PROPERTY. TEMPORARY SIDEWALKS, ETC. WILL BE NECESSARY TO PREVENT PERSONS FROM WALKING IN MUD IN ORDER TO ENTER THEIR PROPERTY. TEMPORARY BRIDGES, RAILINGS ETC. WILL BECOME NECESSARY IN ORDER TO CROSS FORMED CURB LINES, EXCAVATED AREAS BEHIND CURB LINES AND WALKWAYS, ETC.
- 6. SOUTHGATE ELEMENTARY AND ST THERESE SCHOOLS HOURS ARE 8 AM TO 3 PM. CONTRACTOR SHALL COORDINATE WORK AND FACILITATE ACCESS TO AND FROM SCHOOLS.

**EROSION CONTROL LEGEND**

Table with 2 columns: Symbol and Description. Includes symbols for mill & overlay, public works asphalt, full depth pavement repair, full depth parking lot, 6" concrete driveway replacement, 4" concrete sidewalk, and concrete curb replacement.

**HATCH LEGEND**

Table with 2 columns: Hatch Pattern and Description. Includes patterns for mill & overlay, public works asphalt, full depth pavement repair, full depth parking lot, 6" concrete driveway replacement, 4" concrete sidewalk, and concrete curb replacement.

**SYMBOL LEGEND**

Table with 2 columns: Symbol and Description. Lists existing and proposed utilities including gas lines, electric, cable, telephone, water main, storm sewer, roof drain, sanitary sewer, fiber optics, fences, contours, right of way, easement, guardrail, and tree lines.

Table with 2 columns: Symbol and Description. Lists proposed utilities and structures including flagpoles, mailboxes, signs, cable pedestals, electric pedestals, pull boxes, ground lights, light poles, electric meters, manholes, gas meters, valves, boxes, utility poles, guy wires, sanitary manholes, cleanouts, curb inlets, catch basins, storm cleanouts, telephone manholes, pedestals, fire hydrants, water meters, valves, bushes/trees, survey benchmarks, and test boring locations.

Logo for 'your trusted advisor' with roles: engineers, architects, planners, consultants.

Table with columns: NO, REVISION, DATE, BID NO, ISSUED FOR, ISSUE DATE, SCALE, DESIGNED BY, DRAWN BY, CHECKED BY.

SOUTHGATE 2024 STREET PROGRAM  
CITY OF SOUTHGATE  
- CAMPBELL COUNTY, KY -  
NOTES & LEGEND

Table with columns: PROJECT NO., DISCIPLINE, SHEET NAME, SHEET, OF.

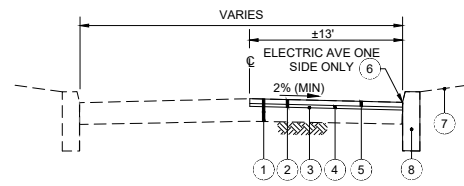

- 1 EXISTING ASPHALT PAVEMENT
- 2 ITEM 408 - ASPHALT MILLING (2.5" TYP.)
- 3 ITEM 406 - TACK COAT @ 0.1 GAL/SY (INCIDENTAL TO ITEM 403)
- 4 ITEM 402/403 - 1" ASPHALT LEVELING
- 5 ITEM 402/403 - 1-1/2" ASPHALT PAVEMENT SURFACE WITH ARAMID FIBER REINFORCEMENT (FORTA-FI OR ACE FIBER)
- 6 APPLY HOT ASPHALT SEALER WHERE ASPHALT MEETS CONCRETE CURB (INCIDENTAL TO ITEM 403)
- 7 ITEM SPL - YARD RESTORATION (KEEP TO A MINIMUM)
- 8 ITEM 506 - CURB REPLACEMENT, CONCRETE VERTICAL CURB PER DETAIL

**TYPICAL PAVEMENT RESURFACING SECTION  
(ELECTRIC AVENUE - RIDGEWAY TO WALNUT)**  
N.T.S.

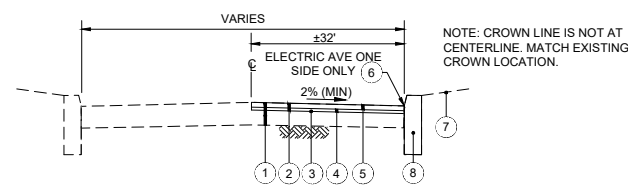

- 1 EXISTING ASPHALT PAVEMENT
- 2 ITEM 408 - ASPHALT MILLING (2.5" TYP.)
- 3 ITEM 406 - TACK COAT @ 0.1 GAL/SY (INCIDENTAL TO ITEM 403)
- 4 ITEM 402/403 - 1" ASPHALT LEVELING
- 5 ITEM 402/403 - 1-1/2" ASPHALT PAVEMENT SURFACE WITH ARAMID FIBER REINFORCEMENT (FORTA-FI OR ACE FIBER)
- 6 APPLY HOT ASPHALT SEALER WHERE ASPHALT MEETS CONCRETE CURB (INCIDENTAL TO ITEM 403)
- 7 ITEM SPL - YARD RESTORATION (KEEP TO A MINIMUM)
- 8 ITEM 506 - CURB REPLACEMENT, CONCRETE VERTICAL CURB PER DETAIL

**TYPICAL PAVEMENT RESURFACING SECTION  
(ELECTRIC AVENUE - WALNUT TO TEMPLE)**  
N.T.S.

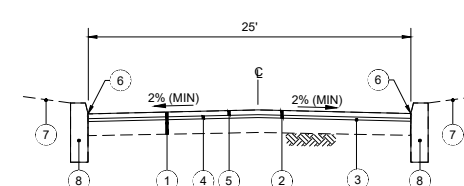

- 1 EXISTING ASPHALT PAVEMENT
- 2 ITEM 408 - ASPHALT MILLING (2.5" TYP.) (1" STA 40+10 TO STA 41+25)
- 3 ITEM 406 - TACK COAT @ 0.1 GAL/SY (INCIDENTAL TO ITEM 403)
- 4 ITEM 402/403 - 1" ASPHALT LEVELING
- 5 ITEM 402/403 - 1-1/2" ASPHALT PAVEMENT SURFACE WITH ARAMID FIBER REINFORCEMENT (FORTA-FI OR ACE FIBER)
- 6 APPLY HOT ASPHALT SEALER WHERE ASPHALT MEETS CONCRETE CURB (INCIDENTAL TO ITEM 403)
- 7 ITEM SPL - YARD RESTORATION (KEEP TO A MINIMUM)
- 8 ITEM 506 - CURB REPLACEMENT, CONCRETE VERTICAL CURB PER DETAIL

**TYPICAL PAVEMENT RESURFACING SECTION  
(BEECH ROAD)**  
N.T.S.

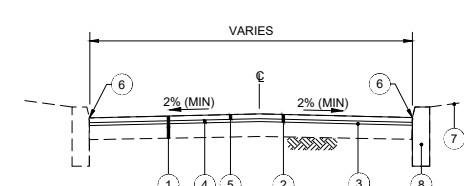

- 1 EXISTING ASPHALT PAVEMENT
- 2 ITEM 408 - ASPHALT MILLING (2.5" TYP.)
- 3 ITEM 406 - TACK COAT @ 0.1 GAL/SY (INCIDENTAL TO ITEM 403)
- 4 ITEM 402/403 - 1" ASPHALT LEVELING
- 5 ITEM 402/403 - 1-1/2" ASPHALT PAVEMENT SURFACE WITH ARAMID FIBER REINFORCEMENT (FORTA-FI OR ACE FIBER)
- 6 APPLY HOT ASPHALT SEALER WHERE ASPHALT MEETS CONCRETE CURB (INCIDENTAL TO ITEM 403)
- 7 ITEM SPL - YARD RESTORATION (KEEP TO A MINIMUM)
- 8 ITEM 506 - SPOT CURB REPLACEMENT, CONCRETE VERTICAL CURB PER DETAIL. LOCATIONS TO BE FIELD MARKED BY PUBLIC WORKS DIRECTOR OR ENGINEER.

**TYPICAL PAVEMENT RESURFACING SECTION  
(EVERGREEN AVENUE)**  
N.T.S.

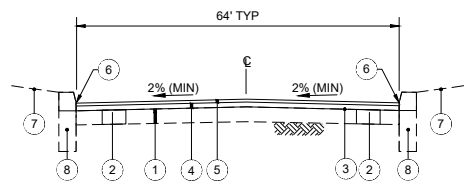

- 1 EXISTING ASPHALT PAVEMENT
- 2 FULL DEPTH REPAIRS (BY CITY PUBLIC WORKS)
- 3 ITEM 406 - TACK COAT @ 0.1 GAL/SY (INCIDENTAL TO ITEM 403)
- 4 ITEM 402/403 - 2-1/2" ASPHALT LEVELING
- 5 ITEM 402/403 - 1-1/2" ASPHALT PAVEMENT SURFACE WITH ARAMID FIBER REINFORCEMENT (FORTA-FI OR ACE FIBER)
- 6 APPLY HOT ASPHALT SEALER WHERE ASPHALT MEETS CONCRETE CURB (INCIDENTAL TO ITEM 403)
- 7 ITEM SPL - YARD RESTORATION (KEEP TO A MINIMUM)
- 8 ITEM SPL - REMOVE EXISTING CURB AND REPLACE WITH NEW EXTRUDED CURB

**TYPICAL PAVEMENT RESURFACING SECTION  
PUBLIC WORKS PARKING LOT**  
N.T.S.

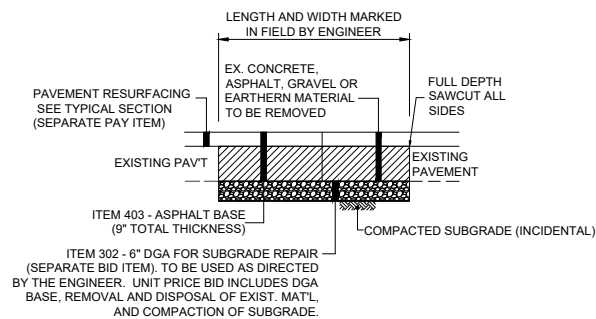

**FULL DEPTH PAVEMENT REPAIR (ASPHALT)**  
N.T.S.

\* NOTE: THIS IS A CONTINGENCY ITEM TO BE USED ONLY AT THE DIRECTION OF THE ENGINEER LIMITS TO BE MARKED IN THE FIELD BY THE ENGINEER.

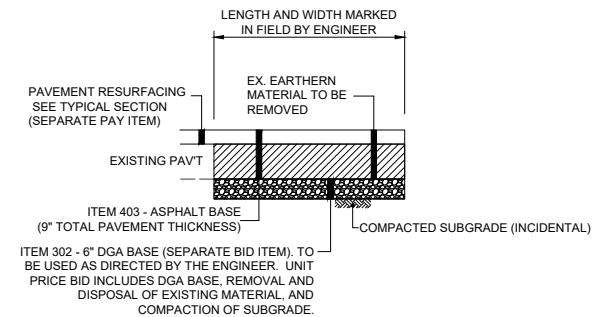

**FULL DEPTH ASPHALT PARKING LOT EXPANSION**  
N.T.S.

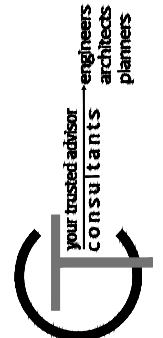

NO	REVISION	DATE

ISSUED FOR: 02/22/2024  
 ISSUE DATE: AS SHOWN  
 SCALE: RSEI  
 DESIGNED BY: RSEI  
 DRAWN BY: RSEI  
 CHECKED BY: JSJU

PROJECT NO. <b>241022</b>	
DISCIPLINE <b>CIVIL</b>	
SHEET NAME <b>DTL-01</b>	
SHEET <b>3</b>	OF <b>10</b>

**SOUTHGATE 2024 STREET  
PROGRAM  
CITY OF SOUTHGATE  
- CAMPBELL COUNTY, KY -  
DETAIL SHEET 1**

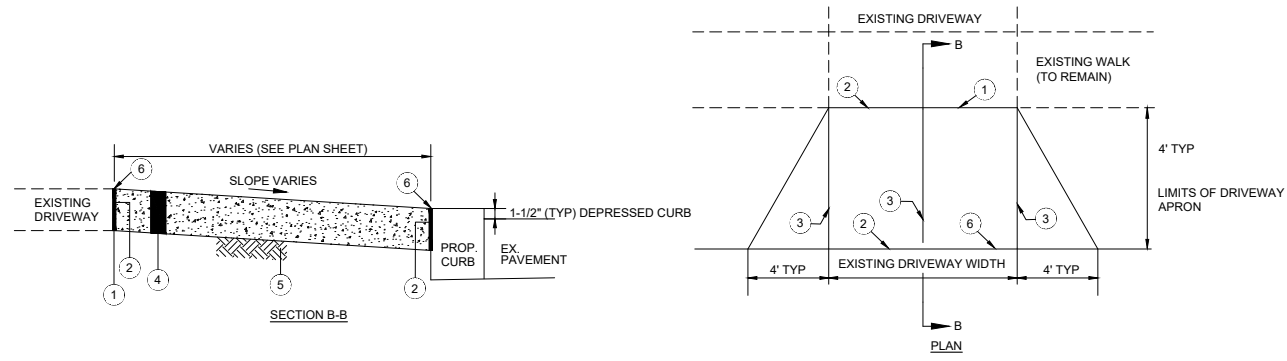

- 1 SAWCUT AT NEAREST JOINT AND REMOVE EXISTING CONCRETE PAVEMENT (INCIDENTAL TO ITEM SPL)
- 2 1" PREFORMED EXPANSION JOINT MATERIAL (FLEXIBLE FOAM-CERAMAR BY W.R. MEADOWS OR APPROVED EQUAL) - INCIDENTAL TO DRIVEWAY REPLACEMENT
- 3 TOOLED JOINT
- 4 ITEM SPL - 6" CONCRETE DRIVEWAY/APRON (PER CAMPBELL COUNTY SUBDIVISION REGULATIONS)
- 5 ITEM 207 - COMPACTED SUBGRADE (INCIDENTAL TO ITEM SPL - 6" CONCRETE DRIVEWAY/APRON)
- 6 SEAL JOINT WITH GRAY SELF LEVELING SEALANT (SIKA FLEX OR APPROVED EQUAL)

**CONCRETE DRIVEWAY REPLACEMENT (WITH SIDEWALK)**  
N.T.S.

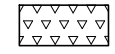

- NOTE:
1. ANY YARD AREA DISTURBED BY THE CONSTRUCTION OF THE DRIVEWAY APRON SHALL BE RESTORED WITH TOPSOIL, SEED AND MULCH (INCIDENTAL TO CONCRETE DRIVEWAY APRON REPLACEMENT).
  2. ALL EXCAVATION REQUIRED FOR THE PLACEMENT OF THE PROPOSED DRIVEWAY SHALL BE INCIDENTAL TO CONCRETE DRIVEWAY REPLACEMENT BID ITEM.
  3. CURB HEIGHT SHALL BE TAPERED FROM 6" TO 1-1/2" IN THE 4' WIDE DRIVEWAY FLARES.

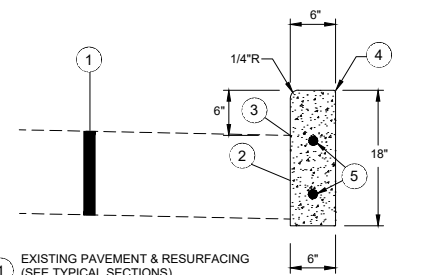

- 1 EXISTING PAVEMENT & RESURFACING (SEE TYPICAL SECTIONS)
- 2 SAWCUT & REMOVE EXISTING CURB
- 3 APPLY HOT ASPHALT SEALER WHERE ASPHALT MEETS CURB (INCIDENTAL TO ITEM 402)
- 4 TOP OF REPLACEMENT CURB TO MATCH LINE & GRADE OF EXIST. CURB. ADJUSTMENT TO THE ELEVATION AND LOCATION OF THE CURB SHALL BE ADJUSTED TO REMOVE DIPS IN THE CURB LINE.
- 5 1/2" DIA. DOWELS 18" LONG - DRILL 9" MIN. INTO EXIST. CURB

NOTE: CONTRACTOR SHALL FILL BEHIND CURB TO THE TOP OF THE CURB w/ TOPSOIL AND RESTORE YARD w/ SEED/MULCH. THE COST FOR TOPSOIL, SEED/MULCH SHALL BE INCIDENTAL TO THE UNIT PRICE BID FOR CURB REPLACEMENT.

CONCRETE SHALL BE PER THE LATEST EDITION OF THE CAMPBELL COUNTY SUBDIVISION REGULATIONS

**6" VERTICAL CURB REPLACEMENT** N.T.S.

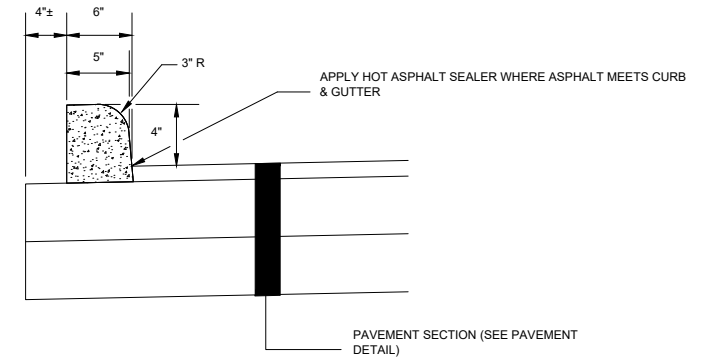

- NOTE:
1. CONCRETE CURB TO BE PERMANENTLY BONDED TO BITUMINOUS CONC. BASE USING 2-PART CONCRETE EPOXY.
  2. CONCRETE SHALL BE PER THE LATEST EDITION OF THE CAMPBELL COUNTY SUBDIVISION REGULATIONS

**CONC. EXTRUDED CURB DETAIL** N.T.S.  
**(PUBLIC WORKS PARKING LOT)**

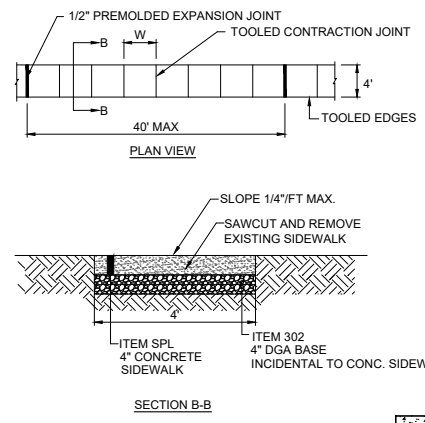

**CONCRETE SIDEWALK REPLACEMENT DETAIL**

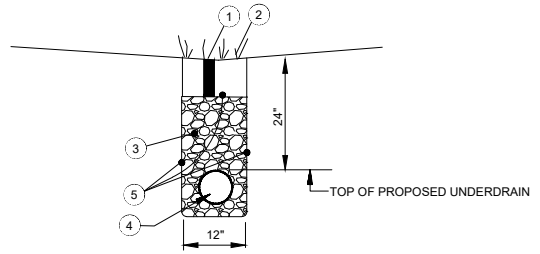

- 1 ITEM 212 - 6" TOPSOIL
- 2 ITEM 212 - SEED AND MULCH
- 3 CLEAN NO. 57 CRUSHED STONE (LESS THAN 3% FINES). PLACED AND COMPACTED UP TO 2" ABOVE BOTTOM OF CURB.
- 4 ITEM 705 - 4" RIGID PERFORATED PVC PIPE UNDERDRAIN (PERFORATIONS DOWN - 1% MIN. SLOPE)
- 5 MIRAFIB® 140N OR EQUIVALENT NON WOVEN DRAINAGE GEOTEXTILE - CONSTRUCT AROUND BOTTOM AND SIDES OF TRENCH, ALSO LAPPED OVER TOP OF STONE BACKFILL.

**UNDERDRAIN DETAIL (OUTSIDE OF PAVEMENT)**  
N.T.S.

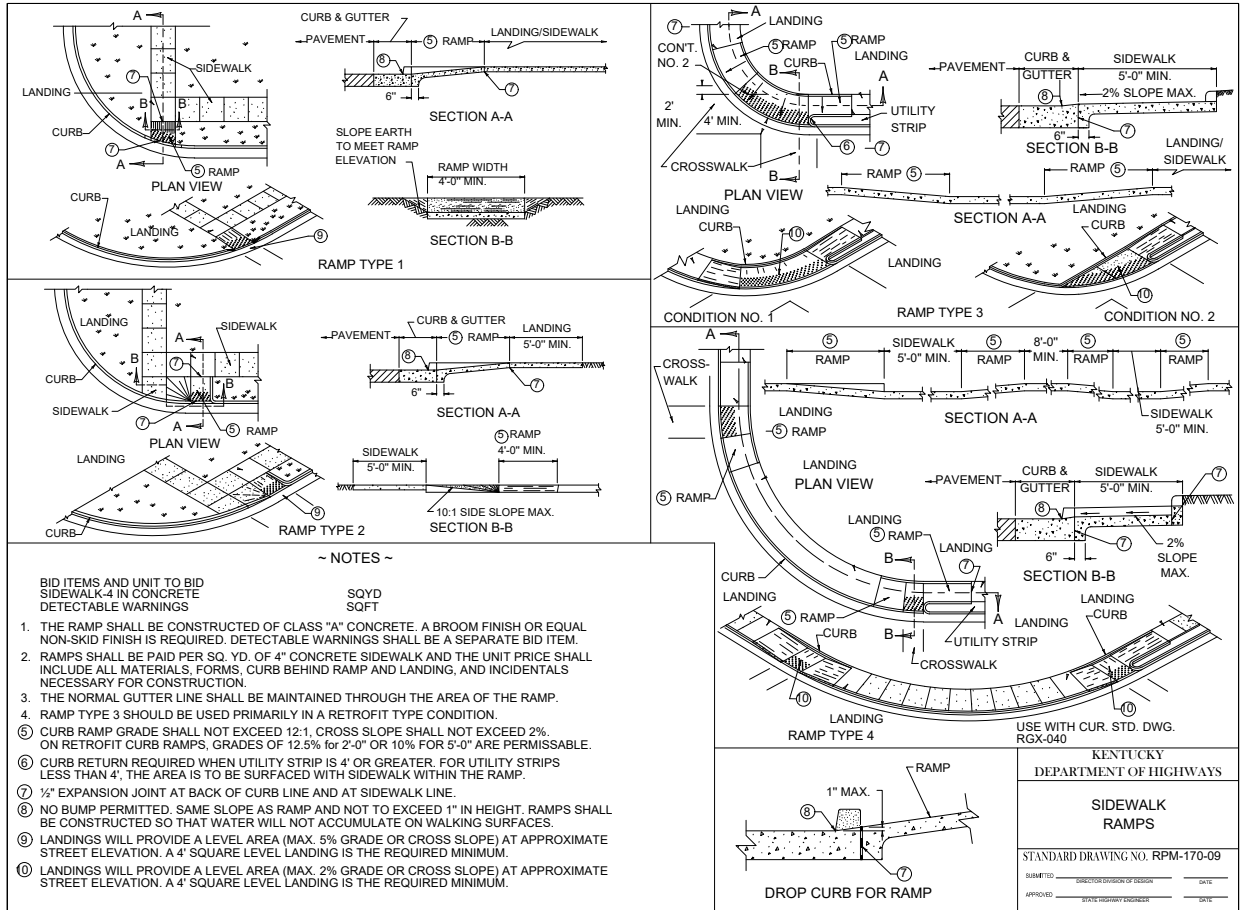

- BID ITEMS AND UNIT TO BID  
SIDEWALK-4 IN CONCRETE  
DETECTABLE WARNINGS SQYD  
SOFT
1. THE RAMP SHALL BE CONSTRUCTED OF CLASS "A" CONCRETE. A BROOM FINISH OR EQUAL NON-SKID FINISH IS REQUIRED. DETECTABLE WARNINGS SHALL BE A SEPARATE BID ITEM.
  2. RAMP TYPE 3 SHOULD BE USED PRIMARILY IN A RETROFIT TYPE CONDITION.
  3. THE NORMAL GUTTER LINE SHALL BE MAINTAINED THROUGH THE AREA OF THE RAMP.
  4. CURB RAMP GRADE SHALL NOT EXCEED 1:21. CROSS SLOPE SHALL NOT EXCEED 2% ON RETROFIT CURB RAMP. GRADES OF 12.5% FOR 2'-0" OR 10% FOR 5'-0" ARE PERMISSIBLE.
  5. CURB RETURN REQUIRED WHEN UTILITY STRIP IS 4' OR GREATER. FOR UTILITY STRIPS LESS THAN 4', THE AREA IS TO BE SURFACED WITH SIDEWALK WITHIN THE RAMP.
  6. 1/2" EXPANSION JOINT AT BACK OF CURB LINE AND AT SIDEWALK LINE.
  7. NO BUMP PERMITTED. SAME SLOPE AS RAMP AND NOT TO EXCEED 1" IN HEIGHT. RAMP SHALL BE CONSTRUCTED SO THAT WATER WILL NOT ACCUMULATE ON WALKING SURFACES.
  8. LANDINGS WILL PROVIDE A LEVEL AREA (MAX. 5% GRADE OR CROSS SLOPE) AT APPROXIMATE STREET ELEVATION. A 4' SQUARE LEVEL LANDING IS THE REQUIRED MINIMUM.
  9. LANDINGS WILL PROVIDE A LEVEL AREA (MAX. 2% GRADE OR CROSS SLOPE) AT APPROXIMATE STREET ELEVATION. A 4' SQUARE LEVEL LANDING IS THE REQUIRED MINIMUM.

KENTUCKY  
DEPARTMENT OF HIGHWAYS

SIDEWALK  
RAMPS

STANDARD DRAWING NO. RPM-170-09

SUBMITTED: \_\_\_\_\_ DATE: \_\_\_\_\_  
APPROVED: \_\_\_\_\_ DATE: \_\_\_\_\_

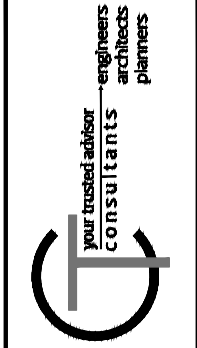

ISSUED FOR:	BID NO.	REVISION	DATE
ISSUE DATE: 02/22/2024			
SCALE: AS SHOWN			
DESIGNED BY: RSEI			
DRAWN BY: RSEI			
CHECKED BY: JSJU			

**SOUTHGATE 2024 STREET PROGRAM**  
CITY OF SOUTHGATE  
- CAMPBELL COUNTY, KY -  
**DETAIL SHEET 2**

PROJECT NO.	241022
DISCIPLINE	CIVIL
SHEET NAME	DTL-02
SHEET	4
OF	10

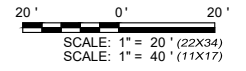
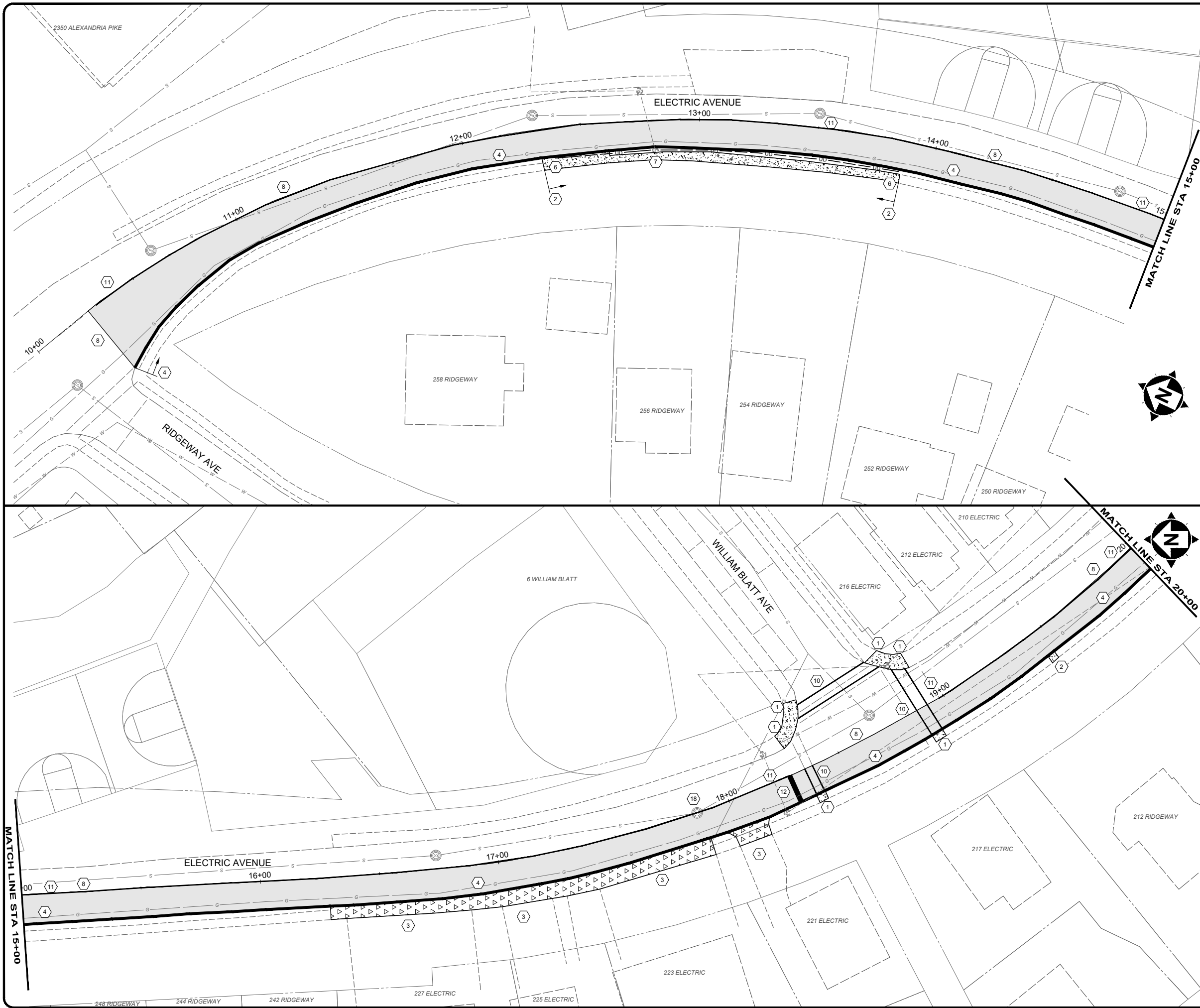

**CONSTRUCTION NOTES**

- 1 INSTALL PROPOSED ADA CURB RAMP
- 2 SIDEWALK REPLACEMENT LIMITS WILL MARKED IN THE FIELD BY THE PUBLIC WORKS DIRECTOR OR ENGINEER.
- 3 DRIVEWAY REPLACEMENT LIMITS WILL MARKED IN THE FIELD BY THE PUBLIC WORKS DIRECTOR OR ENGINEER.
- 4 CURB REPLACEMENT LIMITS WILL MARKED IN THE FIELD BY THE PUBLIC WORKS DIRECTOR OR ENGINEER.
- 5 ADJUST STORM SEWER CASTING
- 6 UNDERDRAIN TO BE INSTALLED WITHIN GRASS STRIP.
- 7 CONNECT PROPOSED UNDERDRAIN TO STORM STRUCTURE
- 8 MATCH EXISTING PAVEMENT
- 9 PAVEMENT MARKING - PARKING LINES
- 10 PAVEMENT MARKING - CROSSWALK
- 11 PAVEMENT MARKING - YELLOW CENTER LINE
- 12 PAVEMENT MARKING - STOP BAR
- 13 PAVEMENT MARKING - BASKETBALL
- 14 DO NOT DISTURB DECORATIVE CONCRETE SIDEWALK
- 15 SIDEWALK ELEVATION TO BE LOWERED AS NEEDED (MAX. 2") TO IMPROVE DRIVEWAY PROFILES CONTRACTOR TO COORDINATE FINAL GRADE WITH PUBLIC WORKS DIRECTOR OR ENGINEER.
- 16 REMOVE CONCRETE BETWEEN CURB AND SIDEWALK AND RESTORE GRASS STRIP.
- 17 CURB TO BE BUMPED OUT BEHIND BASKETBALL HOOP
- 18 ADJUST MANHOLE FRAME AND GRATE TO FINISHED GRADE PER SD1 REQUIREMENTS
- 19 LEAVE 2" WIDE OPENING IN CURB AND GRADE DITCH TO DIRECT WATER TO CATCH BASIN.

**HATCH LEGEND**

- MILL & OVERLAY  
- SEE TYPICAL SECTIONS
- PUBLIC WORKS ASPHALT PARKING LOT EXPANSION  
- SEE DETAIL SHEET
- FULL DEPTH PAVEMENT REPAIR
- FULL DEPTH PARKING LOT PAVEMENT REPAIRS (WORK DONE BY CITY)
- 6" CONCRETE DRIVEWAY REPLACEMENT  
- SEE DETAIL SHEET
- 4" CONCRETE SIDEWALK  
- SEE DETAIL SHEET
- CONCRETE CURB REPLACEMENT  
- SEE DETAIL SHEET

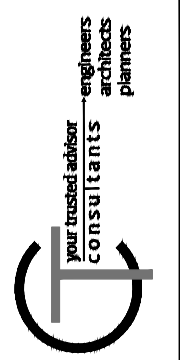

ISSUED FOR:	BID NO.	REVISION	DATE
ISSUE DATE: 02/22/2024			
SCALE: AS SHOWN			
DESIGNED BY: RSEI			
DRAWN BY: RSEI			
CHECKED BY: JSJU			

**SOUTHGATE 2024 STREET PROGRAM**  
CITY OF SOUTHGATE  
- CAMPBELL COUNTY, KY -  
**PLAN SHEET 1 - ELECTRIC AVE STA 10+00 TO 20+00**

PROJECT NO.	241022
DISCIPLINE	CIVIL
SHEET NAME	PLAN-01
SHEET	OF
5	10

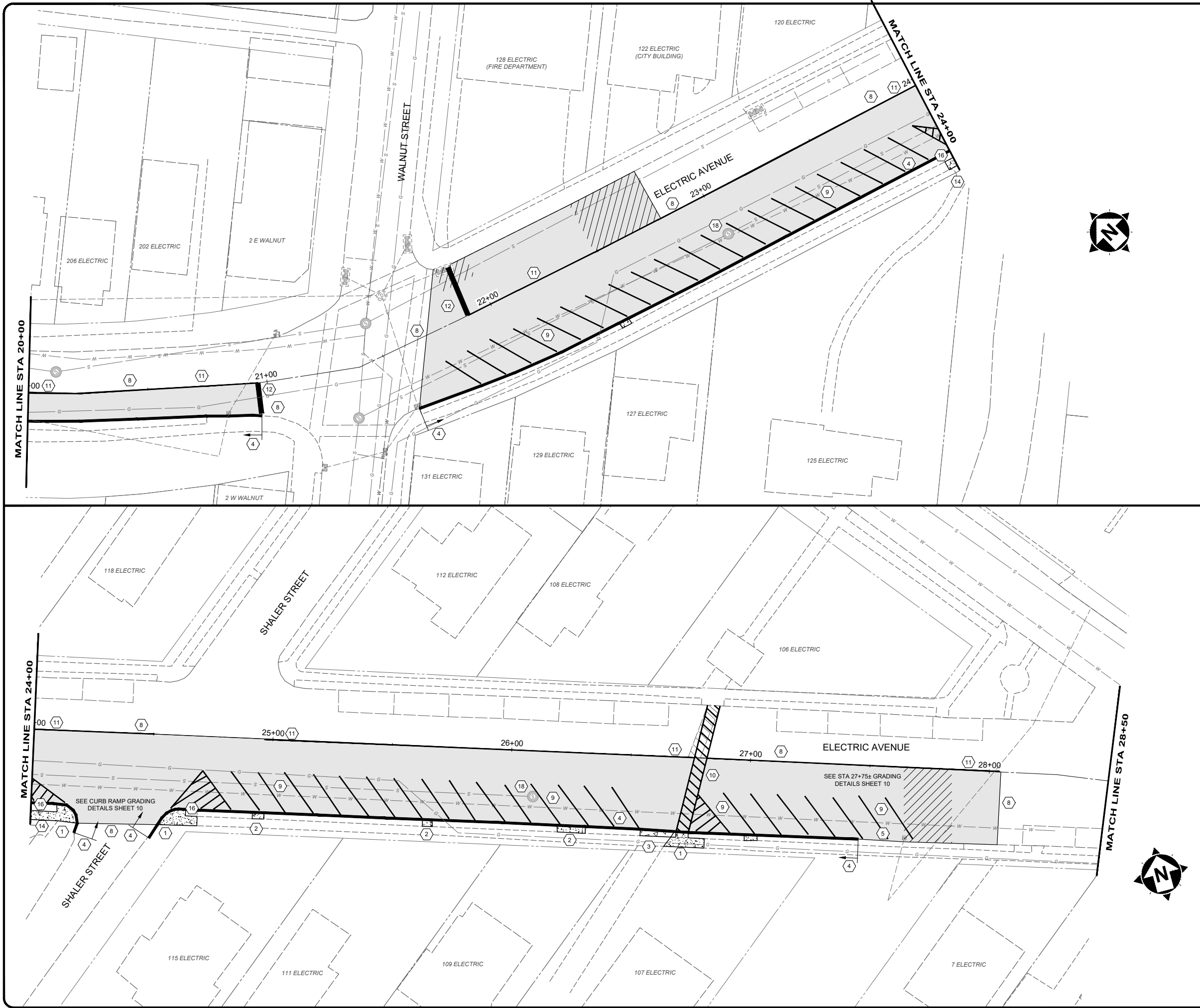

20' 0' 20'  
 SCALE: 1" = 20' (22X34)  
 SCALE: 1" = 40' (11X17)



**CONSTRUCTION NOTES**

- 1 INSTALL PROPOSED ADA CURB RAMP
- 2 SIDEWALK REPLACEMENT LIMITS WILL MARKED IN THE FIELD BY THE PUBLIC WORKS DIRECTOR OR ENGINEER.
- 3 DRIVEWAY REPLACEMENT LIMITS WILL MARKED IN THE FIELD BY THE PUBLIC WORKS DIRECTOR OR ENGINEER.
- 4 CURB REPLACEMENT LIMITS WILL MARKED IN THE FIELD BY THE PUBLIC WORKS DIRECTOR OR ENGINEER.
- 5 ADJUST STORM SEWER CASTING
- 6 UNDERDRAIN TO BE INSTALLED WITHIN GRASS STRIP.
- 7 CONNECT PROPOSED UNDERDRAIN TO STORM STRUCTURE
- 8 MATCH EXISTING PAVEMENT
- 9 PAVEMENT MARKING - PARKING LINES
- 10 PAVEMENT MARKING - CROSSWALK
- 11 PAVEMENT MARKING - YELLOW CENTER LINE
- 12 PAVEMENT MARKING - STOP BAR
- 13 PAVEMENT MARKING - BASKETBALL
- 14 DO NOT DISTURB DECORATIVE CONCRETE SIDEWALK
- 15 SIDEWALK ELEVATION TO BE LOWERED AS NEEDED (MAX. 2') TO IMPROVE DRIVEWAY PROFILES CONTRACTOR TO COORDINATE FINAL GRADE WITH PUBLIC WORKS DIRECTOR OR ENGINEER.
- 16 REMOVE CONCRETE BETWEEN CURB AND SIDEWALK AND RESTORE GRASS STRIP.
- 17 CURB TO BE BUMPED OUT BEHIND BASKETBALL HOOP
- 18 ADJUST MANHOLE FRAME AND GRATE TO FINISHED GRADE PER SD1 REQUIREMENTS
- 19 LEAVE 2' WIDE OPENING IN CURB AND GRADE DITCH TO DIRECT WATER TO CATCH BASIN.

**HATCH LEGEND**

- MILL & OVERLAY  
- SEE TYPICAL SECTIONS
- PUBLIC WORKS ASPHALT PARKING LOT EXPANSION  
- SEE DETAIL SHEET
- FULL DEPTH PAVEMENT REPAIR
- FULL DEPTH PARKING LOT PAVEMENT REPAIRS (WORK DONE BY CITY)
- 6" CONCRETE DRIVEWAY REPLACEMENT  
- SEE DETAIL SHEET
- 4" CONCRETE SIDEWALK  
- SEE DETAIL SHEET
- CONCRETE CURB REPLACEMENT  
- SEE DETAIL SHEET

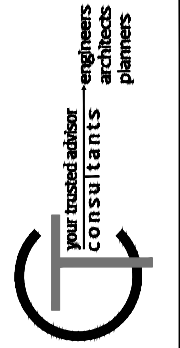

ISSUED FOR:	BID NO.	REVISION	DATE
ISSUE DATE: 02/22/2024			
SCALE: AS SHOWN			
DESIGNED BY: RSEI			
DRAWN BY: RSEI			
CHECKED BY: JSJU			

**SOUTHGATE 2024 STREET PROGRAM**  
 CITY OF SOUTHGATE  
 - CAMPBELL COUNTY, KY -  
**PLAN SHEET 2 - ELECTRIC AVE STA 20+00 TO 28+50**

PROJECT NO.	241022
DISCIPLINE	CIVIL
SHEET NAME	PLAN-02
SHEET	6
OF	10

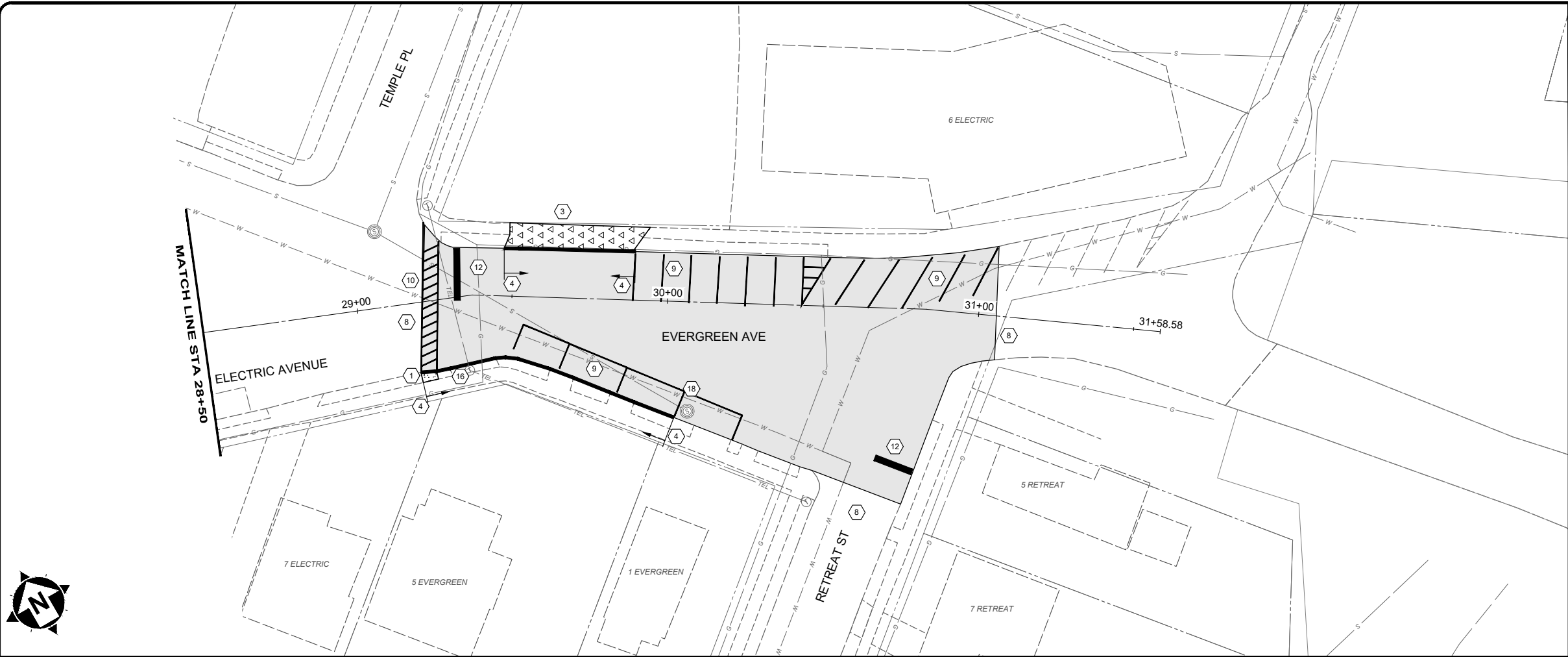

20' 0' 20'  
 SCALE: 1" = 20' (22X34)  
 SCALE: 1" = 40' (11X17)

**CONSTRUCTION NOTES**

- 1 INSTALL PROPOSED ADA CURB RAMP
- 2 SIDEWALK REPLACEMENT LIMITS WILL MARKED IN THE FIELD BY THE PUBLIC WORKS DIRECTOR OR ENGINEER.
- 3 DRIVEWAY REPLACEMENT LIMITS WILL MARKED IN THE FIELD BY THE PUBLIC WORKS DIRECTOR OR ENGINEER.
- 4 CURB REPLACEMENT LIMITS WILL MARKED IN THE FIELD BY THE PUBLIC WORKS DIRECTOR OR ENGINEER.
- 5 ADJUST STORM SEWER CASTING
- 6 UNDERDRAIN TO BE INSTALLED WITHIN GRASS STRIP.
- 7 CONNECT PROPOSED UNDERDRAIN TO STORM STRUCTURE
- 8 MATCH EXISTING PAVEMENT
- 9 PAVEMENT MARKING - PARKING LINES
- 10 PAVEMENT MARKING - CROSSWALK
- 11 PAVEMENT MARKING - YELLOW CENTER LINE
- 12 PAVEMENT MARKING - STOP BAR
- 13 PAVEMENT MARKING - BASKETBALL
- 14 DO NOT DISTURB DECORATIVE CONCRETE SIDEWALK
- 15 SIDEWALK ELEVATION TO BE LOWERED AS NEEDED (MAX. 2") TO IMPROVE DRIVEWAY PROFILES CONTRACTOR TO COORDINATE FINAL GRADE WITH PUBLIC WORKS DIRECTOR OR ENGINEER.
- 16 REMOVE CONCRETE BETWEEN CURB AND SIDEWALK AND RESTORE GRASS STRIP.
- 17 CURB TO BE BUMPED OUT BEHIND BASKETBALL HOOP
- 18 ADJUST MANHOLE FRAME AND GRATE TO FINISHED GRADE PER SD1 REQUIREMENTS
- 19 LEAVE 2" WIDE OPENING IN CURB AND GRADE DITCH TO DIRECT WATER TO CATCH BASIN.

**HATCH LEGEND**

- MILL & OVERLAY  
- SEE TYPICAL SECTIONS
- PUBLIC WORKS ASPHALT  
PARKING LOT EXPANSION  
- SEE DETAIL SHEET
- FULL DEPTH PAVEMENT REPAIR
- FULL DEPTH PARKING LOT  
PAVEMENT REPAIRS (WORK  
DONE BY CITY)
- 6" CONCRETE DRIVEWAY  
REPLACEMENT  
- SEE DETAIL SHEET
- 4" CONCRETE SIDEWALK  
- SEE DETAIL SHEET
- CONCRETE CURB  
REPLACEMENT  
- SEE DETAIL SHEET



ISSUED FOR:	BID NO.	REVISION	DATE
ISSUE DATE: 02/22/2024			
SCALE: AS SHOWN			
DESIGNED BY: RSEI			
DRAWN BY: RSEI			
CHECKED BY: JSJU			

**SOUTHGATE 2024 STREET PROGRAM**  
 CITY OF SOUTHGATE  
 - CAMPBELL COUNTY, KY -  
**PLAN SHEET 3 - EVERGREEN AVE**  
**STA 28+50 TO 32+00**

PROJECT NO.	241022
DISCIPLINE	CIVIL
SHEET NAME	PLAN-03
SHEET	7
OF	10

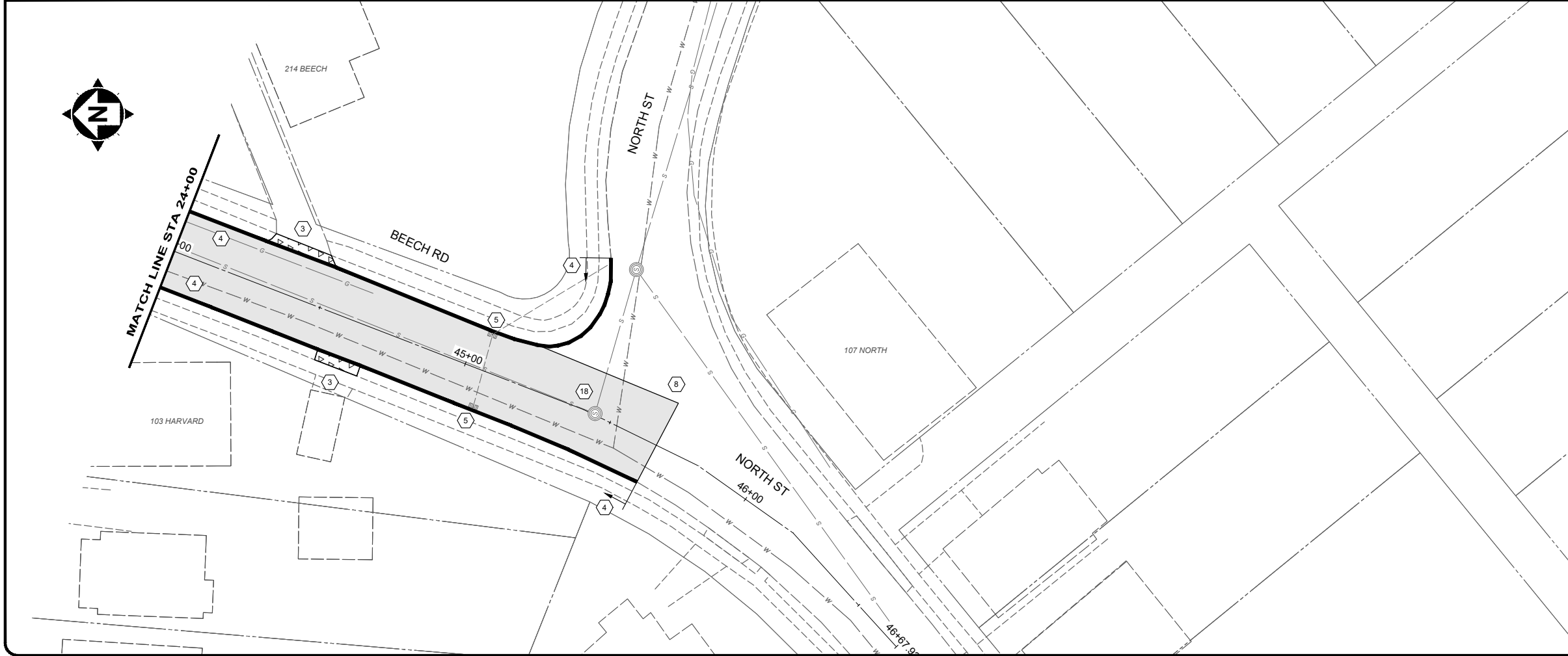
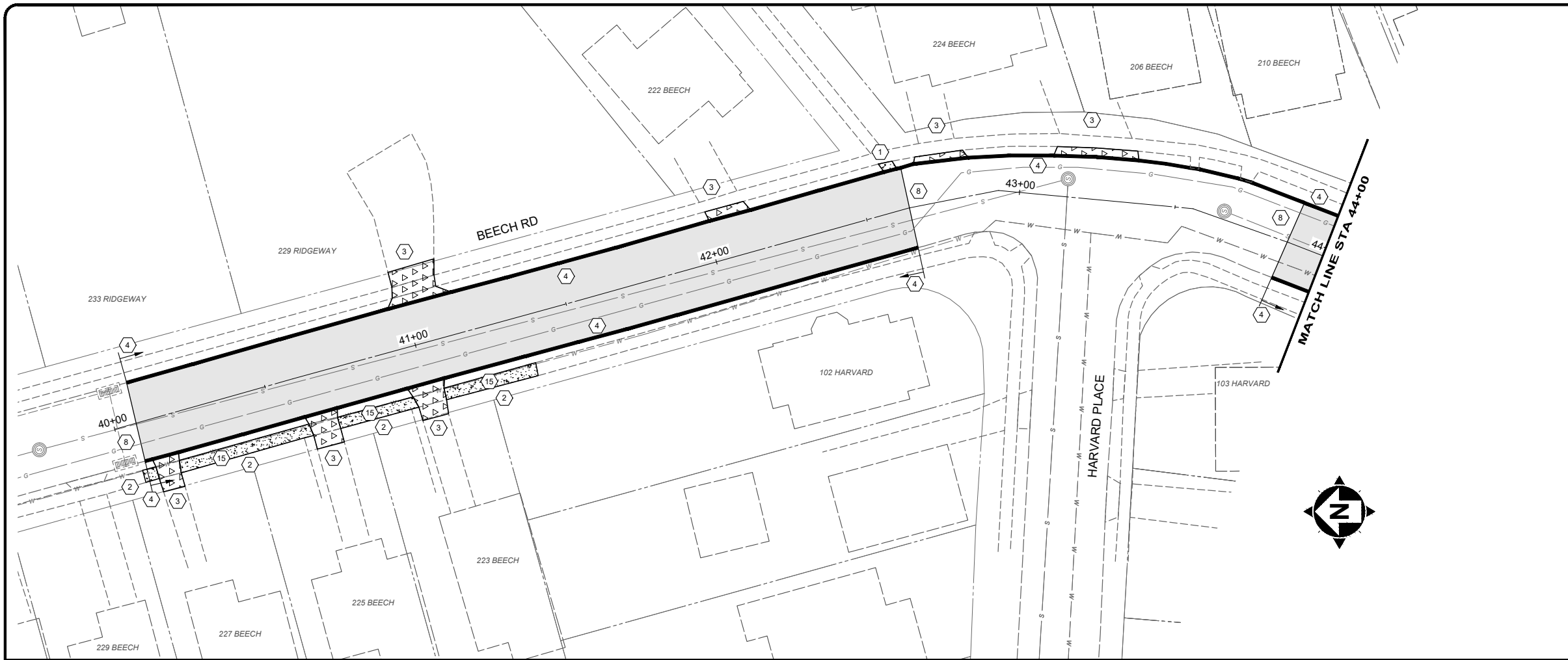

20' 0' 20'  
 SCALE: 1" = 20' (22X34)  
 SCALE: 1" = 40' (11X17)

**CONSTRUCTION NOTES**

- 1 INSTALL PROPOSED ADA CURB RAMP
- 2 SIDEWALK REPLACEMENT LIMITS WILL MARKED IN THE FIELD BY THE PUBLIC WORKS DIRECTOR OR ENGINEER.
- 3 DRIVEWAY REPLACEMENT LIMITS WILL MARKED IN THE FIELD BY THE PUBLIC WORKS DIRECTOR OR ENGINEER.
- 4 CURB REPLACEMENT LIMITS WILL MARKED IN THE FIELD BY THE PUBLIC WORKS DIRECTOR OR ENGINEER.
- 5 ADJUST STORM SEWER CASTING
- 6 UNDERDRAIN TO BE INSTALLED WITHIN GRASS STRIP.
- 7 CONNECT PROPOSED UNDERDRAIN TO STORM STRUCTURE
- 8 MATCH EXISTING PAVEMENT
- 9 PAVEMENT MARKING - PARKING LINES
- 10 PAVEMENT MARKING - CROSSWALK
- 11 PAVEMENT MARKING - YELLOW CENTER LINE
- 12 PAVEMENT MARKING - STOP BAR
- 13 PAVEMENT MARKING - BASKETBALL
- 14 DO NOT DISTURB DECORATIVE CONCRETE SIDEWALK
- 15 SIDEWALK ELEVATION TO BE LOWERED AS NEEDED (MAX. 2") TO IMPROVE DRIVEWAY PROFILES CONTRACTOR TO COORDINATE FINAL GRADE WITH PUBLIC WORKS DIRECTOR OR ENGINEER.
- 16 REMOVE CONCRETE BETWEEN CURB AND SIDEWALK AND RESTORE GRASS STRIP.
- 17 CURB TO BE BUMPED OUT BEHIND BASKETBALL HOOP
- 18 ADJUST MANHOLE FRAME AND GRATE TO FINISHED GRADE PER SD1 REQUIREMENTS
- 19 LEAVE 2" WIDE OPENING IN CURB AND GRADE DITCH TO DIRECT WATER TO CATCH BASIN.

**HATCH LEGEND**

- MILL & OVERLAY  
- SEE TYPICAL SECTIONS
- PUBLIC WORKS ASPHALT PARKING LOT EXPANSION  
- SEE DETAIL SHEET
- FULL DEPTH PAVEMENT REPAIR
- FULL DEPTH PARKING LOT PAVEMENT REPAIRS (WORK DONE BY CITY)
- 6" CONCRETE DRIVEWAY REPLACEMENT  
- SEE DETAIL SHEET
- 4" CONCRETE SIDEWALK REPLACEMENT  
- SEE DETAIL SHEET
- CONCRETE CURB REPLACEMENT  
- SEE DETAIL SHEET

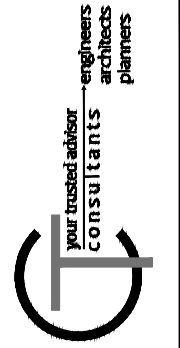

ISSUED FOR:	BID NO.	REVISION	DATE
ISSUE DATE:	02222024		
SCALE:	AS SHOWN		
DESIGNED BY:	RSEI		
DRAWN BY:	RSEI		
CHECKED BY:	JSHU		

**SOUTHGATE 2024 STREET PROGRAM**  
 CITY OF SOUTHGATE  
 - CAMPBELL COUNTY, KY.  
**PLAN SHEET 4 - BEECH RD STA 40+00 TO 46+00**

PROJECT NO.	241022
DISCIPLINE	CIVIL
SHEET NAME	PLAN-04
SHEET	8
OF	10

H:\2024\1022\DWG\BASE\241022 - P-BASE.DWG - PLAN-04 - 202404 3 08 44 PM - ROBERT BETZINGER



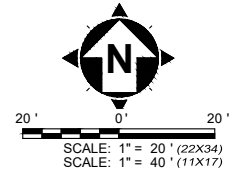
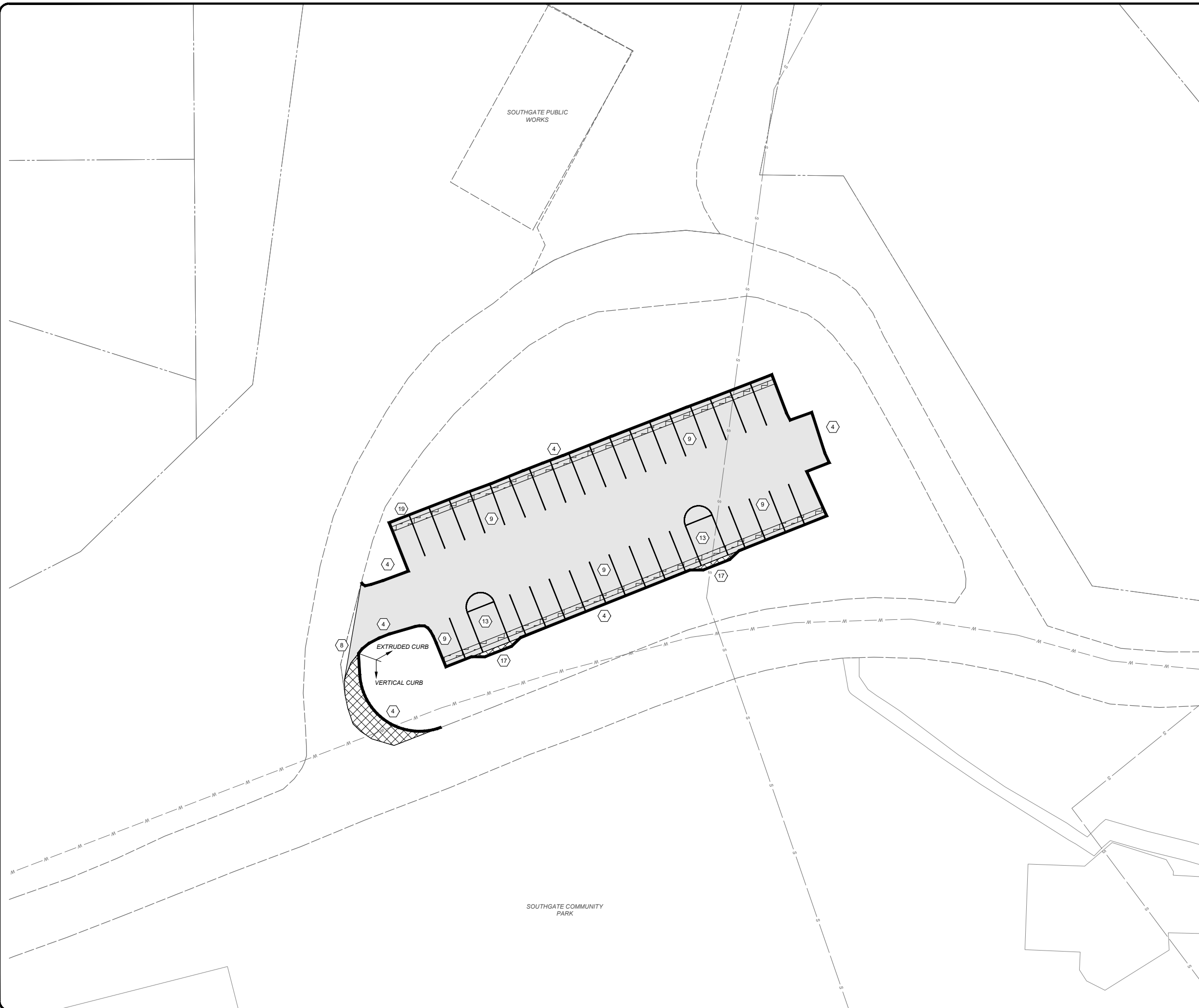

**CONSTRUCTION NOTES**

- 1 INSTALL PROPOSED ADA CURB RAMP
- 2 SIDEWALK REPLACEMENT LIMITS WILL MARKED IN THE FIELD BY THE PUBLIC WORKS DIRECTOR OR ENGINEER.
- 3 DRIVEWAY REPLACEMENT LIMITS WILL MARKED IN THE FIELD BY THE PUBLIC WORKS DIRECTOR OR ENGINEER.
- 4 CURB REPLACEMENT LIMITS WILL MARKED IN THE FIELD BY THE PUBLIC WORKS DIRECTOR OR ENGINEER.
- 5 ADJUST STORM SEWER CASTING
- 6 UNDERDRAIN TO BE INSTALLED WITHIN GRASS STRIP.
- 7 CONNECT PROPOSED UNDERDRAIN TO STORM STRUCTURE
- 8 MATCH EXISTING PAVEMENT
- 9 PAVEMENT MARKING - PARKING LINES
- 10 PAVEMENT MARKING - CROSSWALK
- 11 PAVEMENT MARKING - YELLOW CENTER LINE
- 12 PAVEMENT MARKING - STOP BAR
- 13 PAVEMENT MARKING - BASKETBALL
- 14 DO NOT DISTURB DECORATIVE CONCRETE SIDEWALK
- 15 SIDEWALK ELEVATION TO BE LOWERED AS NEEDED (MAX. 2') TO IMPROVE DRIVEWAY PROFILES CONTRACTOR TO COORDINATE FINAL GRADE WITH PUBLIC WORKS DIRECTOR OR ENGINEER.
- 16 REMOVE CONCRETE BETWEEN CURB AND SIDEWALK AND RESTORE GRASS STRIP.
- 17 CURB TO BE BUMPED OUT BEHIND BASKETBALL HOOP
- 18 ADJUST MANHOLE FRAME AND GRATE TO FINISHED GRADE PER SD1 REQUIREMENTS
- 19 LEAVE 2' WIDE OPENING IN CURB AND GRADE DITCH TO DIRECT WATER TO CATCH BASIN.

**HATCH LEGEND**

- MILL & OVERLAY  
- SEE TYPICAL SECTIONS
- PUBLIC WORKS ASPHALT  
PARKING LOT EXPANSION  
- SEE DETAIL SHEET
- FULL DEPTH PAVEMENT REPAIR
- FULL DEPTH PARKING LOT  
PAVEMENT REPAIRS (WORK  
DONE BY CITY)
- 6" CONCRETE DRIVEWAY  
REPLACEMENT  
- SEE DETAIL SHEET
- 4" CONCRETE SIDEWALK  
- SEE DETAIL SHEET
- CONCRETE CURB  
REPLACEMENT  
- SEE DETAIL SHEET

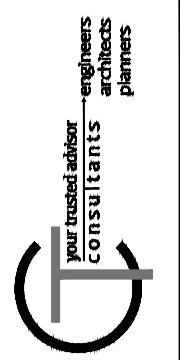

ISSUED FOR:	BID NO.	REVISION	DATE
ISSUE DATE: 02/22/2024			
SCALE: AS SHOWN			
DESIGNED BY: RSEI			
DRAWN BY: RSEI			
CHECKED BY: JSJU			

**SOUTHGATE 2024 STREET  
PROGRAM  
CITY OF SOUTHGATE  
- CAMPBELL COUNTY, KY -  
PLAN SHEET 5 - PUBLIC WORKS  
PARKING LOT**

PROJECT NO. <b>241022</b>	
DISCIPLINE <b>CIVIL</b>	
SHEET NAME <b>PLAN-05</b>	
SHEET <b>9</b>	OF <b>10</b>

SHALER ADA RAMP

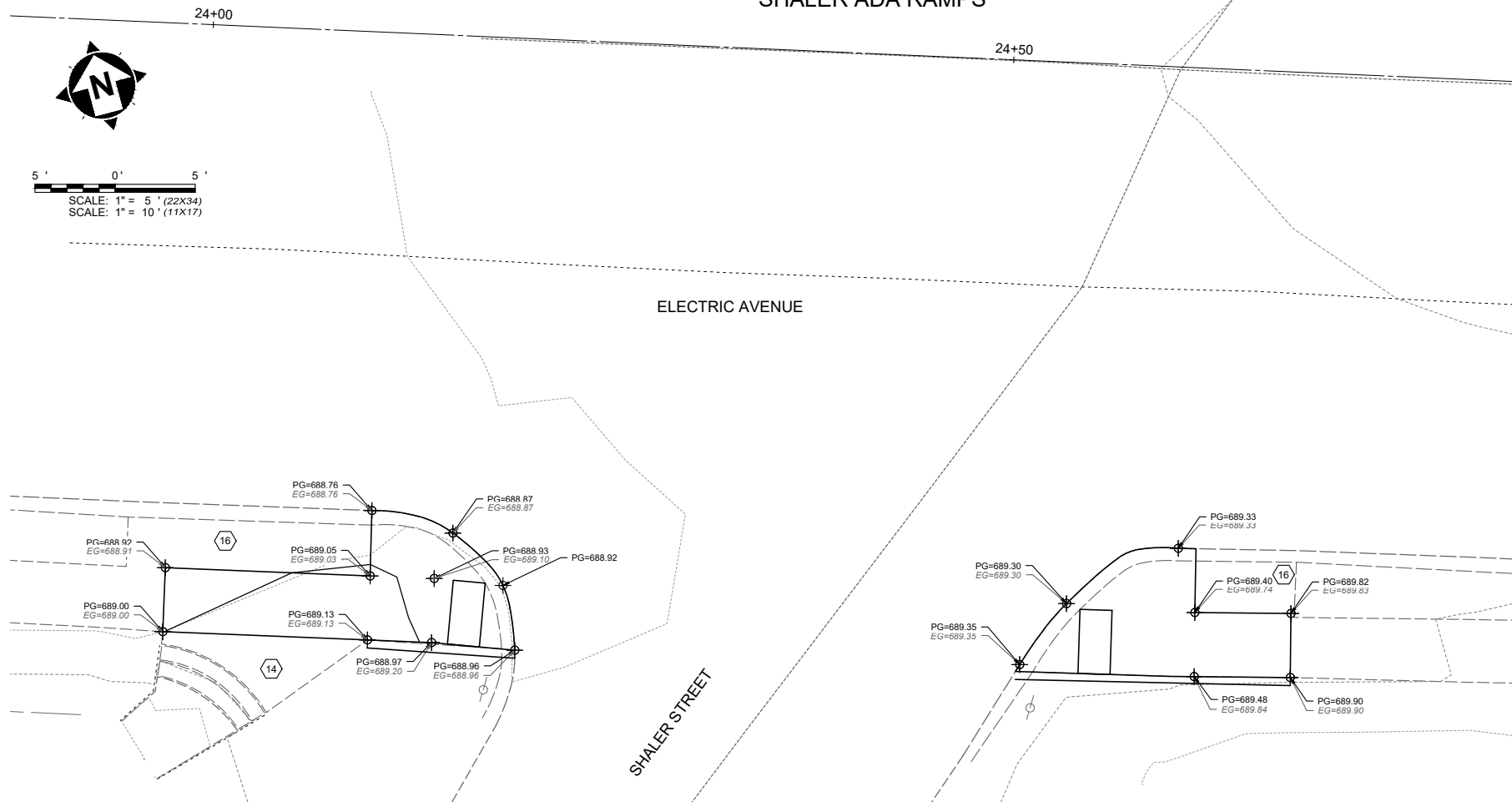

ELECTRIC AVENUE FULL DEPTH REPAIR (STA 27+75)

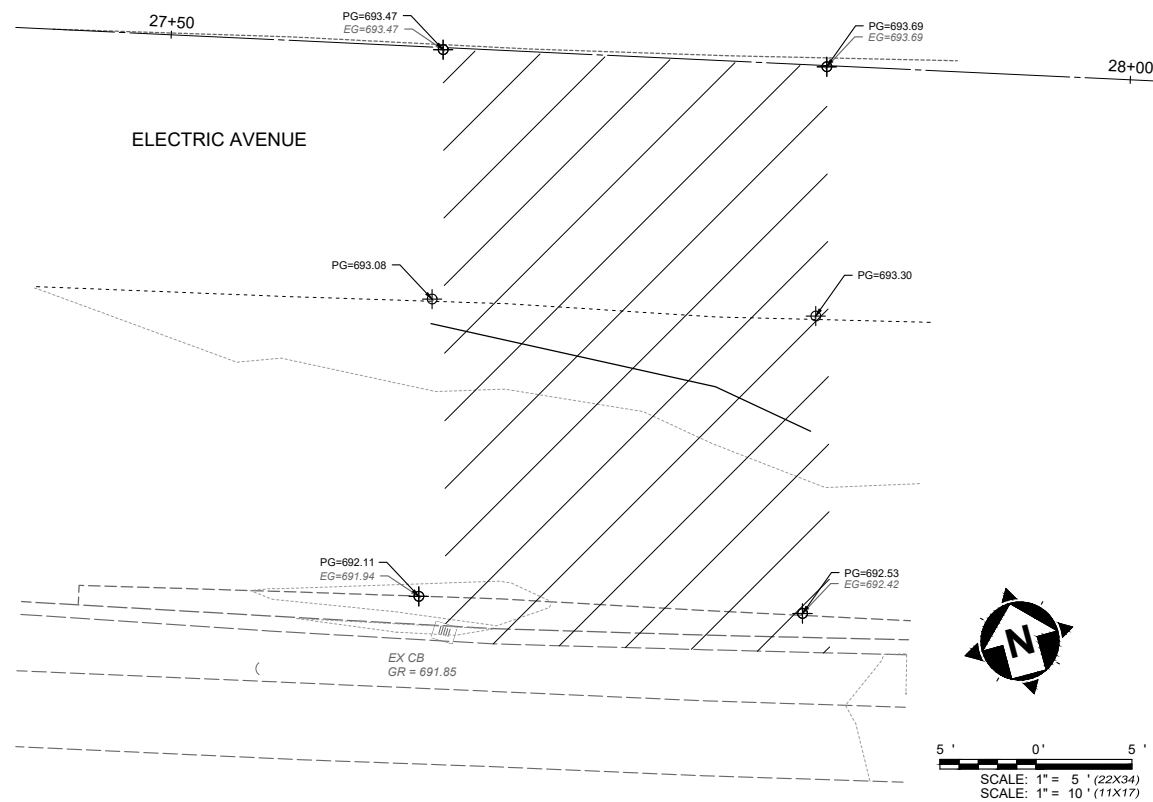

NOTE: STA. 27+65± TO STA. 27+85± CONTRACTOR TO CONSTRUCT FULL DEPTH REPAIR TO ELIMINATE "HUMP/DIP" IN PAVEMENT, CONTRACTOR SHALL ALSO CONSTRUCT VARIABLE MILL & OVERLAY WITHIN SURROUNDING AREA TO CREATE UNIFORM PAVEMENT CROSS SLOPE.

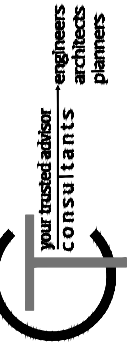

ISSUED FOR:	BID NO	REVISION	DATE
ISSUE DATE: 02/22/2024			
SCALE: AS SHOWN			
DESIGNED BY: RSEI			
DRAWN BY: RSEI			
CHECKED BY: JSJU			

**SOUTHGATE 2024 STREET PROGRAM**  
**CITY OF SOUTHGATE**  
 - CAMPBELL COUNTY, KY -  
**SPOT GRADING SHEET**

PROJECT NO. <b>241022</b>	
DISCIPLINE <b>CIVIL</b>	
SHEET NAME <b>GRADE</b>	
SHEET <b>10</b>	OF <b>10</b>