

# CITY OF LAKESIDE PARK

KENTON COUNTY, KENTUCKY

## 2024 CONCRETE STREET SPOT REPAIRS

241172

### CITY OF LAKESIDE PARK OFFICIALS

**MAYOR**

PAUL MARKGRAF

**CITY CLERK**

TERESA BRUCK

**CITY COUNCIL MEMBERS**

DAVE WOLFER

DENNIS LANDWEHR

MARY ANN THAMAN

BRIAN WAITE

TOM BERNHEIMER

CHRIS GONGOLA

**CITY ATTORNEY**

GREG VOSS

**PUBLIC WORKS DIRECTOR**

STEVE GREER



**K.T.C SPECIFICATIONS**

THE LATEST STANDARD SPECIFICATIONS OF THE KENTUCKY TRANSPORTATION CABINET, INCLUDING CHANGES AND SUPPLEMENTAL SPECIFICATIONS THERETO AND CITY OF LAKESIDE PARK ENGINEERING DEPARTMENT REQUIREMENTS SHALL GOVERN THIS IMPROVEMENT.

**SOURCE OF BOUNDARY INFORMATION**

THE BOUNDARY INFORMATION SHOWN ON THESE PLANS IS BASED UPON NORTHERN KENTUCKY AREA PLANNING COMMISSION G.I.S. MAPPING AND DOES NOT REPRESENT AN ACTUAL FIELD BOUNDARY SURVEY BY CT CONSULTANTS, INC.

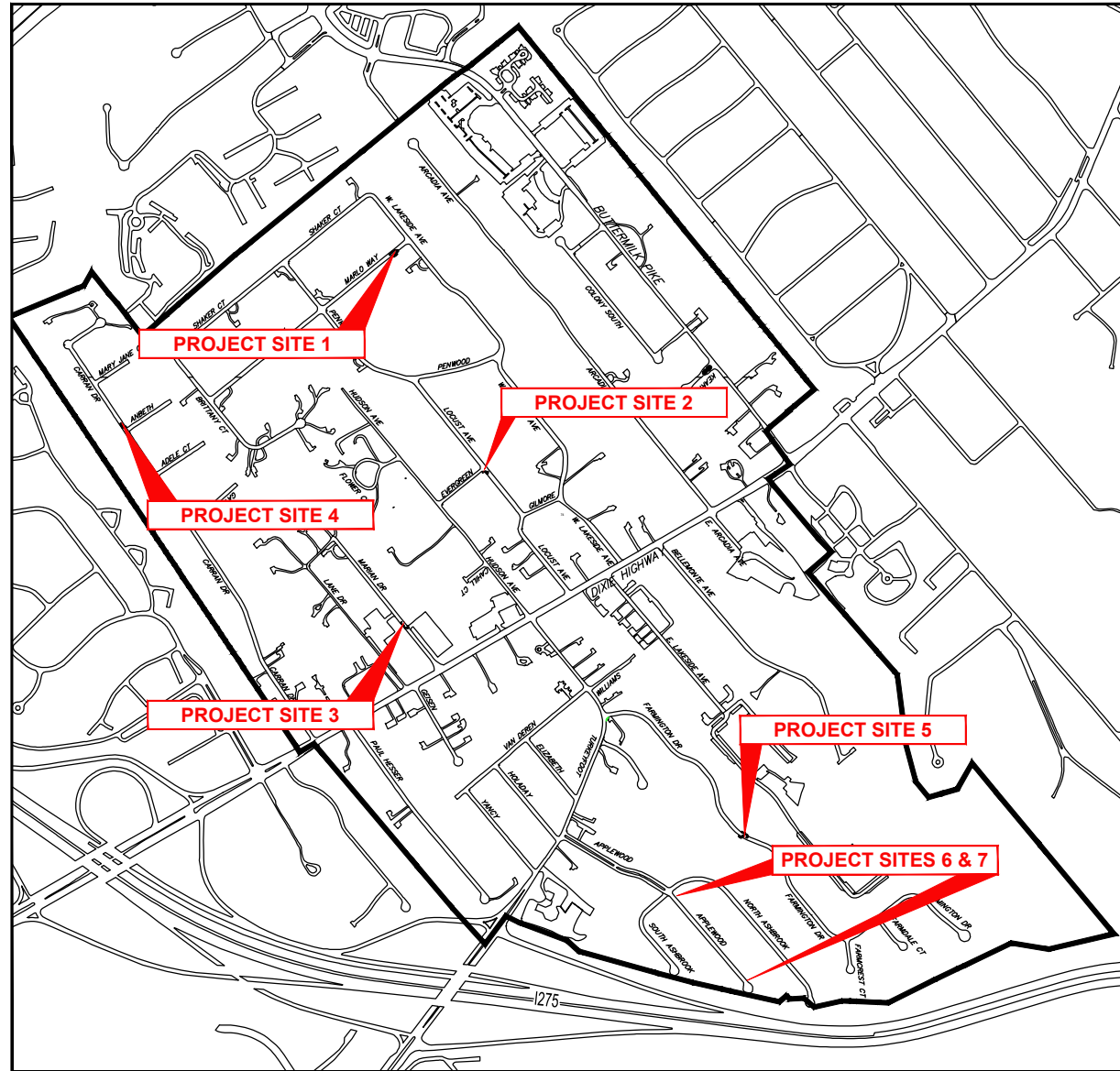

**VICINITY MAP**

N.T.S

INDEX OF SHEETS		
PAGE NO.	DWG NAME	SHEET TITLE
1	TTL	TITLE SHEET
2	NOT	NOTES
3	DET1	DETAILS 1
4	DET2	DETAILS 2
5	LOC	LOCATION MAP
6	PLN1	PLAN VIEW 1
7	PLN2	PLAN VIEW 2
8	PLN3	PLAN VIEW 3
9	PLN4	PLAN VIEW 4
10	PLN5	PLAN VIEW 5
11	PLN6	PLAN VIEW 6
12	PLN7	PLAN VIEW 7

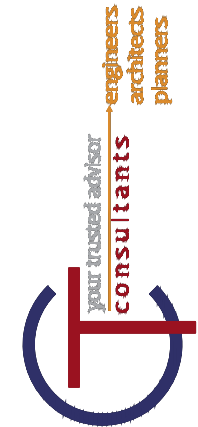

BID	ISSUED FOR:	ISSUE DATE:	SCALE:	DESIGNED BY:	DRAWN BY:	CHECKED BY:
		03/14/2024	AS NOTED	MHEL	EODS	MHEL

**CITY OF LAKESIDE PARK  
2024 CONCRETE STREET  
SPOT REPAIRS**  
LAKESIDE PARK, KENTUCKY

TITLE SHEET

PROJECT NO.	241172
DISCIPLINE	CIVIL
SHEET NAME	LOC
SHEET	OF
1	12

MARTIN P. HELLMANN

P.E. #27046

**GENERAL NOTES**

1. ALL APPLICABLE RECOMMENDATIONS IN KENTUCKY'S BEST MANAGEMENT PRACTICES MANUAL SHALL BE FOLLOWED BY THE CONTRACTOR, INCLUDING SEEDING OF DISTURBED GROUND.
2. THE CONTRACTOR SHALL LIMIT THEIR WORK AREA TO THE EASEMENTS AND RIGHTS-OF-WAY SHOWN ON THESE PLANS UNLESS WRITTEN PERMISSION IS GIVEN BY THE PROPERTY OWNER
3. ALL OSHA, STATE AND LOCAL SAFETY REGULATIONS SHALL BE FOLLOWED DURING CONSTRUCTION.
4. THIS PLAN SHOWS THE APPROXIMATE LOCATION OF UNDERGROUND UTILITIES (GAS, WATER, STORM SEWER, SANITARY SEWER, TELEPHONE, ELECTRIC, ETC.). THE PREPARER DOES NOT GUARANTEE THEIR ACCURACY OR CORRECTNESS. THE INFORMATION PROVIDED SHALL BE FIELD VERIFIED PRIOR TO CONSTRUCTION. THE CONTRACTOR SHALL BE RESPONSIBLE FOR MAINTAINING THE UTILITY AS WELL AS THE SERVICE LATERALS AT ALL TIMES DURING CONSTRUCTION. THE CONTRACTOR SHALL PRACTICE CARE DURING THE GRADING AND TRENCH EXCAVATION AND SHALL BE RESPONSIBLE FOR REPLACING ANY SERVICES THAT ARE DAMAGED DURING CONSTRUCTION AT THEIR EXPENSE.
5. FORTY-EIGHT (48) HOURS BEFORE EXCAVATION IS TO COMMENCE, THE CONTRACTOR SHALL NOTIFY THE FOLLOWING AGENCIES: THE KENTUCKY UTILITY PROTECTION SERVICE AND ALL OTHER UTILITIES THAT MAY HAVE UNDERGROUND UTILITIES INVOLVING THIS PROJECT AND ARE NON-MEMBERS OF KENTUCKY UNDERGROUND PROTECTION.
6. NO CONSTRUCTION SHALL COMMENCE UNTIL ALL KENTON COUNTY AND THE CITY OF LAKESIDE PARK PERMITS HAVE BEEN ISSUED AS REQUIRED.
7. THE CONTRACTOR SHALL COORDINATE ALL WORK WITHIN THE PUBLIC RIGHT OF WAY WITH THE CITY OF LAKESIDE PARK. LOCAL TRAFFIC MUST BE MAINTAINED AT ALL TIMES DURING CONSTRUCTION UNLESS OTHERWISE NOTED IN THESE PLANS. CONTRACTOR SHALL BE REQUIRED TO MAINTAIN SANITARY SEWER AND STORM SEWER FLOW THROUGHOUT THE PROJECT, FOR THE DURATION OF CONSTRUCTION. ALL COST FOR THE ABOVE SHALL BE INCIDENTAL TO THE CONTRACT.
8. ADDITIONAL BMP'S AND EROSION AND SEDIMENT CONTROL MEASURES MAY BE REQUIRED AS DEEMED NECESSARY. ALL COST FOR ABOVE SHALL BE INCLUDED IN LUMP SUM BID FOR EROSION CONTROL AND WATER POLLUTION CONTROL.

**MAINTENANCE OF TRAFFIC NOTES**

1. ALL MAINTENANCE OF TRAFFIC PROCEDURES SHALL MEET THE REQUIREMENT OF THE MANUAL OF UNIFORM TRAFFIC CONTROL DEVICES AND SECTION 112 OF KTC STANDARD SPECIFICATIONS. THE CONTRACTOR SHALL MAINTAIN ACCESS TO LOCAL TRAFFIC (ACCESS TO RESIDENCES WITHIN CONSTRUCTION LIMITS) AT ALL TIMES. THE CONTRACTOR SHALL PROVIDE SUFFICIENT SIGN, WARNING LIGHTS, BARRICADES, OR OTHER NECESSARY DEVICES MAKE THE SITE SAFE TO THE TRAVELING PUBLIC.
2. IT SHALL BE THE CONTRACTOR'S RESPONSIBILITY TO SUBMIT TO THE ENGINEER AND THE OWNER A TRAFFIC CONTROL PLAN FOR THIS PROJECT.
3. THE CONTRACTOR SHALL NOTIFY THE CITY OF LAKESIDE PARK AND THE LAKESIDE PARK POLICE DEPARTMENT PRIOR TO ANY CONSTRUCTION. EMERGENCY VEHICLE ACCESS SHALL BE MAINTAINED AT ALL TIMES.
4. RESIDENTS OF THE PROJECT AREA SHALL BE ALLOWED ACCESS TO THEIR PROPERTY AT ALL TIMES.



ISSUED FOR:	BID
ISSUE DATE:	03/14/2024
SCALE:	AS NOTED
DESIGNED BY:	MHEL
DRAWN BY:	EODS
CHECKED BY:	MHEL

**CITY OF LAKESIDE PARK  
2024 CONCRETE STREET  
SPOT REPAIRS  
LAKESIDE PARK, KENTUCKY**

**GENERAL NOTES**

PROJECT NO.	<b>241172</b>
DISCIPLINE	<b>CIVIL</b>
SHEET NAME	<b>NOT</b>
SHEET	<b>2</b>
OF	<b>12</b>

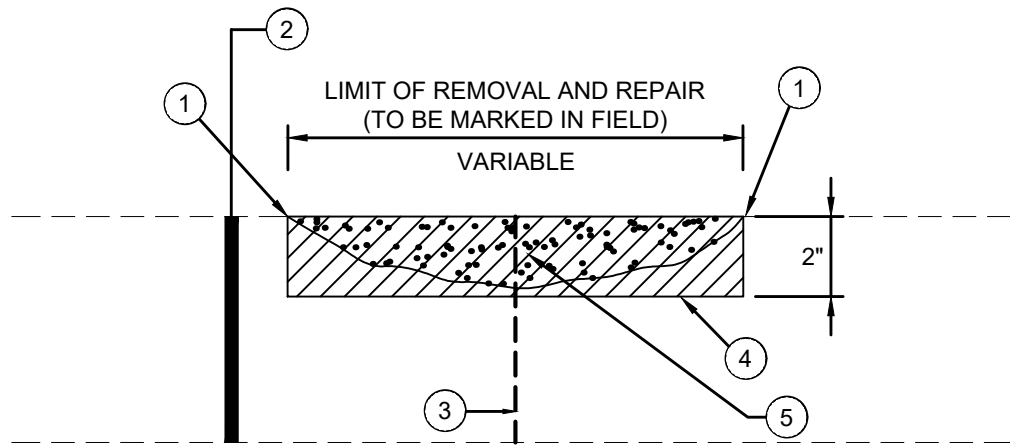

- ① SEAL EDGE
- ② EXISTING CONCRETE PAVEMENT
- ③ EXISTING JOINT
- ④ ITEM 406, TACK COAT (INCIDENTAL TO 402/403)
- ⑤ ITEM 402/403, ASPHALT CONCRETE

**PARTIAL DEPTH PAVEMENT JOINT  
REPAIR DETAIL**  
N.T.S.

NOTE:

REMOVE DETERIORATED PAVEMENT TO THE DEPTH SPECIFIED BY THE ENGINEER, SQUARING THE EDGES OF THE AREA TO BE REPAIRED. COAT THE SURFACE AREA WITH 406 MATERIAL BEFORE PLACING ITEM 402/403. WHEN DETERIORATION EXTENDS TO A DEPTH OF MORE THAN 4" IN THE CONCRETE, AND AT THE DIRECTION OF THE ENGINEER, A FULL DEPTH REMOVAL AND CONCRETE PAVEMENT REPLACEMENT SHALL BE MADE. (UNDER A SEPARATE PAY ITEM).

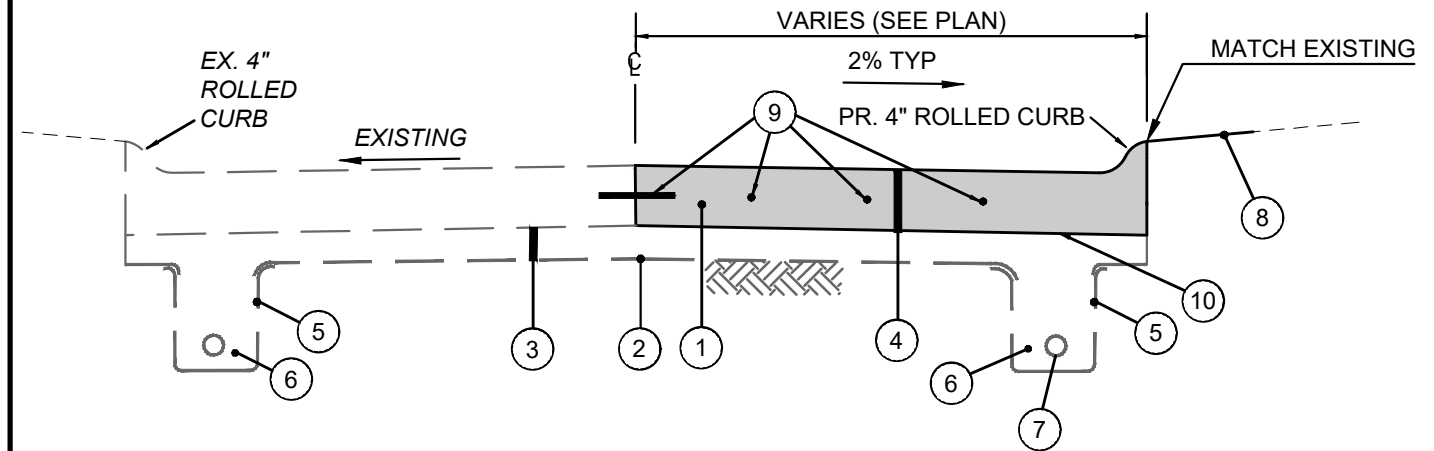

**CONCRETE PAVEMENT REPLACEMENT  
TYPICAL SECTION WITH EDGE DRAIN**  
N.T.S.

- ① ITEM 203 - REMOVE EXISTING PAVEMENT.
- ② EXISTING TO REMAIN- WOVEN GEOTEXTILE, MIRAFI 600X OR EQUIVALENT, ALL OVERLAPS TO BE 18" MIN.
- ③ EXISTING TO REMAIN - 4" GRAVEL BASE - CLEAN NO. 57
- ④ ITEM SPL - 8" PORTLAND CEMENT CONCRETE PAVEMENT - PER KENTON COUNTY SUBDIVISION REGULATIONS WITH 4" ROLLED CURB.
- ⑤ EXISTING TO REMAIN - NONWOVEN GEOTEXTILE, MIRAFI 140N
- ⑥ EXISTING TO REMAIN- CLEAN NO. 57 CRUSHED STONE
- ⑦ EXISTING TO REMAIN - 4" RIGID PVC PERFORATED PIPE UNDERDRAIN
- ⑧ ITEM SPL - YARD RESTORATION (4" TOPSOIL, SEED AND MULCH) - INCIDENTAL TO CONCRETE
- ⑨ 18" LONG #4 BAR @ 60" O.C. (INCIDENTAL TO CONCRETE)
- ⑩ ITEM 302 - ADDITIONAL CLEAN NO. 57 CRUSHED STONE AS NEEDED TO BRING CONCRETE TO GRADE. INCIDENTAL TO CONCRETE PAVEMENT.

NOTE: ALL JOINTS TO BE JOINT AND CRACK SEALED PER KENTON COUNTY SUBDIVISION REGULATIONS (INCIDENTAL TO CONCRETE PAVEMENT)

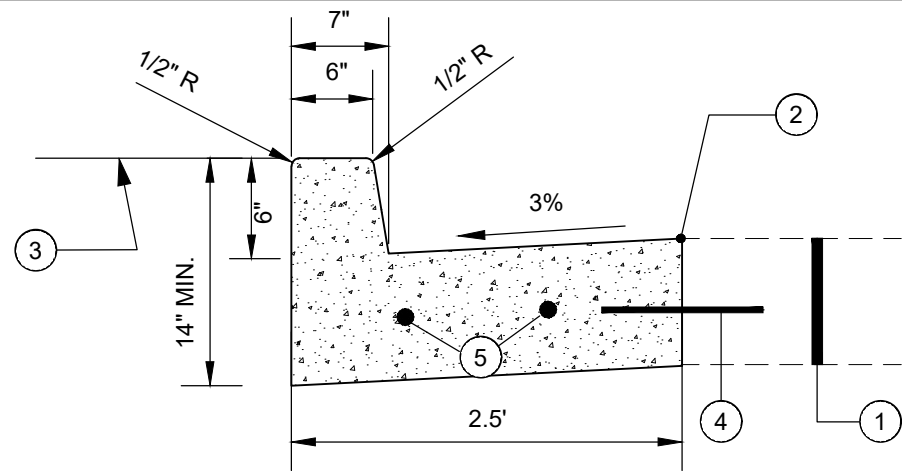

- ① EXISTING PAVEMENT
- ② APPLY HOT ASPHALT SEALER (INCIDENTAL TO CONCRETE CURB)
- ③ ITEM SPL - YARD RESTORATION (INCIDENTAL TO CURB REPLACEMENT)
- ④ 3/4" DIA. DOWELS 18" LONG - DRILL 9" MIN. INTO EXIST. CONCRETE. 60" O.C.
- ⑤ 3/4" DIA. DOWELS 18" LONG - DRILL 9" MIN. INTO EXISTING CURB. PLACED AT EXPANSION AND CONSTRUCTION JOINTS OR ANYWHERE PROPOSED CURB ABUTS EXISTING CURB.

CONCRETE SHALL BE PER THE LATEST EDITION OF THE KENTON COUNTY SUBDIVISION REGULATIONS

**6" CONCRETE VERTICAL CURB & GUTTER REPLACEMENT**  
N.T.S.



BID	ISSUED FOR:
03/14/2024	ISSUE DATE:
AS NOTED	SCALE:
MHEL	DESIGNED BY:
EODS	DRAWN BY:
MHEL	CHECKED BY:

**CITY OF LAKESIDE PARK  
2024 CONCRETE STREET  
SPOT REPAIRS**  
LAKESIDE PARK, KENTUCKY

**DETAILS 1**

PROJECT NO.	
241172	
DISCIPLINE	
CIVIL	
SHEET NAME	
DET1	
SHEET	OF
3	12

NOTE:

1. ANY YARD AREA DISTURBED BY THE CONSTRUCTION OF THE DRIVEWAY APRON SHALL BE RESTORED WITH TOPSOIL, SEED AND MULCH (INCIDENTAL TO CONCRETE DRIVEWAY APRON REPLACEMENT).
2. ALL EXCAVATION REQUIRED FOR THE PLACEMENT OF THE PROPOSED DRIVEWAY SHALL BE INCIDENTAL TO CONCRETE DRIVEWAY REPLACEMENT BID ITEM.

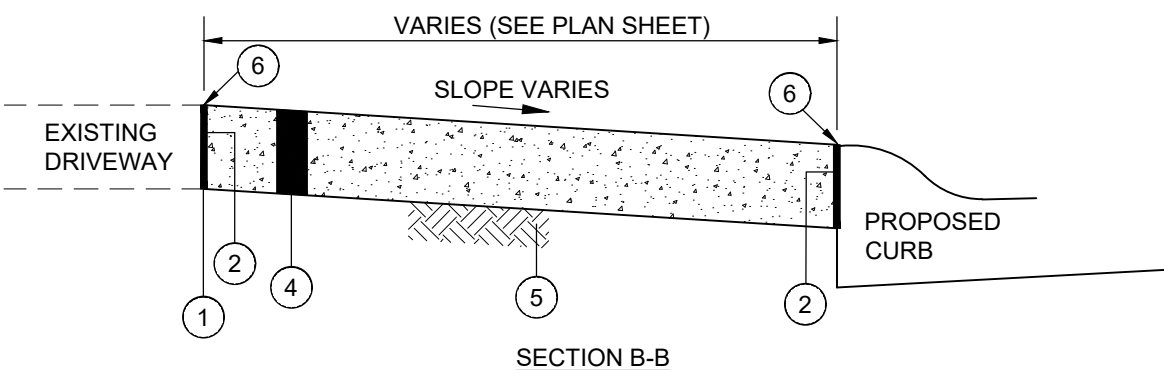
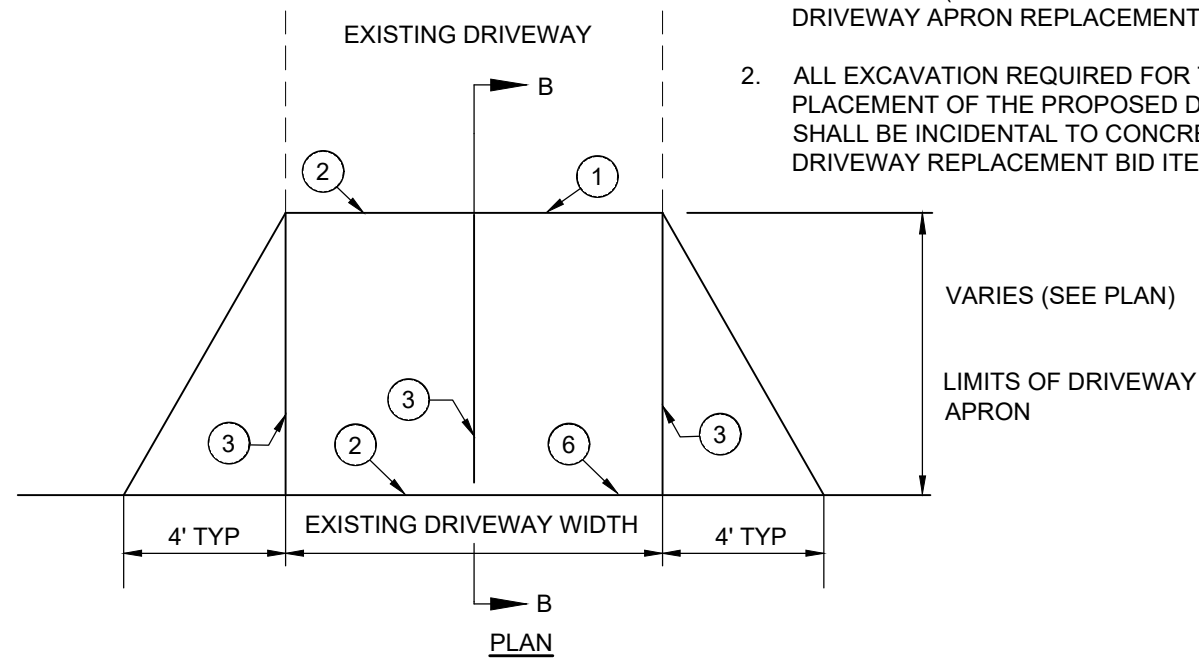

- 1 SAWCUT AT NEAREST JOINT AND REMOVE EXISTING CONCRETE PAVEMENT (INCIDENTAL TO ITEM SPL)
- 2 1" PREFORMED EXPANSION JOINT MATERIAL (FLEXIBLE FOAM-CERAMAR BY W.R. MEADOWS OR APPROVED EQUAL) - INCIDENTAL TO DRIVEWAY REPLACEMENT
- 3 TOOLED JOINT
- 4 ITEM SPL - 6" CONCRETE DRIVEWAY/APRON (PER KENTON COUNTY SUBDIVISION REGULATIONS)
- 5 ITEM 207 - COMPACTED SUBGRADE (INCIDENTAL TO ITEM SPL - 6" CONCRETE DRIVEWAY/APRON)
- 6 SEAL JOINT WITH GRAY SELF LEVELING SEALANT (SIKA FLEX OR APPROVED EQUAL)

**CONCRETE DRIVEWAY REPLACEMENT  
(NO SIDEWALK)  
N.T.S.**

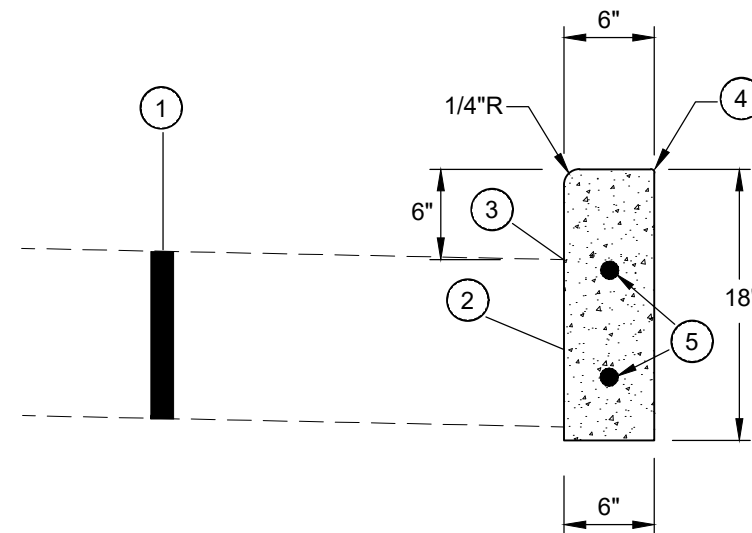
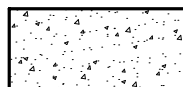

- 1 EXISTING PAVEMENT & RESURFACING (SEE TYPICAL SECTIONS)
- 2 SAWCUT & REMOVE EXISTING CURB
- 3 APPLY HOT ASPHALT SEALER WHERE ASPHALT MEETS CURB (INCIDENTAL TO ITEM 402).
- 4 TOP OF REPLACEMENT CURB TO MATCH LINE & GRADE OF EXIST. CURB
- 5  $\frac{5}{8}$ " DIA. DOWELS 18" LONG - DRILL 9" MIN. INTO EXIST. CURB

\* NOTE: THIS IS A CONTINGENCY ITEM TO BE USED ONLY AT THE DIRECTION OF THE ENGINEER LIMITS TO BE MARKED IN THE FIELD BY THE ENGINEER.

NOTE: CONTRACTOR SHALL FILL BEHIND CURB TO THE TOP OF THE CURB w/ TOPSOIL AND RESTORE YARD w/ SEED/MULCH. THE COST FOR TOPSOIL, SEED/MULCH SHALL BE INCIDENTAL TO THE UNIT PRICE BID FOR CURB REPLACEMENT.

CONCRETE SHALL BE PER THE LATEST EDITION OF THE KENTON COUNTY SUBDIVISION REGULATIONS

**6" VERTICAL CURB REPLACEMENT N.T.S.**

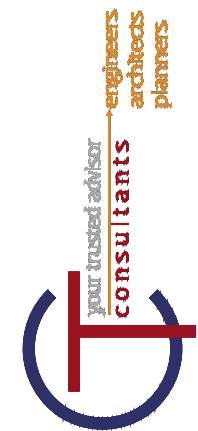

ISSUED FOR:	BID
ISSUE DATE:	03/14/2024
SCALE:	AS NOTED
DESIGNED BY:	MHEL
DRAWN BY:	EODS
CHECKED BY:	MHEL

**CITY OF LAKESIDE PARK  
2024 CONCRETE STREET  
SPOT REPAIRS  
LAKESIDE PARK, KENTUCKY**

**DETAILS 2**

PROJECT NO.	241172
DISCIPLINE	CIVIL
SHEET NAME	DET2
SHEET	4
OF	12

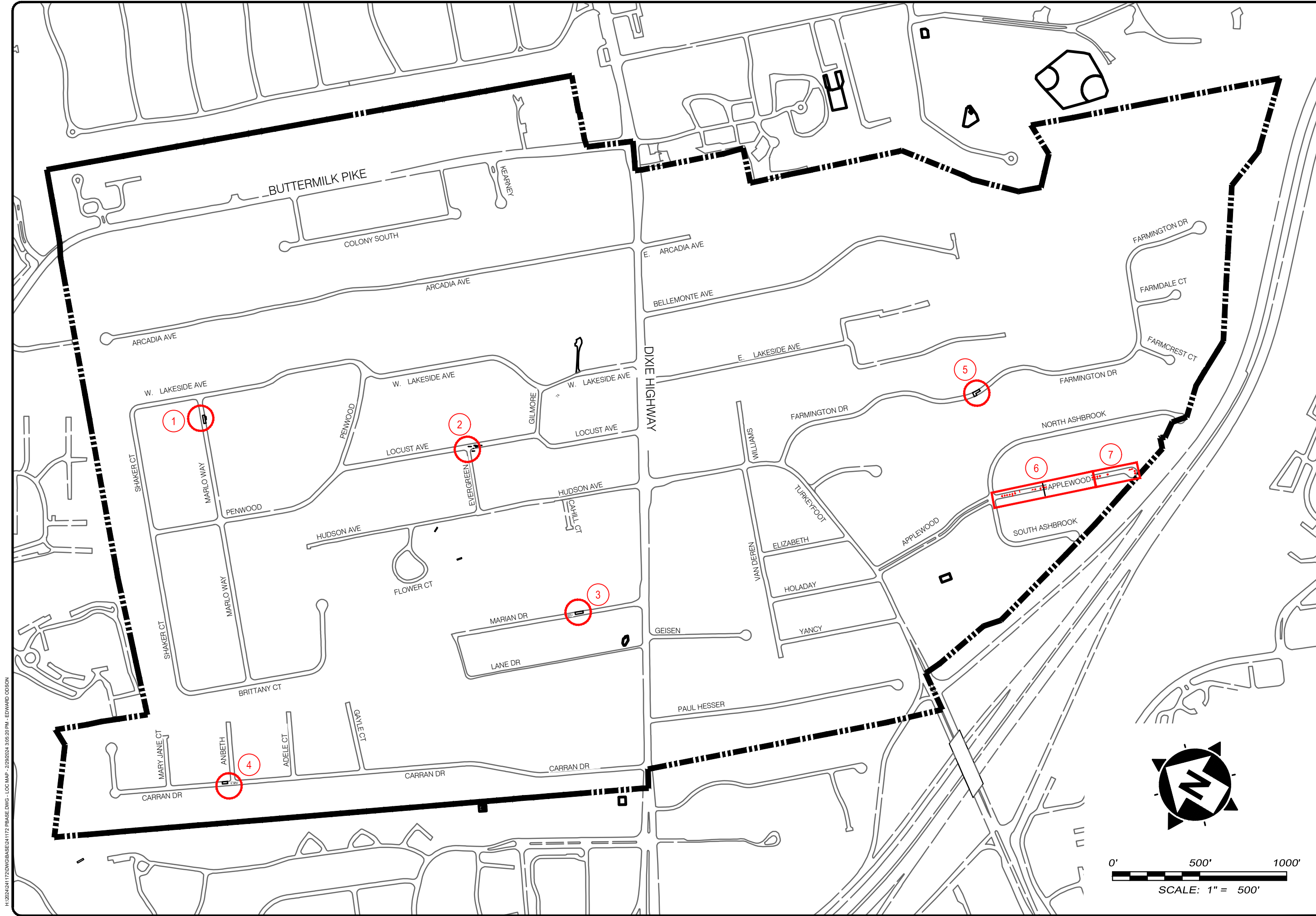

H:\2024\241172\DWG\BASE\241172\_PBASE.DWG - LOC MAP - 2/28/2024 3:05:20 PM - EDWARD ODSON



ISSUED FOR:	BID
ISSUE DATE:	03/14/2024
SCALE:	AS NOTED
DESIGNED BY:	MHEL
DRAWN BY:	EODS
CHECKED BY:	MHEL

**CITY OF LAKESIDE PARK  
2024 CONCRETE STREET  
SPOT REPAIRS**  
LAKESIDE PARK, KENTUCKY

**LOCATION MAP**

PROJECT NO.	
241172	
DISCIPLINE	
CIVIL	
SHEET NAME	
LOC	
SHEET	OF
5	12

H:\2024\241172\DWG\BASE\241172\_PHASE.DWG - PLAN 1 - 2/20/2024 3:05:20 PM - EDWARD ODSON



8" PROPOSED CONCRETE PAVEMENT REPLACEMENT  
SEE SHEET DET1

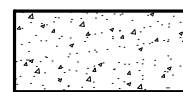

6" CONCRETE DRIVEWAY REPLACEMENT  
SEE SHEET DET2



CURB AND GUTTER REPLACEMENT  
SEE SHEET DET1



VERTICAL CURB REPLACEMENT  
SEE SHEET DET2

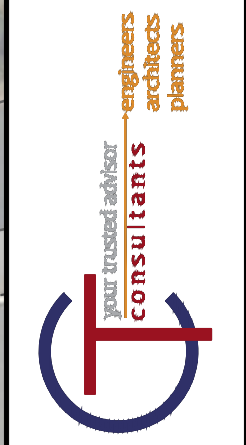
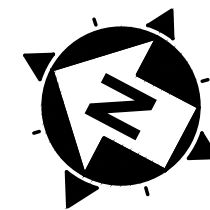

ISSUED FOR:	BID
ISSUE DATE:	03/14/2024
SCALE:	AS NOTED
DESIGNED BY:	MHEL
DRAWN BY:	EODS
CHECKED BY:	MHEL

**CITY OF LAKESIDE PARK**  
**2024 CONCRETE STREET**  
**SPOT REPAIRS**  
 LAKESIDE PARK, KENTUCKY

**PLAN VIEW 1**

PROJECT NO.	
241172	
DISCIPLINE	
CIVIL	
SHEET NAME	
PLN1	
SHEET	OF
6	12

H:\2024\241172\DWG\BASE\241172\_PBASE.DWG - PLAN2 - 2/20/2024 3:05:20 PM - EDWARD ODSON

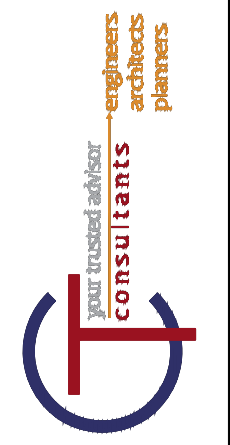
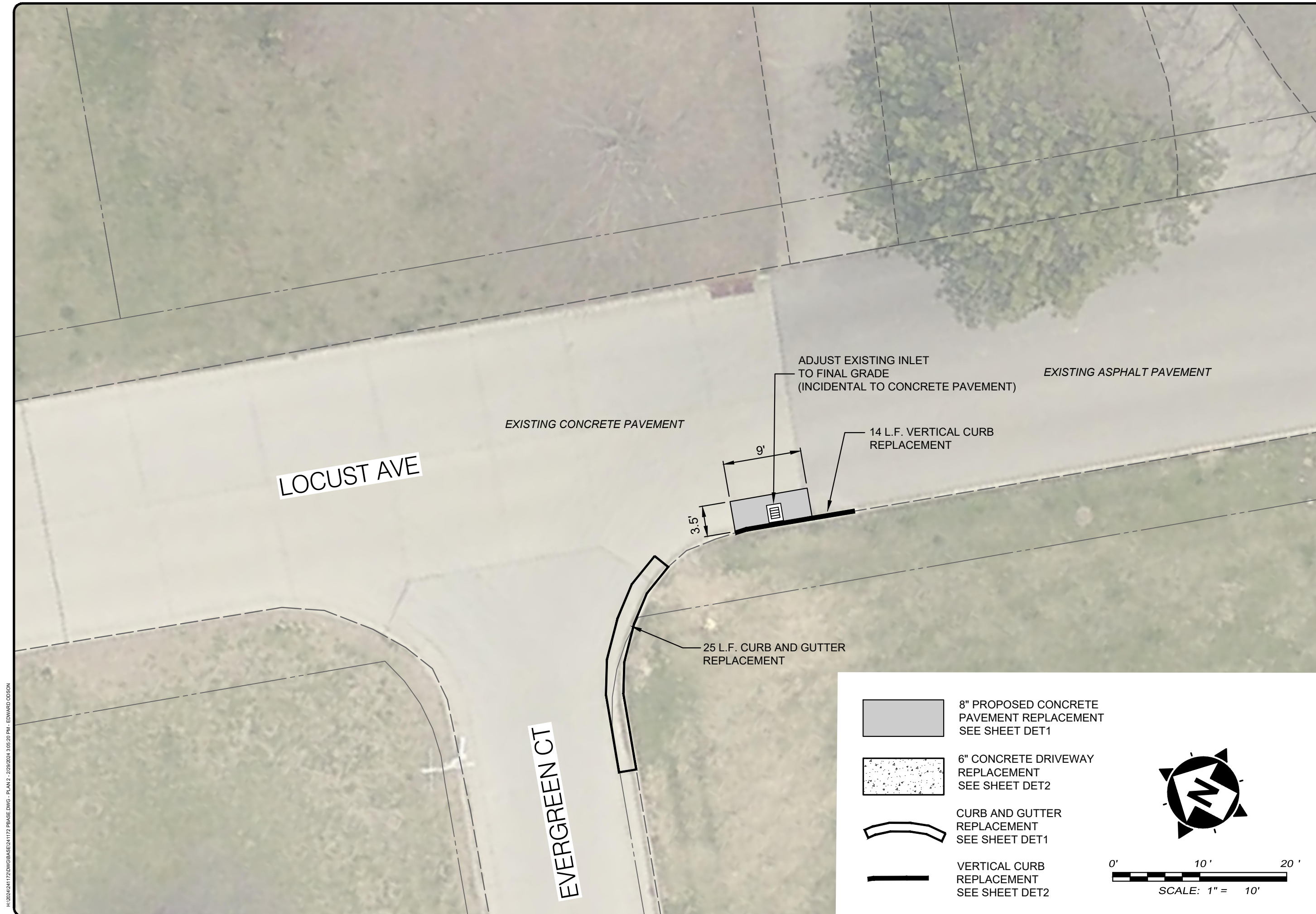





ISSUED FOR:	BID
ISSUE DATE:	03/14/2024
SCALE:	AS NOTED
DESIGNED BY:	MHEL
DRAWN BY:	EODS
CHECKED BY:	MHEL

**CITY OF LAKESIDE PARK**  
**2024 CONCRETE STREET**  
**SPOT REPAIRS**  
 LAKESIDE PARK, KENTUCKY

**PLAN VIEW 2**

PROJECT NO.	
241172	
DISCIPLINE	
CIVIL	
SHEET NAME	
PLN2	
SHEET	OF
7	12

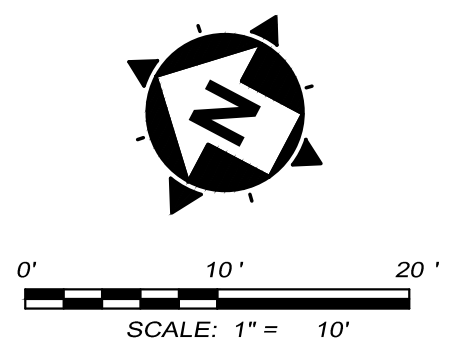

-  8" PROPOSED CONCRETE PAVEMENT REPLACEMENT SEE SHEET DET1
-  6" CONCRETE DRIVEWAY REPLACEMENT SEE SHEET DET2
-  CURB AND GUTTER REPLACEMENT SEE SHEET DET1
-  VERTICAL CURB REPLACEMENT SEE SHEET DET2



H:\2024\241172\DWG\BASE\241172\_Plane3 - 2/20/2024 3:05:20 PM - EDWARD ODSON

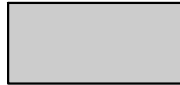
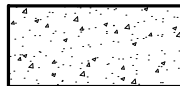

NOTE: A SEPARATE JOINT AND CRACK SEAL PROGRAM IS SCHEDULED FOR THIS STREET IN 2024. CONTRACTOR MAY EXCLUDE JOINT AND CRACK SEALING FOR THIS STREET.

-  8" PROPOSED CONCRETE PAVEMENT REPLACEMENT SEE SHEET DET1
-  6" CONCRETE DRIVEWAY REPLACEMENT SEE SHEET DET2
-  CURB AND GUTTER REPLACEMENT SEE SHEET DET1
-  VERTICAL CURB REPLACEMENT SEE SHEET DET2

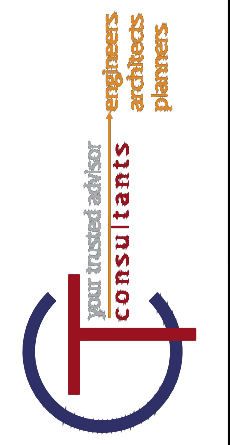
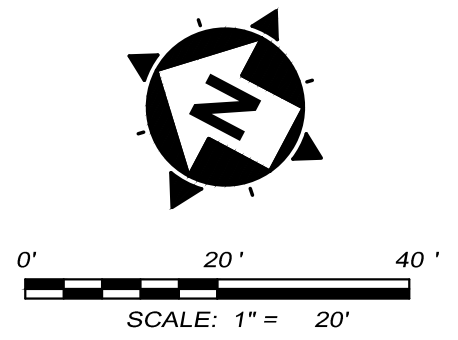

ISSUED FOR:	BID
ISSUE DATE:	03/14/2024
SCALE:	AS NOTED
DESIGNED BY:	MHEL
DRAWN BY:	EODS
CHECKED BY:	MHEL

**CITY OF LAKESIDE PARK  
2024 CONCRETE STREET  
SPOT REPAIRS**  
LAKESIDE PARK, KENTUCKY

**PLAN VIEW 3**

PROJECT NO.	
241172	
DISCIPLINE	
CIVIL	
SHEET NAME	
PLN3	
SHEET	OF
8	12



H:\2024\241172\DWG\BASE\241172\_PHASE.DWG - PLAN 4 - 2/20/2024 3:05:20 PM - EDWARD ODSON

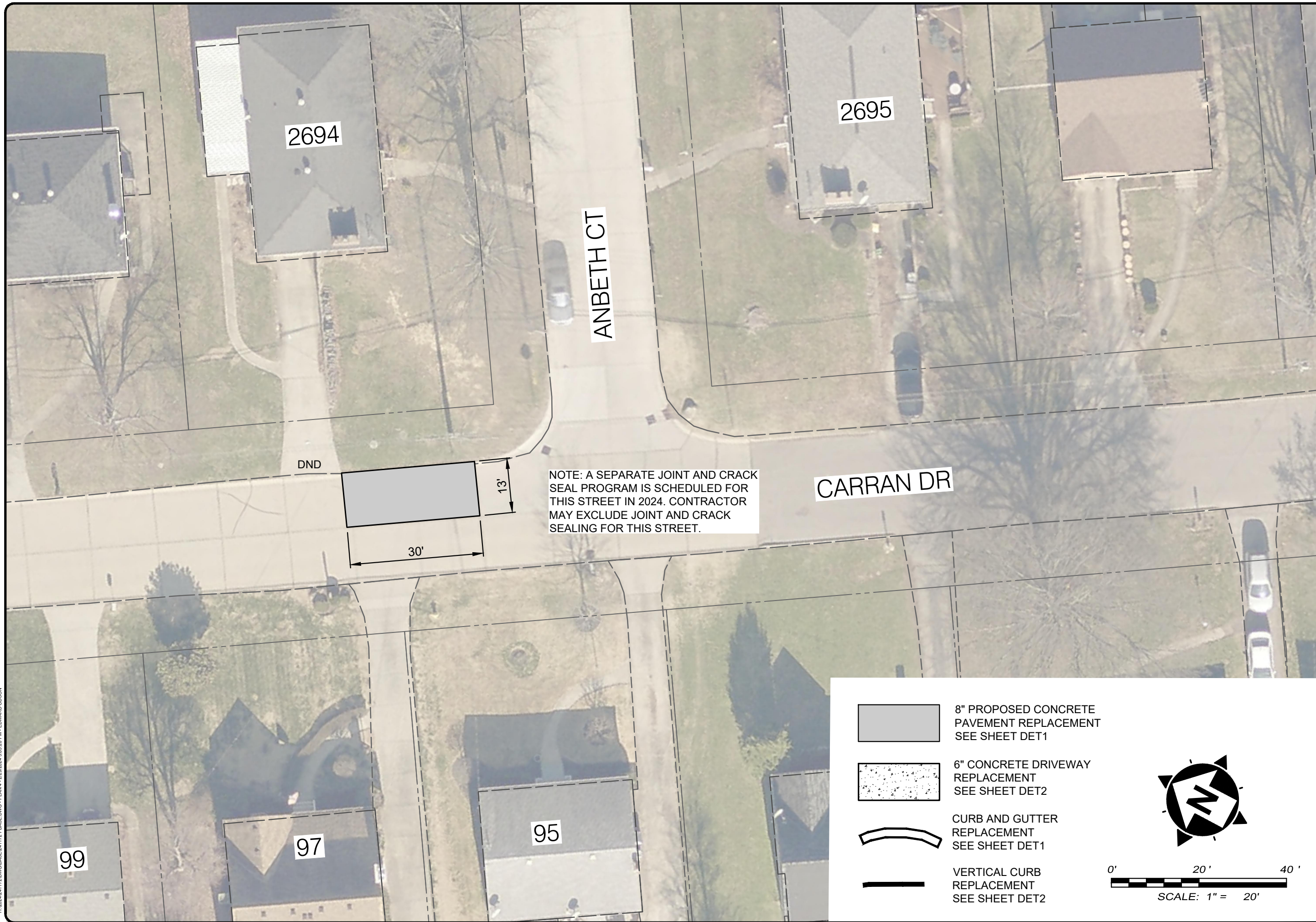

2694

2695

ANBETH CT

CARRAN DR

DND

30'

13'

NOTE: A SEPARATE JOINT AND CRACK SEAL PROGRAM IS SCHEDULED FOR THIS STREET IN 2024. CONTRACTOR MAY EXCLUDE JOINT AND CRACK SEALING FOR THIS STREET.

99

97

95



8" PROPOSED CONCRETE PAVEMENT REPLACEMENT SEE SHEET DET1

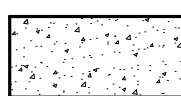

6" CONCRETE DRIVEWAY REPLACEMENT SEE SHEET DET2



CURB AND GUTTER REPLACEMENT SEE SHEET DET1



VERTICAL CURB REPLACEMENT SEE SHEET DET2

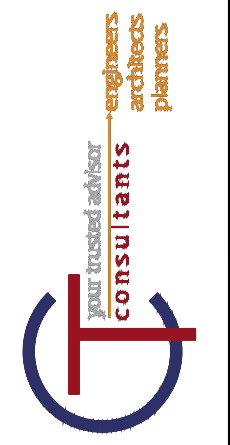

ISSUED FOR:	BID
ISSUE DATE:	03/14/2024
SCALE:	AS NOTED
DESIGNED BY:	MHEL
DRAWN BY:	EODS
CHECKED BY:	MHEL

CITY OF LAKESIDE PARK  
2024 CONCRETE STREET  
SPOT REPAIRS  
LAKESIDE PARK, KENTUCKY

PLAN VIEW 4

PROJECT NO.	
241172	
DISCIPLINE	
CIVIL	
SHEET NAME	
PLN4	
SHEET	OF
9	12

H:\2024\241172\DWG\BASE\241172\_PBASE.DWG - PLANS - 2/20/2024 3:05:20 PM - EDWARD COBSON

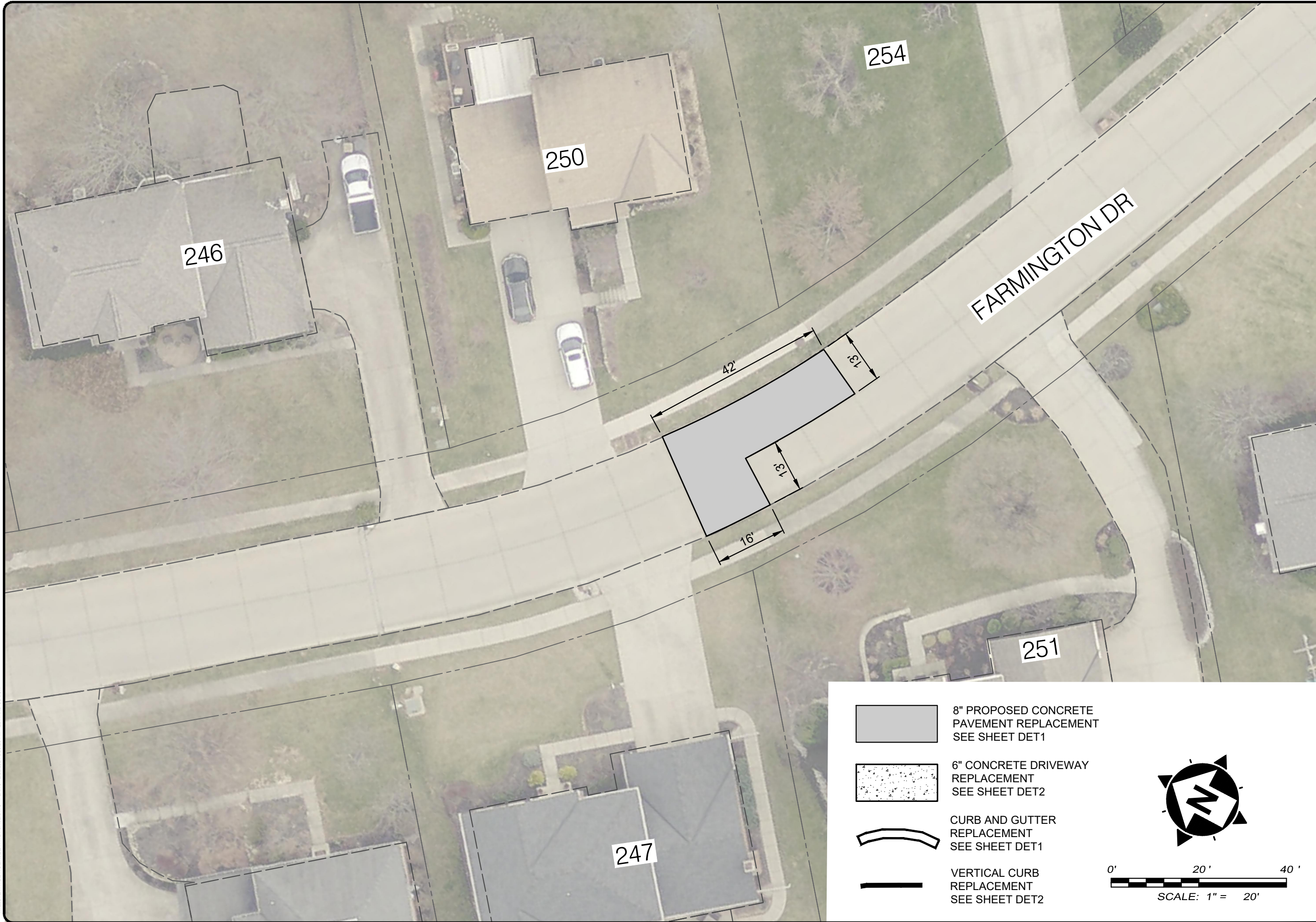

8" PROPOSED CONCRETE PAVEMENT REPLACEMENT  
SEE SHEET DET1

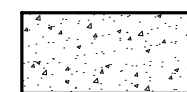

6" CONCRETE DRIVEWAY REPLACEMENT  
SEE SHEET DET2



CURB AND GUTTER REPLACEMENT  
SEE SHEET DET1



VERTICAL CURB REPLACEMENT  
SEE SHEET DET2

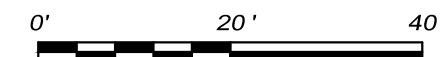
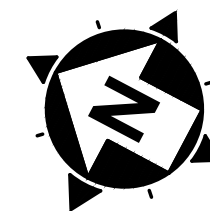

SCALE: 1" = 20'

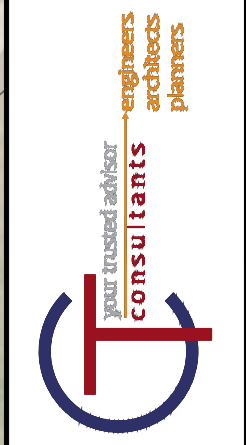

ISSUED FOR:	BID
ISSUE DATE:	03/14/2024
SCALE:	AS NOTED
DESIGNED BY:	MHEL
DRAWN BY:	EODS
CHECKED BY:	MHEL

**CITY OF LAKESIDE PARK**  
**2024 CONCRETE STREET**  
**SPOT REPAIRS**  
 LAKESIDE PARK, KENTUCKY

**PLAN VIEW 5**

PROJECT NO.	
241172	
DISCIPLINE	
CIVIL	
SHEET NAME	
PLN5	
SHEET	OF
10	12

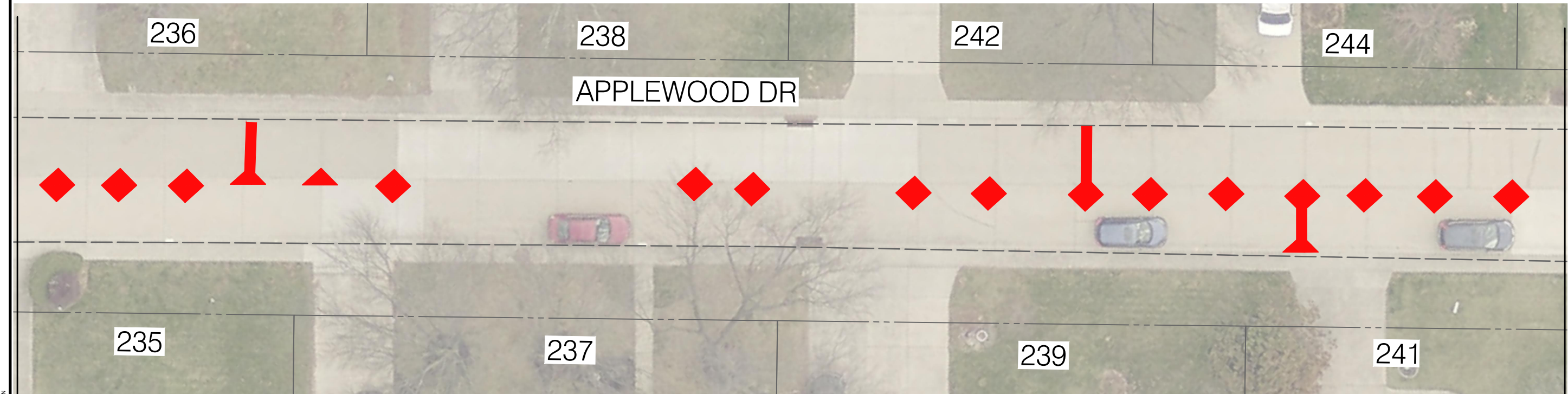
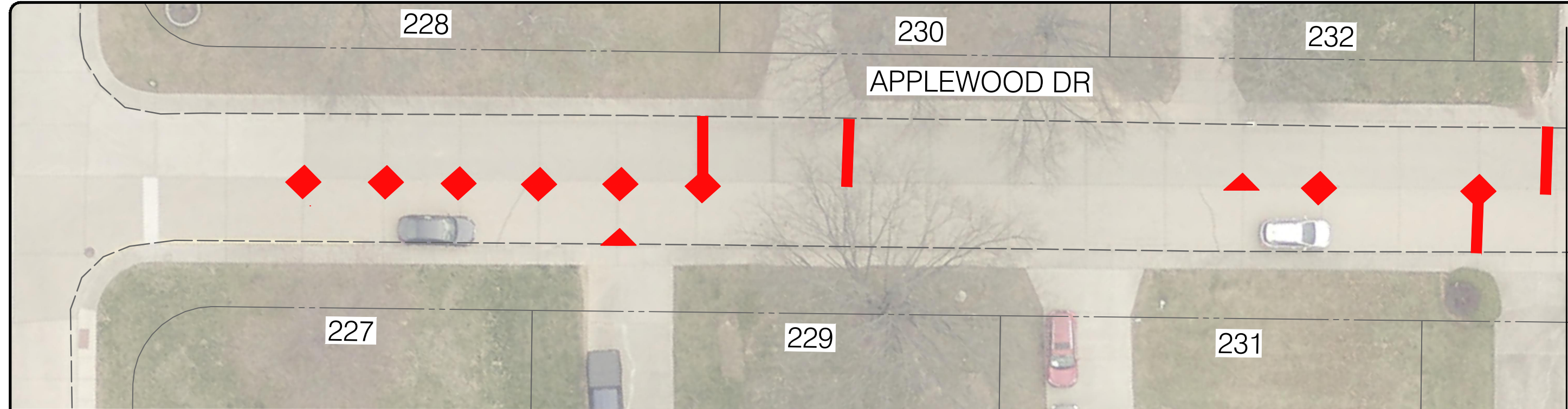

H:\2024\241172\DWG\BASE\241172\_Plane6 - 2/20/2024 3:05:20 PM - EDWARD ODSON

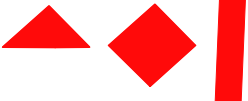
 PARTIAL DEPTH PAVEMENT JOINT REPAIR. TO BE MARKED IN THE FIELD. SEE SHEET DETAIL1

 8" PROPOSED CONCRETE PAVEMENT REPLACEMENT SEE SHEET DET1

 6" CONCRETE DRIVEWAY REPLACEMENT SEE SHEET DET2

 CURB AND GUTTER REPLACEMENT SEE SHEET DET1

 VERTICAL CURB REPLACEMENT SEE SHEET DET2

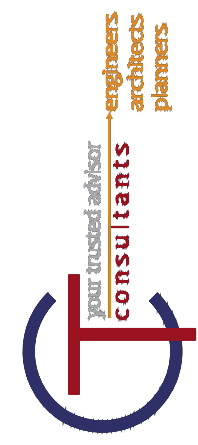
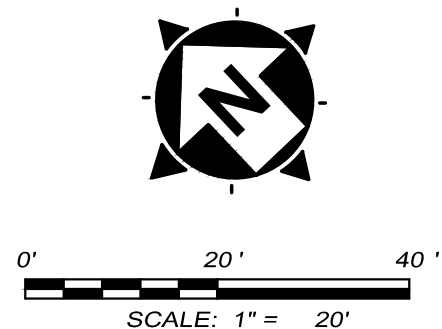





ISSUED FOR:	BID
ISSUE DATE:	03/14/2024
SCALE:	AS NOTED
DESIGNED BY:	MHEL
DRAWN BY:	EODS
CHECKED BY:	MHEL

**CITY OF LAKESIDE PARK**  
**2024 CONCRETE STREET**  
**SPOT REPAIRS**  
 LAKESIDE PARK, KENTUCKY

PROJECT NO.	
241172	
DISCIPLINE	
CIVIL	
SHEET NAME	
PLN6	
SHEET	OF
11	12

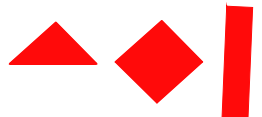
PLAN VIEW 6



- 
 PARTIAL DEPTH PAVEMENT JOINT REPAIR.  
 TO BE MARKED IN THE FIELD.  
 SEE SHEET DETAIL1
- 
 8" PROPOSED CONCRETE PAVEMENT REPLACEMENT  
 SEE SHEET DET1
- 
 6" CONCRETE DRIVEWAY REPLACEMENT  
 SEE SHEET DET2
- 
 CURB AND GUTTER REPLACEMENT  
 SEE SHEET DET1
- 
 VERTICAL CURB REPLACEMENT  
 SEE SHEET DET2

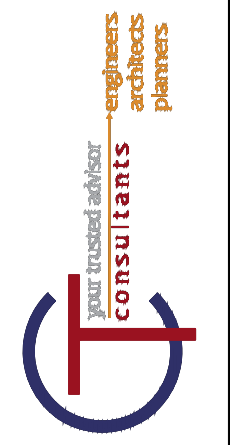

ISSUED FOR:	BID
ISSUE DATE:	03/14/2024
SCALE:	AS NOTED
DESIGNED BY:	MHEL
DRAWN BY:	EODS
CHECKED BY:	MHEL

**CITY OF LAKESIDE PARK  
2024 CONCRETE STREET  
SPOT REPAIRS**  
LAKESIDE PARK, KENTUCKY

**PLAN VIEW 7**

PROJECT NO.	
241172	
DISCIPLINE	
CIVIL	
SHEET NAME	
PLN7	
SHEET	OF
12	12

H:\2024\241172\DWG\BASE\241172\_PBASE.DWG - PLAN 7 - 2/20/2024 3:05:20 PM - EDWARD ODSON