

REVISIONS	BY

Barrington
CONSULTING GROUP, INC.
9114 TYLER BLVD., MENTOR, OHIO 44060
PHONE 440.205.1260 FAX 440.205.1262

MIDWEST MATERIALS
MELISSA EVENHIEMER
3691 SHEPARD ROAD
PERRY, OHIO 44081
PH: 440-259-5200 / FAX: 440-259-5204

PAVEMENT REPLACEMENT
MIDWEST MATERIALS STEEL SERVICE CENTER
PERRY, OHIO 44081

SITE PLAN - OPTION B

DATE	AUGUST 28, 2014
SCALE	H:1"=30', V:1"=5'
JOB NO.	14043
SHEET	

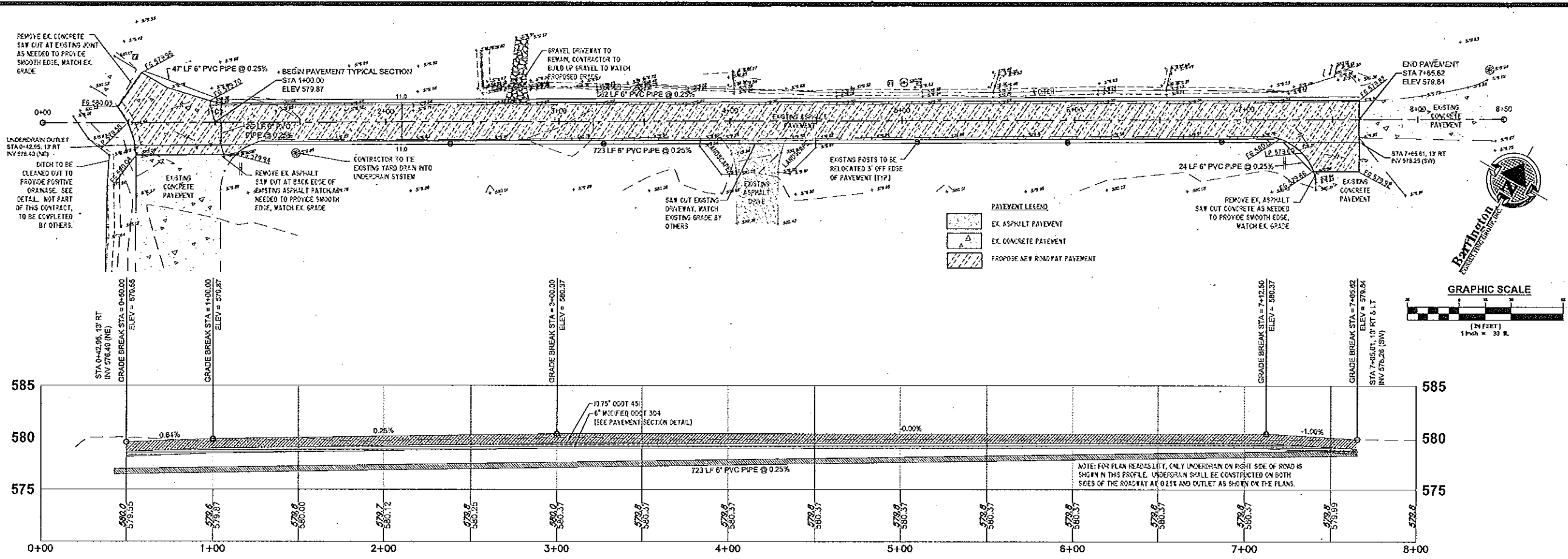

GENERAL

THE STANDARD SPECIFICATIONS OF THE OHIO DEPARTMENT OF TRANSPORTATION, LATEST EDITION, INCLUDING ALL SUPPLEMENTAL SPECIFICATIONS AND STANDARD DRAWINGS, SHALL GOVERN THIS PROJECT.

ALL WORK CONTEMPLATED UNDER THIS CONTRACT SHALL COMPLY WITH THE U.S. DEPARTMENT OF LABOR OCCUPATIONAL SAFETY AND HEALTH ACT.

STATIONING SHOWN HEREON IS ALONG THE CENTERLINE OF THE PROPOSED DRIVEWAY FOR PAVING WORK.

ALL EXISTING PROFILES SHOWN HEREON ARE FROM ACTUAL FIELD SURVEYS BY BARRINGTON CONSULTING GROUP, INC.

HAUL ROADS

ALL HAUL ROADS SHALL REMAIN IN GOOD DRIVING CONDITION. STREET CLEANING SHALL BE PERFORMED AS NECESSARY, AS DIRECTED BY THE OWNER. THE CONTRACTOR SHALL BE RESPONSIBLE FOR KEEPING ROADWAYS CLEAN OF ALL DEBRIS ASSOCIATED WITH THE IMPROVEMENTS.

TRAFFIC CONTROL

THE CONTRACTOR SHALL BE RESPONSIBLE FOR ALL CONSTRUCTION SIGNING, TRAFFIC MAINTENANCE AND TRAFFIC CONTROL AS DIRECTED BY THE OWNER. ALL WORK, SIGN LAYOUTS, AND MATERIALS USED SHALL CONFORM TO THE SPECIFICATIONS SET FORTH IN THE OHIO MANUAL OF UNIFORM TRAFFIC CONTROL DEVICES. ACCESS TO GREAT LAKES POWER SERVICE SHALL BE MAINTAINED AT ALL TIMES.

MATERIAL SPECIFICATIONS

MATERIAL SPECIFICATIONS CALLED FOR ON THE PLANS REPRESENT THE MAXIMUM REQUIRED FOR EACH APPLICATION. THE OWNER MAY REQUEST OR THE CONTRACTOR MAY DESIRE TO SUBSTITUTE ALTERNATE MATERIALS. ANY SUCH SUBSTITUTIONS MUST BE EQUIVALENT IN QUALITY TO THE MATERIAL CALLED FOR AND MUST BE APPROVED IN WRITING BY THE APPROVING AGENCIES AND THE CONSULTING ENGINEER.

MATERIAL TESTING AND PERMITS

THE CONTRACTOR SHALL BE RESPONSIBLE FOR THE COST OF ALL MATERIAL TESTING AND ALL PERMITS REQUIRED FOR THIS PROJECT.

SEEDING AND MULCHING

ALL SEEDING AND MULCHING SHALL BE PERFORMED IN ACCORDANCE WITH THE REQUIREMENTS OF ODOT ITEM 659.

SEEDING MIXTURE:

TYPE I - 3 LBS. / 1000 SQ. FT.
KENTUCKY BLUEGRASS 40%
CREEPING RED FESCUE 40%
PERENNIAL RYE 20%
FERTILIZER 12-2-2, 20#/1000 SF
MULCH 2 TONS PER ACRE

SEDIMENT CONTROL SHALL BE ACCOMPLISHED BY SEEDING AND MULCHING ALL DISTURBED AREAS IMMEDIATELY UPON COMPLETION OF EXCAVATION OR FILL, AND FINISHED GRADING IN ACCORDANCE WITH ITEM 659, OHIO DEPARTMENT OF TRANSPORTATION CONSTRUCTION AND MATERIAL SPECIFICATIONS AND/OR AS DIRECTED BY THE LAKE COUNTY SOIL AND WATER CONSERVATION DISTRICT.

RESTORATION OF ALL DISTURBED AREAS SHALL IMMEDIATELY FOLLOW EXCAVATION AND GRADING OPERATIONS. DELAY IN RESTORATION SHALL NECESSITATE TEMPORARY EROSION CONTROL MEASURES APPROVED BY THE LAKE COUNTY SOIL AND WATER CONSERVATION DISTRICT AND AT THE CONTRACTOR'S COST.

EARTHWORK OPERATIONS

EROSION CONTROL METHODS MUST BE IN PLACE PRIOR TO ANY EXCAVATION WORK COMMENCING.

THE FOLLOWING PROCEDURE HAS BEEN RECOMMENDED BY SUMMIT TESTING AND INSPECTION COMPANY FOLLOWING THE METHODOLOGY OF ODOT GEOTECHNICAL BULLETIN 6B FOR SUBGRADE PREPARATION FOR THE NEW PAVEMENT:

- REMOVE EXISTING ASPHALT AND CONCRETE PAVEMENT AND UNDERLYING AGGREGATE BASE. THE AGGREGATE BASE CAN BE STOCKPILED FOR REUSE IF IT CAN BE SEGREGATED WITHOUT BEING CONTAMINATED WITH THE UNDERLYING SOIL.
- PLACE PERFORATED UNDERDRAINS ON BOTH SIDES OF THE PAVEMENT AT OR JUST BELOW THE AGGREGATE BASE.
- PERFORM 10' UNDERCUT OF THE EXISTING SOIL.
- PLACE GEOTEXTILE SEPARATION FABRIC WITH MINIMUM 12 INCHES OVERLAP IN ALL DIRECTIONS.
- PLACE GEO-GRID OVER GEOTEXTILE SEPARATION FABRIC.
- PLACE 12" OF ODOT #1 & 2 LIVESTONE.
- PROOF-ROLL TEST THE RESULTING SUBGRADE; CORRECT AREAS THAT FAIL THE PROOF-ROLL PER THE RECOMMENDATIONS OF A QUALIFIED REPRESENTATIVE OF SUMMIT TESTING OR BARRINGTON CONSULTING GROUP THAT SHOULD WITNESS THE PROOF-ROLL.

THE FINAL GRADE OF THE EXCAVATED AND FILLED AREAS SHALL CORRESPOND TO THE PROPOSED GRADES SHOWN ON THE IMPROVEMENT PLANS.

THE CONTRACTOR SHALL BE RESPONSIBLE FOR HIRING THE SOILS CONSULTANT FOR ALL SOIL ANALYSIS AND TESTING REQUIRED AS OUTLINED ABOVE.

DRAINAGE OF ROADWAY AREA DURING CONSTRUCTION

THE CONTRACTOR SHALL BE REQUIRED DURING THE COURSE OF HIS WORK WITHIN AND ADJACENT TO THE PROPOSED PAVEMENT AREA TO MAINTAIN THE ROADWAY AREA IN SUCH CONDITION THAT IT WILL BE WELL DRAINED AT ALL TIMES. THE SURFACE OF THE PAVEMENT SUBGRADE AND THE GROUND SURFACE ABOVE THE FINAL PAVEMENT SUBGRADE PRIOR TO TRIMMING SHALL BE MAINTAINED IN A SMOOTH CONDITION TO PREVENT PONDING OF WATER AFTER RAINFALL. THE CONTRACTOR SHALL INSTALL PAVEMENT UNDERDRAINS PER TYPICAL SECTION PRIOR TO PLACEMENT OF PAVEMENT TO INSURE THE THOROUGH DRAINAGE OF THE SUBGRADE. THE CONTRACTOR SHALL BE RESPONSIBLE FOR ALL ADDITIONAL COSTS REQUIRED TO CORRECT POOR SUBGRADE CONDITIONS DUE TO HIS NEGLIGENCE IN PROPERLY MAINTAINING SUBGRADE DRAINAGE.

ROADWAY SUBGRADE

ROADWAY SUBGRADE AREAS WHICH BECOME UNSTABLE DUE TO THE CONTRACTOR'S NEGLIGENCE, SUCH AS LACK OF PROPER DRAINAGE OR POOR CONSTRUCTION PRACTICES, AND AREAS WHICH BECOME UNSTABLE DUE TO TRANSPORTATION OF MATERIALS OVER AND ALONG THE ROADWAY, SHALL BE PROPERLY REPLACED OR CORRECTED AT THE CONTRACTOR'S EXPENSE.

UTILITIES

IT IS THE OBLIGATION AND RESPONSIBILITY OF THE CONTRACTOR TO MAKE HIS OWN INVESTIGATIONS OF SURFACE AND SUBSURFACE CONDITIONS PRIOR TO SUBMITTING HIS PROPOSAL.

THE LOCATION OF ALL EXISTING UNDERGROUND UTILITY FACILITIES ARE SHOWN ON THE PLANS FROM DATA AVAILABLE AT THE TIME OF THE FIELD SURVEY IN ACCORDANCE WITH SECTION 153.64 OF THE OHIO REVISED CODE. THE CONTRACTOR SHALL BE RESPONSIBLE FOR NOTIFICATION OF THE EXISTING UTILITY OWNERS AND UTILITY PROTECTION SERVICE IN ACCORDANCE WITH SECTION 154.64 OF THE O.R.C. AND AS OUTLINED IN PROJECT SPECIFICATIONS.

